

# ASPECT

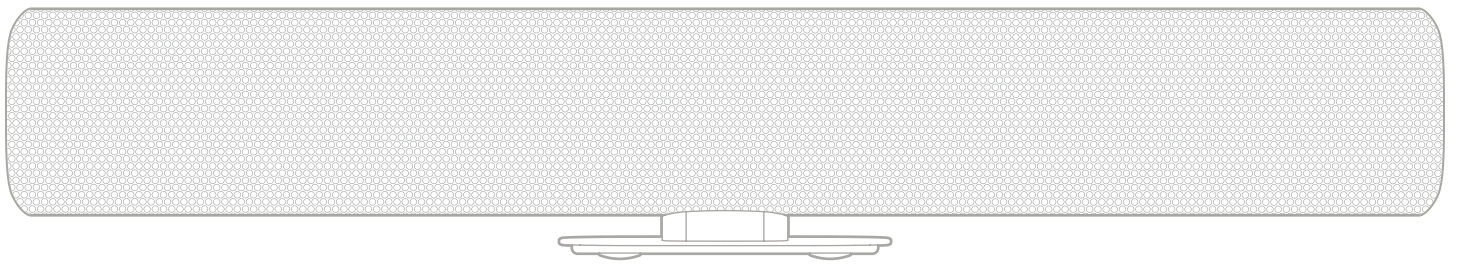

MODEL: ASPECT  
2.0 CHANNEL DUAL ORIENTATION SPEAKER SOUNDBAR

## USER MANUAL



**Goodmans**

# 1 Welcome



## 2 Your Sound System

- 2.1 In The Box
- 2.2 Side View
- 2.3 Rear View

## 3 Operation

- 3.1 LED indicator
- 3.2 Remote control

## 4 Quick Setup

- 4.1 Connect Aspect to your TV
- 4.2 Power on Aspect
- 4.3 Choose the source type
- 4.4 Mute your TV output

## 5 Features

### **HORIZONTAL/VERTICAL SOUND MODES**

- 4.1 Switch between horizontal and vertical modes

### **BLUETOOTH CONNECTIVITY**

- 4.2 Set the source type to bluetooth
- 4.3 Connect to your bluetooth enabled device

### **AUX IN MODE**

- 4.4 Connect to an external audio device
- 4.5 Set the source type to Aux in

## 6 Troubleshooting

## 7 Technical Specifications

## 8 Customer Support

# 1 Welcome



Thank you for choosing a Goodmans product. We've been making electronics for the British people for over 70 years. Each of our products has been carefully designed to be great at what it does and this one is no exception. We hope you enjoy your new Aspect Soundbar.

---

## 2 Your Soundbar

### 2.1 In The Box

Carefully remove your Aspect from the box.

Inside the box you will find:

- Aspect Soundbar
- DC power adapter
- Analogue stereo audio cable
- Remote control
- 1.5V AAA batteries x 2
- Quick Start Guide
- Guarantee Booklet

If any of these items are missing contact customer support.  
Visit: [www.goodmans.co.uk/support](http://www.goodmans.co.uk/support).



### Mains Power

Your Aspect Soundbar requires a mains supply of 90-265V 50~60Hz. Please ensure that your mains supply is compatible before use.



## 2.3 Side View

- A + button**  
Press to increase the volume.
- B ⏻ button**  
Press to turn Aspect on/off.
- C — button**  
Press to decrease the volume.
- D Source button/LED indicator**  
Press to change the input source.  
The indicator shows the status or source type by different colours.

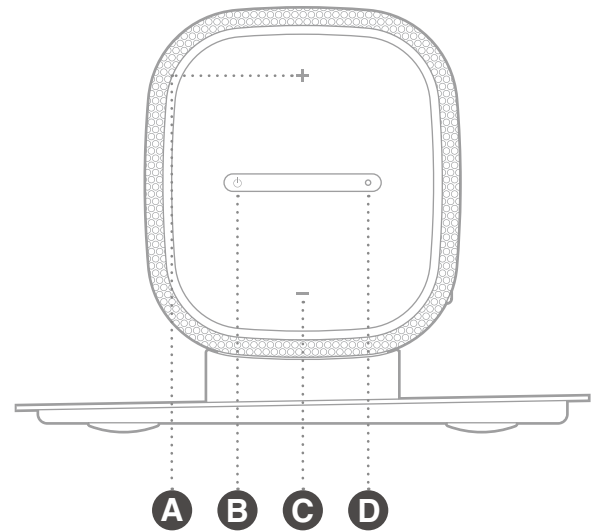

## 2.3 Rear View

- E DC power input**  
Used to connect Aspect to the mains power supply.
- F Optical digital input**  
Connect to television's optical digital output.
- G Coaxial digital input**  
Connect to television's coaxial digital output.
- H Aux stereo input**  
Connect external audio sources with a 3.5mm audio cable.
- I RCA stereo input (Line input)**  
Connect to your television's analogue stereo output.

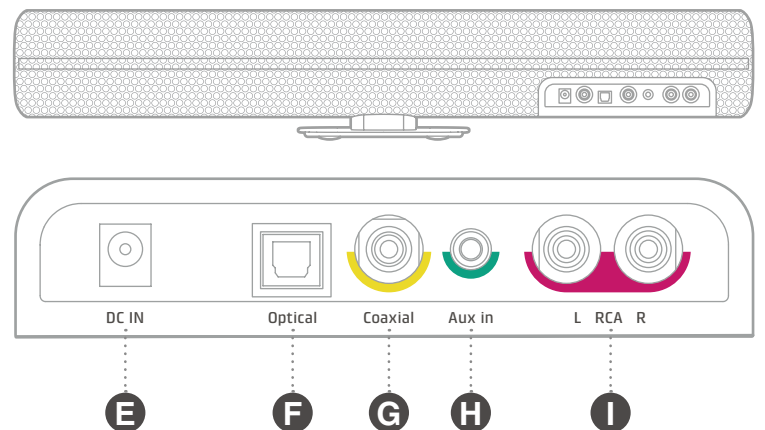

## 3 Operation



### 3.1 LED Indicator

The LED indicator on the side of Aspect helps you to identify the status and source mode.

**Red:** power off

**White:** optical input

**Yellow:** coaxial input

**Green:** aux input

**Magenta:** line input

**Blue:** bluetooth input

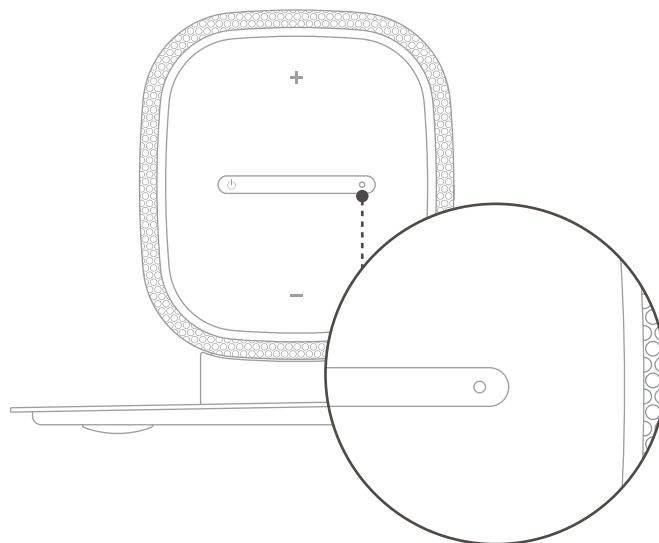

### 3.2 Remote Control

#### A Mute

Short press: mute or unmute the sound.  
Long press: reset to default sound setting.

#### B

Turn on or turn off Aspect.

#### C

Press and hold to switch the sound between horizontal and vertical modes.

#### D Line in (RCA)

Select the line input.

#### E Aux in

Select the aux input.

#### F Bluetooth

Select the bluetooth input.

#### G Optical

Select the optical input.

#### H Coaxial

Select the coaxial input.

#### I

Raise or lower the volume.

#### J Bass

Raise or lower the Aspect effect. Long press of mute to return to default setting.

#### K Treble

Raise or lower the Treble effect. Long press of mute to return to default setting.

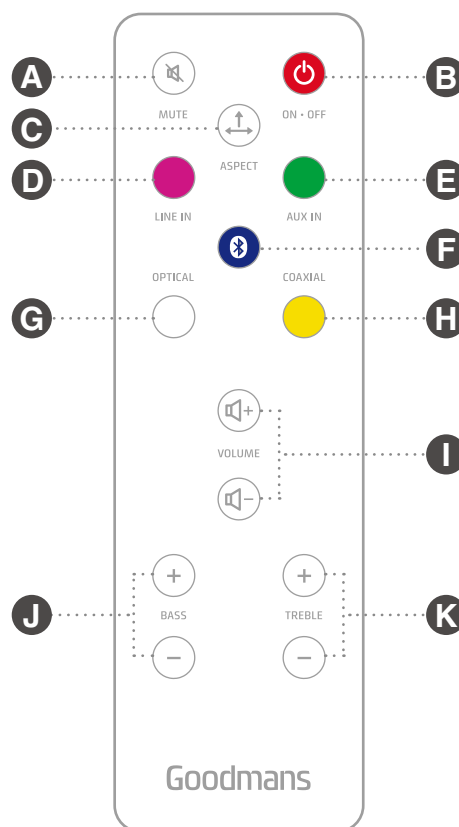

# 4 Quick Setup



## 4.1 Connect Aspect to your TV

Aspect offers four types of audio connectivity for you to choose. Only one source type is needed for connection.

1. Plug an audio cable into an available connection on your TV.
2. Plug the other end of the chosen cable to the corresponding audio input connector of Aspect.

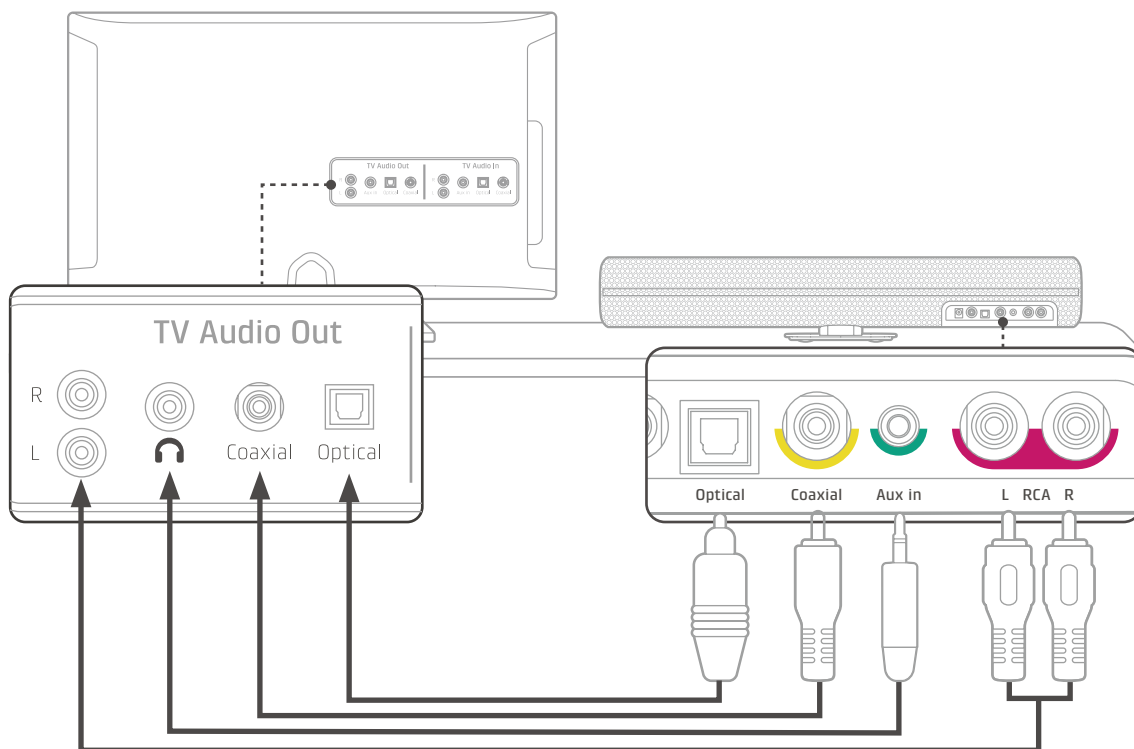

## 4.2 Power on Aspect

1. Locate Aspect on its base.
2. Connect one end of the provided power cord to the AC in power input. Plug the other end into the power socket.
3. Press  to turn on.

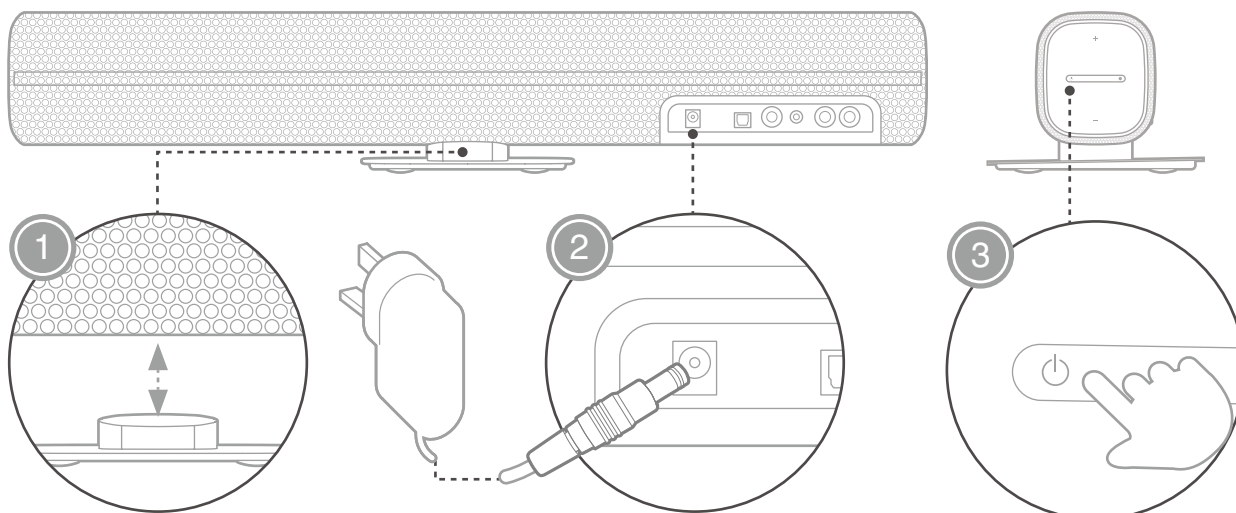



### 4.3 Choose the source type

Aspect offers four types of audio connectivity for you to choose. Only one source type is needed for connection.

1. Use the remote control, or press the LED on the side of Aspect to change the source type.
2. Identify the source mode using the LED indicator.

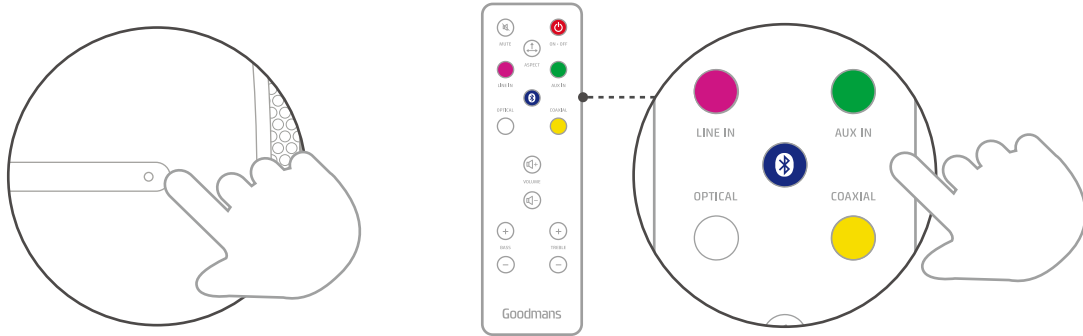

### 4.4 Mute your TV output

Please refer to your TV owner's guide for help turning off the internal speakers of your TV.

1. Turn on your TV.
2. Go to the TV setting menu and select the audio, sound, or speaker settings.
3. Look for the menu item that allows you to turn off the TV speakers.
4. If there is no option for turning the TV speakers off, decrease the TV volume to the lowest.

## 5 Features



### HORIZONTAL/VERTICAL SOUND MODES

#### 5.1 Switch between horizontal and vertical modes

You can listen to Aspect vertically, as well as horizontally.

1. Remove the end panel and store it in the base of the stand.
2. Rotate and stand Aspect on its base.
3. Press on the remote to switch the sound between horizontal and vertical modes. The LED will flash blue 3 times when in vertical mode and flash red 3 times when in horizontal mode.

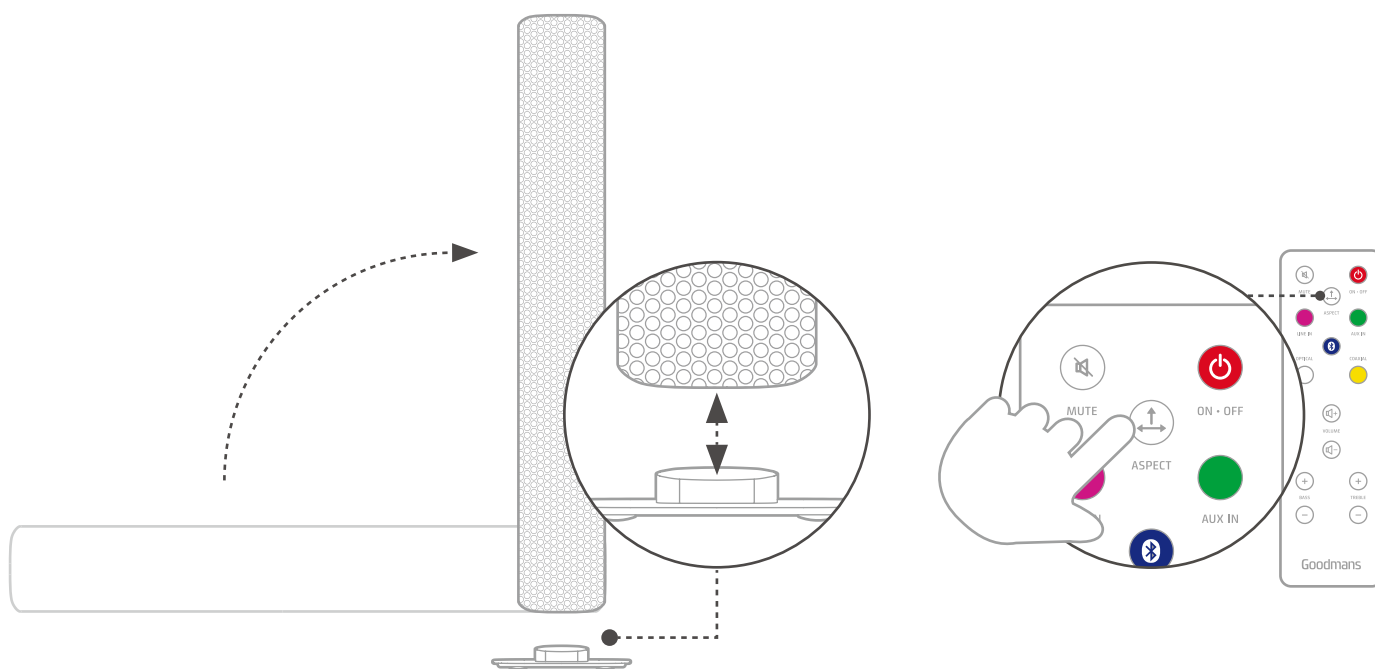

### BLUETOOTH CONNECTIVITY

#### 5.2 Set the source type to bluetooth

Use the remote control, or press the source button on the right hand of Aspect, to set bluetooth mode. The LED indicator will show blue.

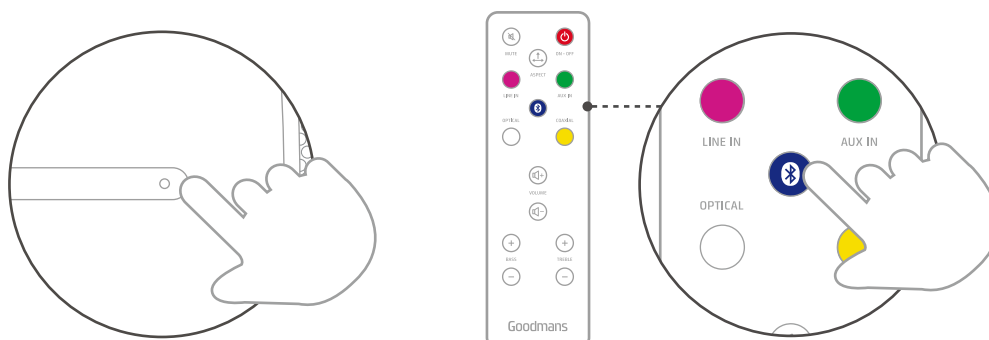





### 5.3 Connect to your bluetooth enabled device

1. Go to the bluetooth setting on your smartphone, tablet, computer or other devices.
2. Search and select 'Aspect' to connect. If your phone is NFC compatible, touch the NFC zone, the middle on the front of Aspect, with your phone to pair.
3. Enter '0000' if the device asks for a passcode.



This Bluetooth feature is to stream your music collection from your Bluetooth enabled smart phone or tablet. It cannot be used to connect to a Smart TV.

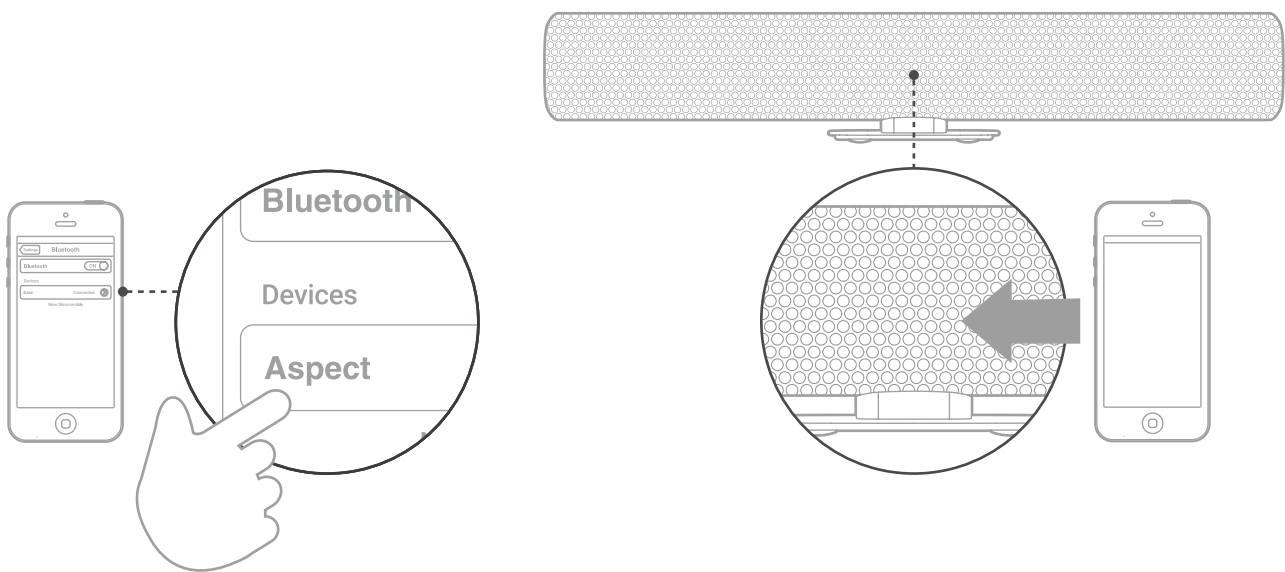

### AUX IN MODE

#### 5.4 Connect to an external audio device

Connect one end of the 3.5mm audio cable to the external audio devices headphone output and the other end to the Aux input of Aspect.

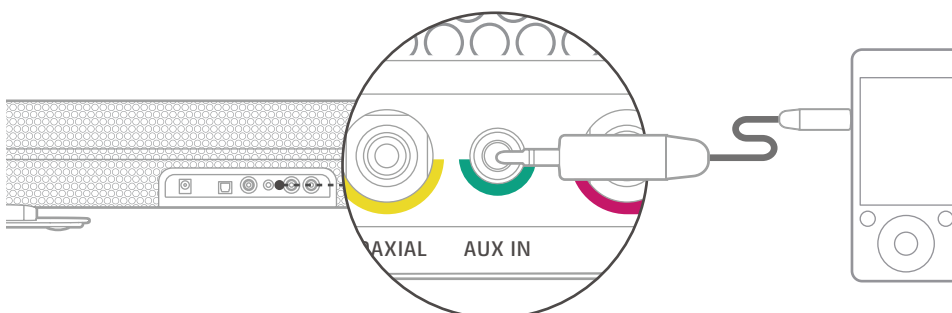



## 5.5 Set the source type to Aux in

1. Use the remote control, or press the source button on the right hand of Aspect, to set Aux in mode. The LED indicator will show green.
2. Press play on the external device to begin playback through Aspect.



The volume output is effected by the volume level on the audio source EG: Phone or laptop, so make sure that is set to about 70-80% (not too loud to avoid distortion).

Adjust the volume on the unit to the required listening level.

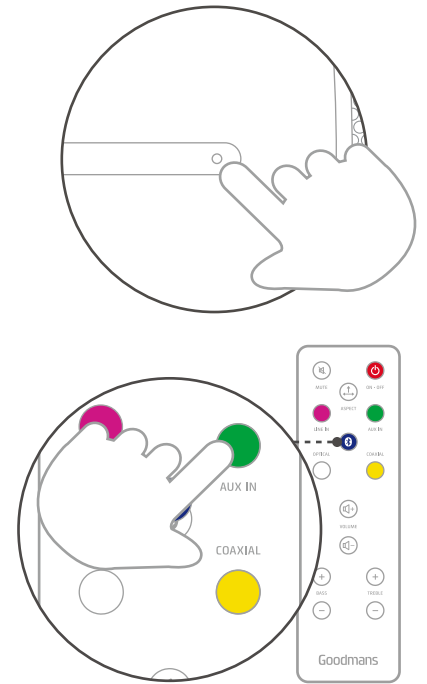

## 6 Troubleshooting



Problem	What to do
There is no sound from my Aspect	<ol style="list-style-type: none"><li>1. Make sure Aspect is powered on.</li><li>2. Check the volume control of Aspect is not at a minimum.</li><li>3. Check Aspect is not set to mute.</li><li>4. Make sure Aspect is set to the correct source that corresponds to the connected input source.</li><li>5. If you are using a digital audio connection, make sure the corresponding TV's digital audio output is enabled. If the digital audio connection is not working, try to use an analogue stereo audio connection.</li></ol>
Sound comes from TV	Disable or mute your TV's internal speakers, check your TV manual.
Distorted sound	Make sure the cable connections on Aspect and TV are secure.
The Remote Control does not work	<ol style="list-style-type: none"><li>1. Replace the batteries (2x AAA).</li><li>2. Make sure the batteries are installed properly.</li><li>3. Make sure there are no obstacles obscuring Aspect.</li></ol>
Problems with Bluetooth	<ol style="list-style-type: none"><li>1. Make sure Aspect is set to the Bluetooth pairing mode. The LED should light blue.</li><li>2. Ensure your Bluetooth device is enabled. Try connecting with a different Bluetooth device.</li><li>3. Move your Bluetooth device closer (within 33 ft/10m) to Aspect and retry the pairing procedure.</li><li>4. Check Aspect is not paired with other devices. Try unpairing other devices then try the pairing procedure again.</li></ol>

## 7 Technical Specification



Model Number	ASPECT
Power Supply	90-265V 50~60Hz
Speaker Output Power	15W x 2
Frequency Range	130Hz-15KHz
Max Power Consumption	65W
Dimensions	600mm (W) x 320mm (D) x 100mm (H)

## 8 Customer Support

Our customer service team is available for technical or guarantee support, [www.goodmans.co.uk/support](http://www.goodmans.co.uk/support).