

# SOUNDBAR

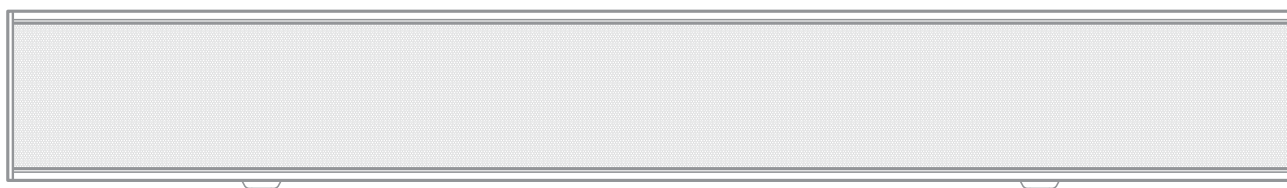

MODEL: GDSB02BT45  
2.0 BLUETOOTH SOUNDBAR

USER MANUAL



Goodmans

# 1 Welcome



## 2 Your Soundbar

2.1 In The Box

2.2 Front View

2.3 Side View

2.4 Rear view

2.5 Remote Control

## 3 Quick Setup

3.1 Power On/Off and mode Selection

3.2 Standby & Auto Standby

3.3 Fitting the remote control battery

3.4 Adjusting the Volume

3.5 Adjusting the EQ sound effects

3.6 Muting the sound

## 4 Operation

### **Bluetooth Operation**

4.1 Pairing a device

4.2 Operating a connected device

### **Aux Operation**

4.3 Aux in mode

### **Line In Operation**

4.4 Line in mode

## 5 Troubleshooting

## 6 Technical Specifications

## 7 Customer Support

# 1 Welcome



Thank you for choosing this Goodmans product. We've been making electronics for the British people for 70 years. Each of our projects has been carefully designed to be great at what it does and this one is no exception. We hope you enjoy your new Soundbar.

---

## 2 Your Soundbar

### 2.1 In The Box

Carefully remove your Soundbar from the packaging.

Inside the box you will find:

- Soundbar
- Mains Power adapter
- 3.5mm to RCA audio cable
- 3.5mm audio cable
- Quick Start Guide
- Guarantee Booklet

If any of these items are missing, contact customer support.

Visit: [www.goodmans.co.uk/support](http://www.goodmans.co.uk/support)



### Mains Power

Your Soundbar requires a mains supply of 230-240V AC ~ 50Hz. Please ensure that your mains supply is compatible before use. Disconnect the Power Cord from the mains when not in use.

### Position of Soundbar

Place on a flat, stable surface that is not subject to vibrations. Avoid the following locations:

- Where it is exposed to direct sunlight
- Where it is close to heat radiating sources
- Where the humidity is high and ventilation is poor
- Where it is dusty



## 2.2 Front View



- A** Speakers
- B** Mode indicators  
Each coloured LED indicates a mode:  
GREEN - Line In, BLUE - Bluetooth,  
WHITE - AUX in & RED - STANDBY  
ORANGE - EQ active

## 2.3 Side View

- C** STANDBY button. Press & hold to wake or enter STANDBY mode.
- D** MODE button. Press to cycle between the different input modes: Line in, Bluetooth & Aux in.
- E** VOLUME+ button. Press to increase the volume output.
- F** VOLUME- button. Press to decrease the volume output.
- G** PAIR button. Press to begin the pairing operation in Bluetooth mode.
- H** LINE IN socket. Connect a 3.5mm audio cable (supplied) to use the Line in mode.

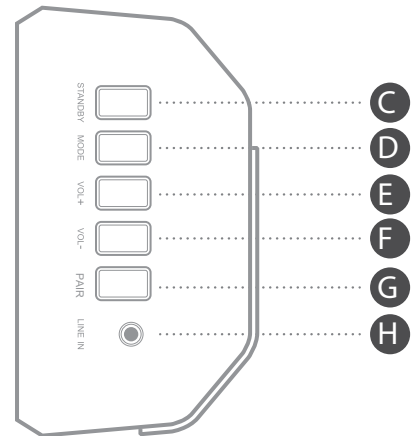

## 2.4 Rear View

- I** RCA AUX input. Connect an RCA cable (supplied) to use the AUX in mode.
- J** DC POWER input socket. Connect the 18V mains plug to this socket to power the Soundbar.

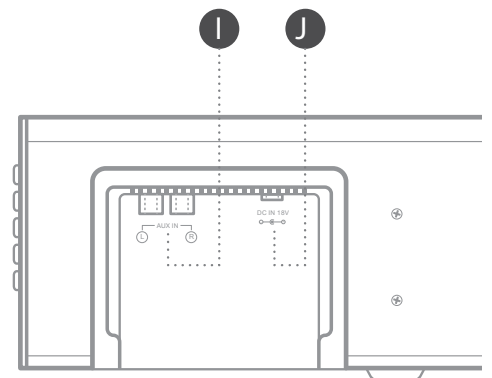



## 2.5 Remote Control

- K STANDBY button.** Press to wake or press & hold to enter STANDBY mode.
- L PAIR button.** Press to begin the pairing operation in Bluetooth mode.
- M FLAT.** Press this button to restore any sound EQ preset to the default flat mode.
- N ■ button.** Press to stop playback of a paired Bluetooth device.
- O ◀◀ button.** Press to skip to the previous track of a paired Bluetooth device.
- P VOLUME- button.** Press to decrease the volume output.
- Q MUTE.** Press to silence playback of a paired Bluetooth device.
- R MODE button.** Press to cycle between the different input modes: Line in, Bluetooth & Aux in.
- S EQ.** Press repeatedly to cycle between the following sound modes: Rock, Pop, Jazz, Live, Classic & News
- T ▶/|| button.** Press to Play or Pause playback of a paired Bluetooth device.
- U ▶▶ button.** Press to skip to the next track of a paired Bluetooth device.
- V VOLUME+ button.** Press to increase the volume output.

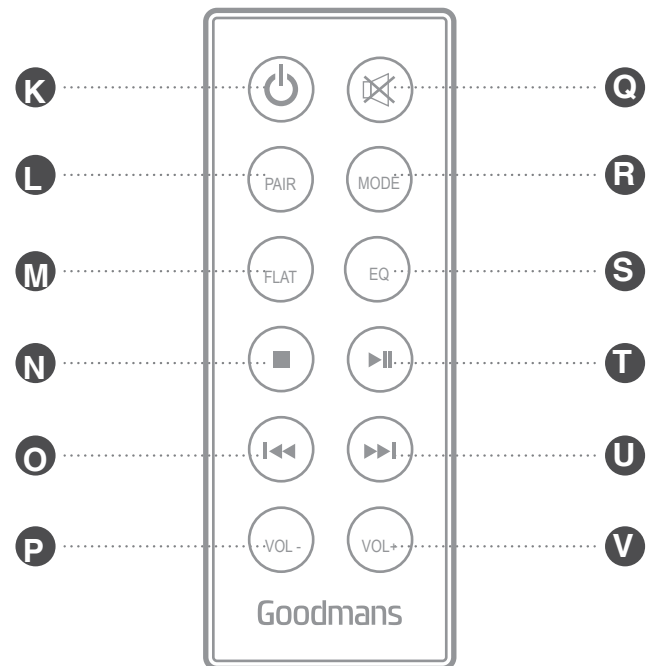

## 3 Quick Setup



### 3.1 Power On/Off and mode Selection

1. This Soundbar is supplied with a mains power adapter.  
To connect the power insert the mains adapter plug in the rear of the unit (J).
2. Insert the UK plug into a household power socket, and switch the power on.
3. Press and hold the STANDBY button on the side of the Soundbar (C).
4. Press the MODE button on the side of the soundbar (D) or on the remote control (R) to cycle between input modes.

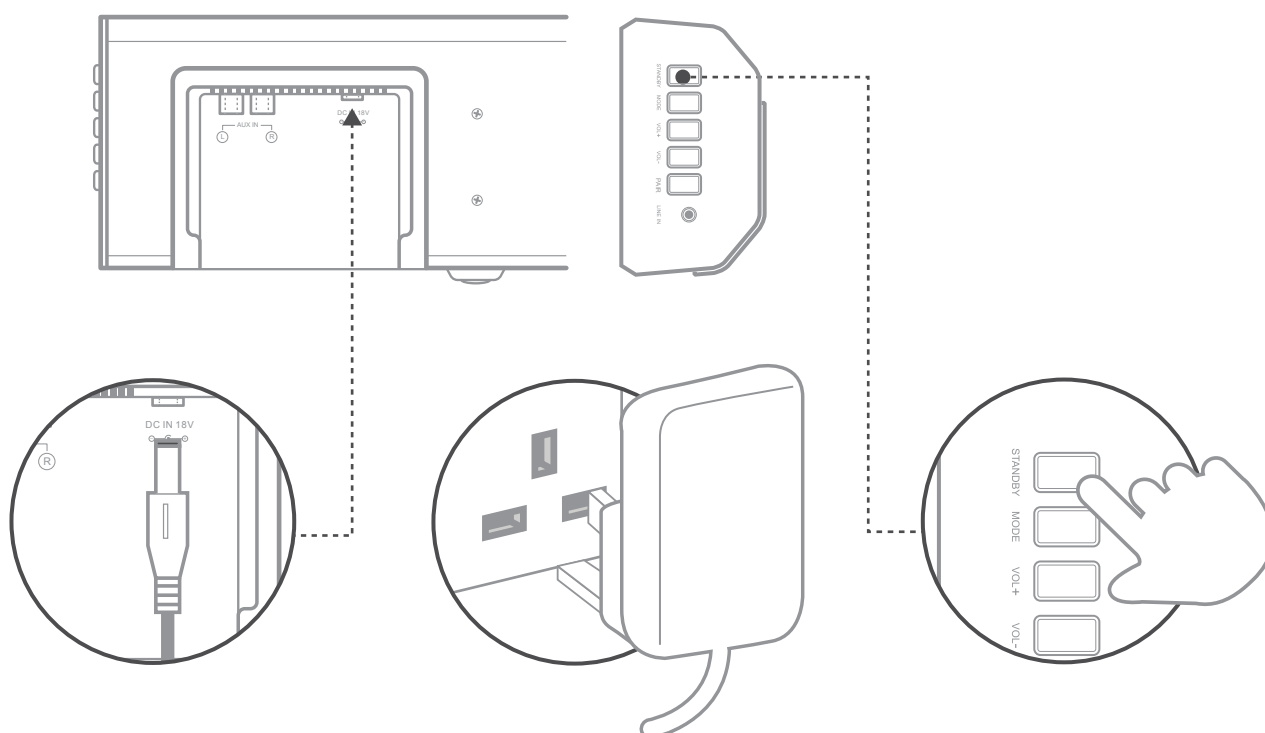

### 3.2 Standby & Auto Standby

1. Press and hold the STANDBY button (C) on the side of the soundbar or press the STANDBY button on the remote (K) to wake from Standby mode.
2. Press and hold the STANDBY button (C) on the side of the soundbar or press & hold the STANDBY button on the remote (K) to enter Standby mode.



Due to new ECO regulation requirements this product incorporates a power saving feature.

3. When in Bluetooth, Aux or Line in mode, once audio playback has ceased and the unit has stood idle for approximately 20 minutes, it will switch into a 'power-down' power saving mode.
4. To wake the unit up, press the STANDBY button (C or K).

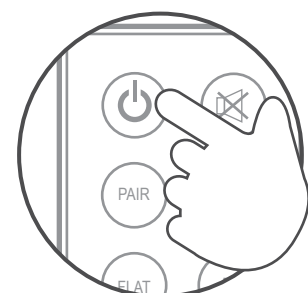
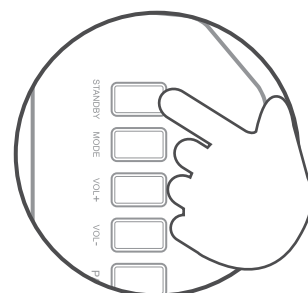



### 3.3 Fitting the remote control battery

1. Lay the remote flat on a stable surface with the back facing upwards.
2. Press the tab on the bottom left inwards and use a fingernail to slide the compartment outwards to reveal the internal battery.
3. Insert one CR2025 battery taking care that the surface marked with a '+' symbol is facing upwards.
4. Slide the battery compartment back inside the remote control.

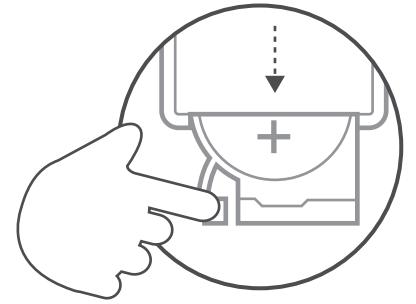

Leaking batteries may damage the remote control. If you are not going to use the Soundbar for an extended period, please remove the batteries to avoid damage.

Caution: Danger of explosion if battery is incorrectly replaced. Replace only with the same or equivalent type.

### 3.3 Adjusting the Volume

1. Press either the VOLUME+ button (E) on the side of the Soundbar or on the remote control (V) to increase the volume output
2. Press either the VOLUME- button (F) on the side of the Soundbar or on the remote control (P) to decrease the volume output
3. Both volume buttons can be pressed & held to speed up the volume operation.

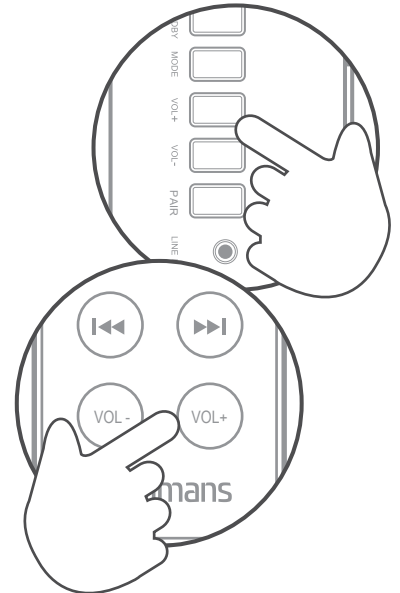

When you reach the top end of the volume output you will hear a beep sound.

### Adjusting the EQ sound effects

1. Press the EQ button on the remote control (S) repeatedly to cycle between the EQ modes of : Rock, Pop, Jazz, Live, Classic & News. The orange LED will illuminate to indicate the EQ mode is active.
2. To revert back to the default sound mode (flat), press the FLAT button on the remote control (M). The orange LED will go off to indicate the EQ mode is inactive.



### Muting the sound

1. Press the MUTE button on the remote control (Q) during playback to mute the output.
2. Press the MUTE button again to resume the audio output.

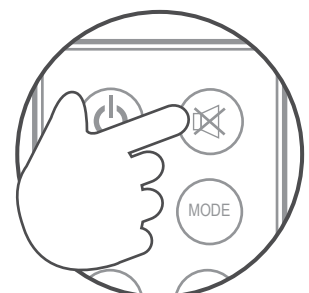

# 4 Operation



## Bluetooth Operation

### 4.1 Pairing a device

1. Wake the unit from STANDBY mode if not powered on already.
2. If the unit is already powered on and in a mode other than bluetooth, press the MODE button on the side (D) or on the remote control (R) repeatedly until the LED mode indicator turns blue.
3. When entering Bluetooth mode the blue LED will flash to indicate the Soundbar is in pairing mode, with no device connected.
4. Enable Bluetooth on your audio device and search for available bluetooth connections. Select the GDSB02BT45 from the list. If you are asked for a pass code enter '0000'.



If you turn off either device before pairing is complete the process will need to be repeated when powered on again. If you do not see 'GDSB02BT45' press the PAIR button (G or L) to re-initiate pairing mode.

5. Once paired the blue LED will stop flashing.



Each time you switch the Soundbar on and select Bluetooth mode the device will automatically connect, unless you have un-paired the device.

6. You can now begin playback from the audio device and the output will playback through the Soundbar.
7. Should you wish to un-pair a connected device and connect another, press the PAIR button on the side (G) or on the remote control (L).



The volume output is effected by the volume level on the audio source EG: Phone or laptop, so make sure that is set to about 70-80% (not too loud to avoid distortion).

8. Adjust the VOLUME on the unit to the required listening level.

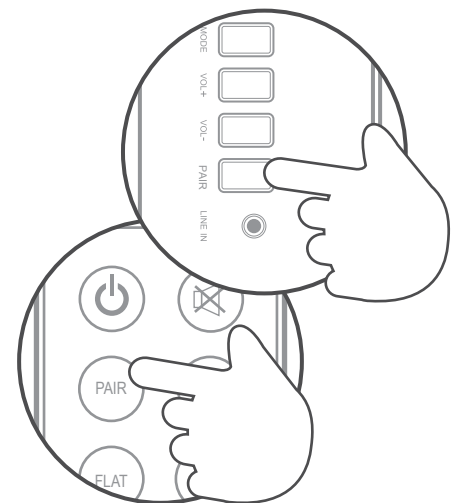
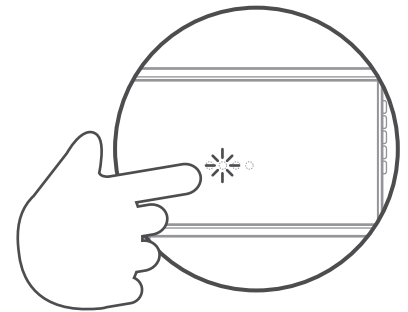
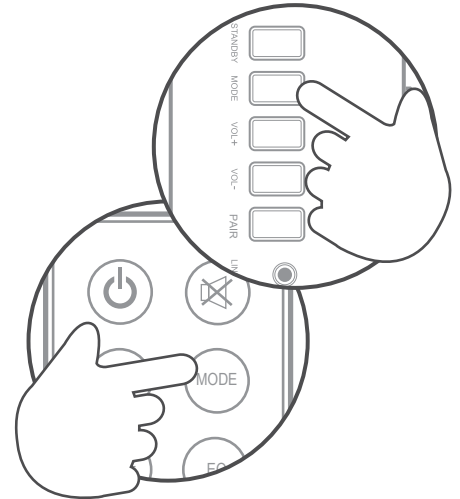





## Bluetooth Operation

### 4.2 Operating a connected device

Once paired you can control some playback functions from the remote control.

- **■ button.** Press to stop playback of a paired Bluetooth device.
- **▶/|| button.** Press to Play or Pause playback of a paired Bluetooth device.
- **◀◀ button.** Press to skip to the previous track of a paired Bluetooth device.
- **▶▶ button.** Press to skip to the next track of a paired Bluetooth device.

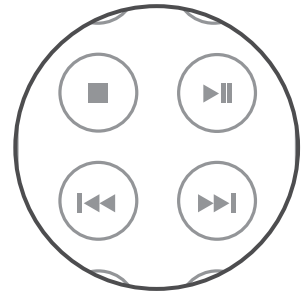

## Aux Operation

### 4.3 Aux in mode

Follow the below steps to connect an external audio device using the supplied 3.5mm to RCA audio cable.

1. Connect the 3.5mm jack end of the cable to the external audio devices headphone output and the red & white RCA jacks to the RCA AUX input (I) on the rear of the Soundbar.



Take care to match the red jack to the red plug and the white jack to the white plug.

2. Press the MODE button on the side (D) or on the remote control (R) repeatedly until the LED mode indicator turns white.
3. Press play on the external device to begin playback through the Soundbar speakers.



The volume output is effected by the volume level on the audio source EG: Phone or laptop, so make sure that is set to about 70-80% (not too loud to avoid distortion).

4. Adjust the VOLUME on the unit to the required listening level.

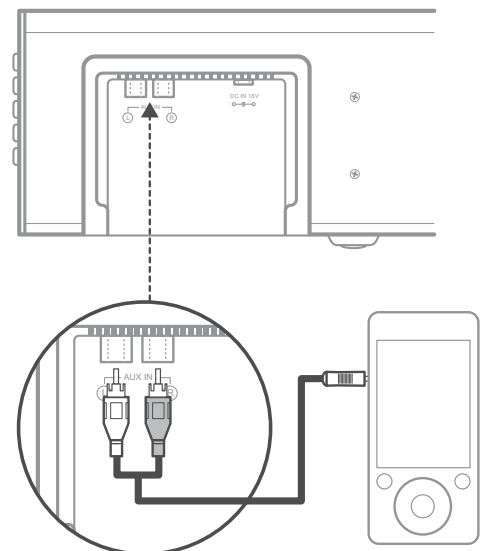



## Line In Operation

### 4.4 Line in mode

Follow the below steps to connect an external audio device using the supplied 3.5mm to 3.5mm audio cable.

1. Connect one end of the 3.5mm audio cable to the external audio devices headphone output and the other end to the Line In input (H) on the side of the Soundbar.
2. Press the MODE button on the side (D) or on the remote control (R) repeatedly until the LED mode indicator turns green.
3. Press play on the external device to begin playback through the Soundbar speakers.



The volume output is effected by the volume level on the audio source EG: Phone or laptop, so make sure that is set to about 70-80% (not too loud to avoid distortion).

Adjust the VOLUME on the unit to the required listening level.

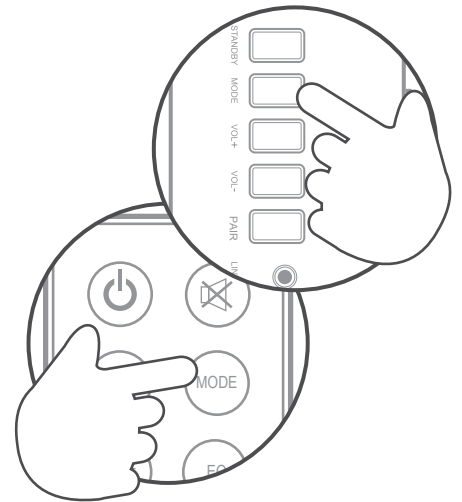
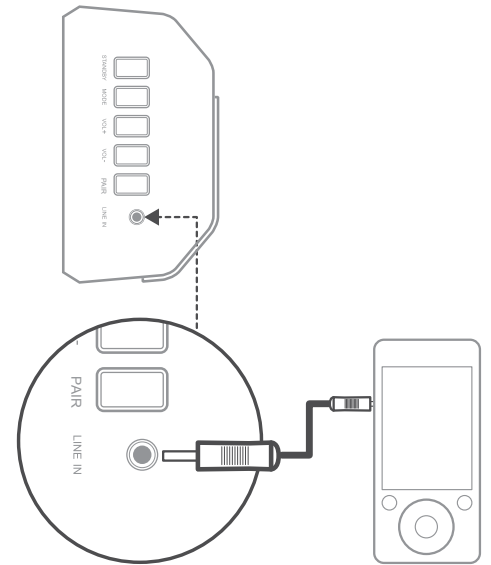

## 5 Troubleshooting



Problem	What to do
No Power	<p>Check the mains plug is connected to the wall socket. Switch the wall socket ON.</p> <p>Press the STANDBY button (C or K) to wake from Standby mode.</p>
No sound from the Bluetooth input	<p>Check the external device is paired correctly.</p> <p>The external audio source volume is too low, increase the volume level.</p>
No sound from an AUX/LINE IN input	<p>The volume level is too low. Increase using the volume control.</p> <p>The external audio source volume is too low, increase the volume level.</p>
The sound is distorted	<p>Reduce the soundbar volume level using the volume control.</p> <p>The external audio source volume is too high, decrease the volume level.</p>
Remote control does not work	<p>Reduce the distance between the remote and main unit</p> <p>Check the battery is installed correctly.</p> <p>Replace the battery</p> <p>Aim the remote directly at the Sound bar</p>

Model Number	GDSB02BT45
Power Supply	AC 230-240V ~ 50 Hz DC CR2025
Speaker Output Power	22.5W x 2 (RMS)
Speaker Impedance	4 Ohms
Frequency Response	90~20000Hz
S/N Ratio	80dB
Max Power Consumption	36W
Dimensions	760mm (L) x 55mm (W) x 110mm (H)

7

Customer Support

Our customer service team is available for technical or guarantee support. Visit [www.goodmans.co.uk/support](http://www.goodmans.co.uk/support)