

GSCOUT GPS



MODEL: GSCOUT GPS
IN-CAR CAMERA

USER MANUAL



Goodmans

1 Welcome



2 Your GSCOUT GPS

- 2.1 In The Box
 - 2.2 Bottom View
 - 2.3 Top View
 - 2.4 Rear View
 - 2.5 Front View
-

3 Setting

- 3.1 Movie Mode
 - 3.2 General Settings
-

4 Features

Basic Function

- 4.1 Normal Driving Mode
 - 4.2 Parking Mode
 - 4.3 GPS Function
 - 4.4 Video Recording Mode
 - 4.5 Photo Mode
 - 4.6 File Playback Mode
 - 4.7 LDWS
-

5 Troubleshooting

6 Technical Specifications

7 Customer Support

1 Welcome



Thank you for choosing this Goodmans product. We've been making electronics for the British people for 70 years. Each of our projects has been carefully designed to be great at what it does and this one is no exception. We hope you enjoy your new GSCOUT GPS in-car Camera.

2 Your GSCOUT GPS in-car camera

2.1 In The Box

Inside the box you will find:

- GSCOUT GPS main unit
- Car suction mount with GPS antenna
- Car Charger
- USB Cable
- Quick Start Guide
- Guarantee Booklet

If any of these items are missing contact Customer Support at www.goodmans.co.uk/support

Power Supply

Your GSCOUT GPS in-car camera is equipped with a 12V input car charger with 5V output. Please always use the provided car charger in the box.

Installing GSCOUT GPS in-car camera:

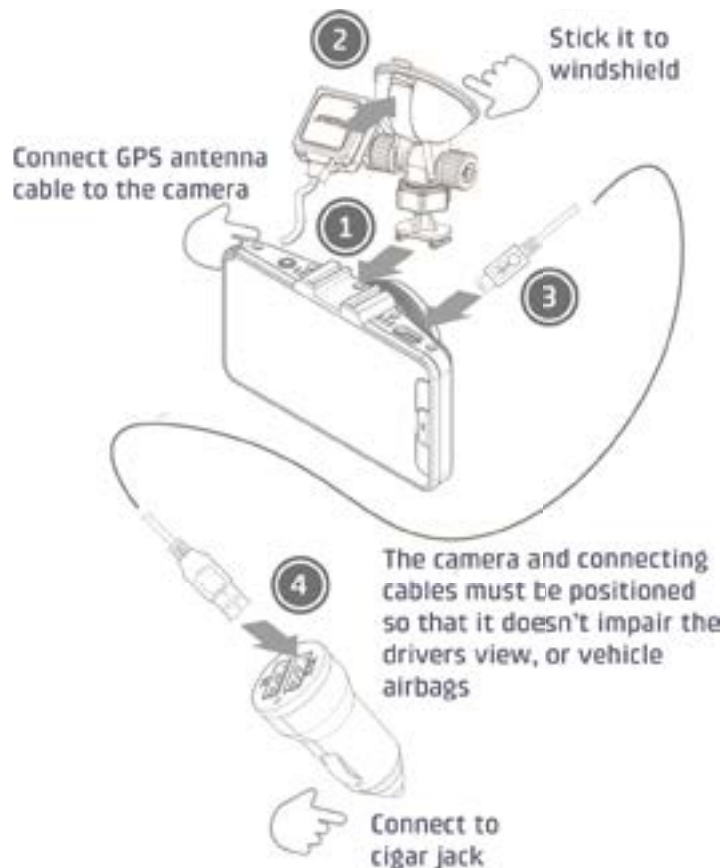

2.2 Bottom View

- A** MODE button
- B** MENU button
- C** HDMI out
- D** ON/OFF button
- E** RESET button

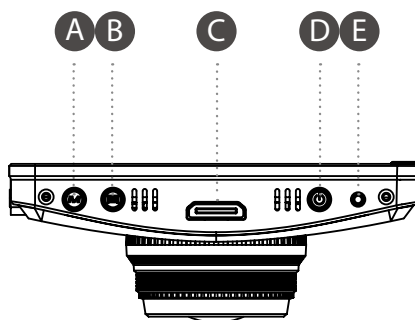

2.3 Top View

- F** GPS antenna input
- G** USB / POWER input

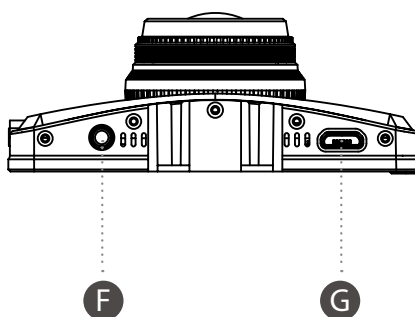

2.4 Rear View

- H** AV-out
- I** SD CARD slot
- J** Microphone

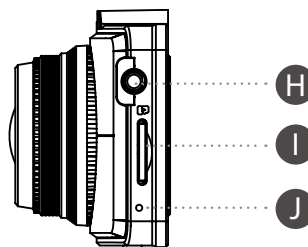

2.5 Front View

- K** POWER LED indicator
- L** UP button
- M** OK button
- N** DOWN button

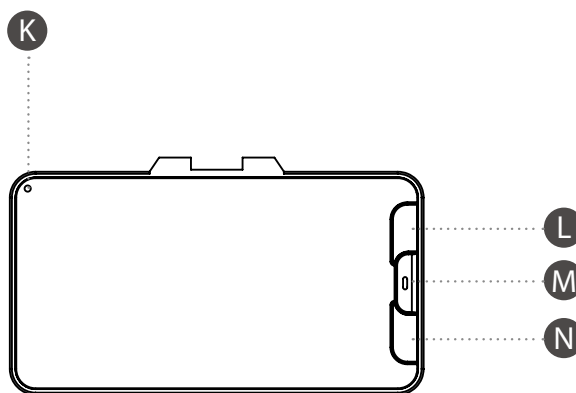

3 Settings



3.1 Movie Mode

MAIN MENU		SUB MENU	DESCRIPTION
	Movie Mode	FHD 30P HD 30P HD 60P VGA 30P	Set the Video resolution
	Movie Quality	SHQ HQ	Set the video quality
	Movie Clip Time	Off / 1 / 3 / 5 / 10 mins	Recording cycle duration
	Movie Off Time	0s / 5s / 30s / 1m / 2m / 3m	Set timeout
	Sound Record	On / Off	Set voice recording
	MIC Sensitivity	High / Low	Set microphone sensitivity
	Scene	P / Motion / Still / Landscape / Night / Snow / Indoor / Outdoor	Set Motion Detection
	Exposure	-2 / -1.66 / -1.33 / -1 / -0.66 / - 0.33 / 0 / +0.33 / +.066 / +1 / +1.33 / +1.66 / +2EV	Set exposure value
	White Balance	Auto / Daylight / Cloudy / Fluorescent 1 / 2 / 3 / Tungsten	Set white balance mode
	ISO Sensitivity	Auto / 100 / 200 / 400	Set ISO Sensitivity
	Colour	Sharp / Normal / Soft	Set colour balance
	Effect	Special effects on selection	Set special effects
	LDWS Detection	On / Off	Set Lane Departure Warning System
	Parking Mode	Auto / User	Select parking mode



3.2 General Settings

MAIN MENU		SUB MENU		DESCRIPTION
	Beep	On / Off		Set Beep sound
	Power Off	Off / 1 / 5 mins		Set power off timeout after no operation
	Clock Settings	Year Month Day Hour Minute Second		Set the clock
	Date Format	Off / YYYY MM DD / MM DD YYYY / DD MM YYYY		Set date display format
	TV System	NTSC / PAL		Set TV system
	HDMI Output	1080i / 720p		Set HDMI output
	Flicker	50Hz / 60Hz		Set flicker frequency
	USB Function	MSDC / PCAM		Set USB mode
	LCD Rotate	On / Off		Set display rotation to 180 degrees
	LCD Power Save	Off / 1 / 3 mins		Set LCD backlight timer
	Protect Level	Off / High / Med / Low		Set G-sensor sensitivity for file protection
	GPS Status			See GPS status
	MPH	MPH / KPH		Set speed unit
	Time Zone Select			Set time zone
	Reset Setup	Yes / No		Factory reset
	Format SD Card	Yes / No		Format MicroSD Card
	SD Card Info			MicroSD card information
	FW Version			Firmware version

4 Features



Basic function

4.1 Normal Driving Mode

1. Connect car charger to the camera.
2. When the car is on, the camera will be turned on and start recording automatically.
3. When the car is off, the camera will be turned off automatically.
4. You can press the ON/OFF button manually to turn on or off the camera.
5. The Power Indicator LED will be red when the camera is on.
The Power Indicator LED will be green when it is charging.

4.2 Parking Mode

Parking Mode is available when you want to monitor your vehicle during parking. There are two parking modes for your GSCOUT GPS in-car camera:

P Mode (Vibration boot): Press and hold the DOWN button to enable or disable P Mode. When P Mode is enabled, the camera will automatically start recording when collision occurs. If the vibration continuously happens, the icon will turn into red color. After vibration stops, the camera will shut down automatically.

T Mode (Time-lapse photography): Press and hold the OK button to enable or disable T Mode. When T Mode is enabled, continuously recording will be started at the speed of 1 photo per second, after which they will be played in the speed of 30 photos per second.

Tips: When Parking Mode (P Mode or T Mode) is on, the camera will consume power from its internal battery. For long period time of parking monitoring, it is suggested to connect the car camera to external power source or external battery.

4.3 GPS Function

Your GSCOUT GPS in-car camera is equipped with GPS tracking function. It has GPS positioning module to record the complete driving path for users.

When the GPS positioning is unsuccessful, the GPS shown on the screen is red.

When the GPS positioning is successful, the GPS shown on the screen will turn green. Meanwhile, the current longitude and latitude will be shown on the screen.

You can play the recorded video with GPS path with our Goodmans Player software. The software is already included in the bundled SD Card. You can install the software on your Windows PC to play the video.



4.4 Video Recording Mode

After start up, video recording will be started automatically. You can manually stop or resume recording by pressing the OK button.

Cycle recording: When the SD card is full, the former unprotected files would be covered automatically by new recorded files.

File protection by vibration: The GSCOUT GPS in-car camera is equipped with a gravity sensor. When there is any vibration detected by the g-sensor, the video will be automatically protected and saved as SOS_XXXX

Manual protection: During recording, user can press the SOS button to manually protect current video. Press again the SOS button will cancel to protect current video.

Screen timeout: After the camera is working for about 1 minute without pressing any button, the LCD backlight will be off automatically. The backlight can be turned on again when pressing any button. This function can be set in the system menu.

4.5 Photo Mode

When recording is stopped during Video Recording Mode, you can switch to Photo Mode by pressing the MODE button once. You can take a photo by pressing the OK button. You can use the digital zoom by pressing the UP or DOWN buttons. The image resolution can be set by pressing the MENU button.

4.6 File Playback Mode

Under Playback Mode, you can do the below operations by pressing menu buttons:

1. Adjust the volume
2. Delete the files
3. Protect or Unlock Protect the files

4.7 LDWS

Your GSCOUT GPS in-car camera is equipped with LDWS (Lane Departure Warning System). You can turn on / off in the Movie Mode settings menu. When LDWS is enabled, the camera will warn

5 Troubleshooting



Problem	What to do
There is no sound from the recorded video	Check that the voice recording function is not turned off.
The camera has no display	Check if you have set screen timeout setting.
The camera cannot turn on	Check if you have connected the supplied car charger to the camera.
The camera cannot record video	Check if you have inserted SD Card into the SD Card slot. If problem continues to happen, you can try to format the SD Card or change to another SD Card.
The camera hangs or is not working properly	If you can enter setting menu, please try to restore factory setting. If there is no response from the camera, please press the reset button on the camera.

6 Technical Specification



Model Number	GSCOUT GPS
Power Supply	5V, 1000mA
LCD Display	2.7" LCD with high definition display
Visual Angle	158 degrees
Video recording resolution	1080p 30fps / 720p 30fps / 720p 60ps / VGA 30fps
Video format	MOV
Microphone / Loudspeaker	Built-in
G-sensor	Built-in
Battery	Built-in Li-polymer battery
GPS	Built-in with bundled GPS antenna

7 Customer Support

For all product support, warranty or returns;
please go to www.goodmans.co.uk/support