

# CD-G KARAOKE WITH BLUETOOTH STREAMING

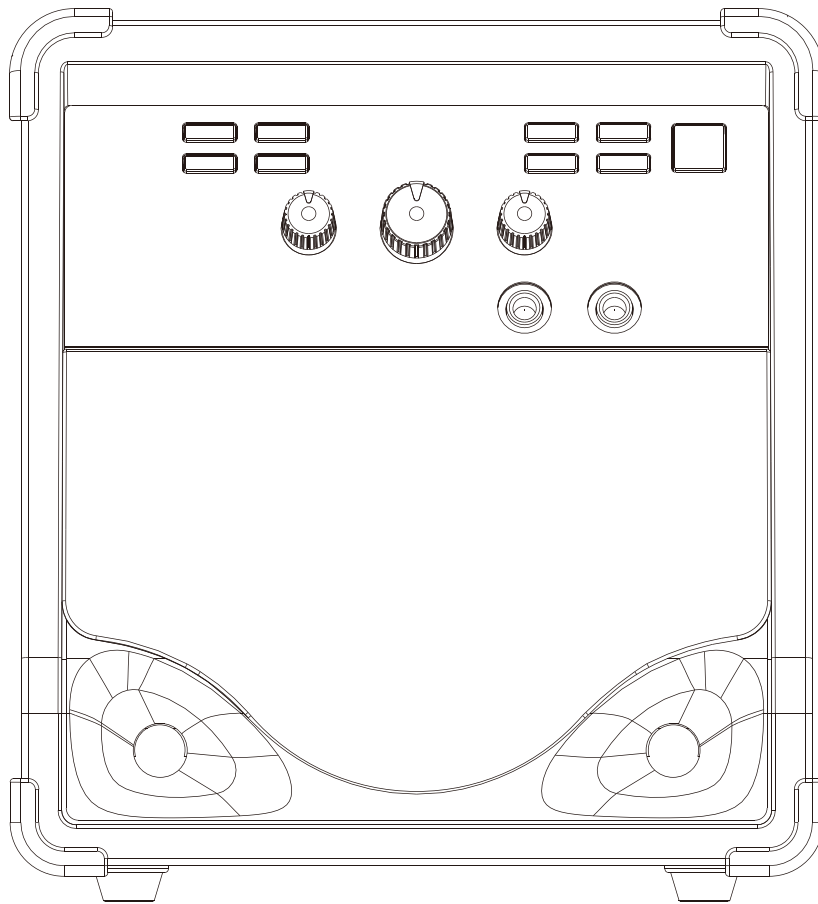

MODEL: XB16CDGBT

## USER MANUAL



**Goodmans**

# 1 Welcome



## 2 Your CDG Karaoke

2.1 In The Box

2.2 Front View

2.3 Top View

2.4 Rear view

2.5 Control panel

## 3 Quick Setup

3.1 Power On/Off and Function Selection

3.2 Auto Power Off

3.3 Adjusting the Volume

3.4 Auto Voice Control

3.5 Balance Control

3.6 Echo Control

3.7 Fitting Batteries

3.8 Selecting LINE IN

## 4 Operation

### **CD Operation**

4.1 Load a Disc

4.2 Playing/Pausing a track

4.3 Skipping Tracks

4.4 Searching Tracks (audio CD only)

4.5 Repeating Tracks

4.6 Programming Tracks

### **Bluetooth Operation**

4.7 Selecting Bluetooth

## 5 Troubleshooting

## 6 Technical Specifications

## 7 Customer Support

# 1 Welcome



Thank you for choosing this Goodmans product. We've been making electronics for the British people for 70 years. Each of our projects has been carefully designed to be great at what it does and this one is no exception. We hope you enjoy your new CD-G Karaoke.

---

## 2 Your CD-G Karaoke

### 2.1 In The Box

Carefully remove your CD-G Karaoke from the packaging.

Inside the box you will find:

- CD-G Karaoke
- Mains Power Adaptor
- Quick Start Guide
- Guarantee Booklet
- CD-G Disk
- AV Cable
- Microphone x 2
- Remote Control

If any of these items are missing, contact customer support.  
Visit: [www.goodmans.co.uk/support](http://www.goodmans.co.uk/support)



### Mains Power

Your CD Boombox requires a mains supply of 230-240V AC ~ 50Hz.  
Please ensure that your mains supply is compatible before use.  
Disconnect the Power Cord from the mains when not in use.

### Position of CD-G Karaoke

Place on a flat, stable surface that is not subject to vibrations. Avoid the following locations:

- Where it is exposed to direct sunlight
- Where it is close to heat radiating sources
- Where the humidity is high and ventilation is poor
- Where it is dusty



## 2.2 Front View

### **A** SPEAKER.

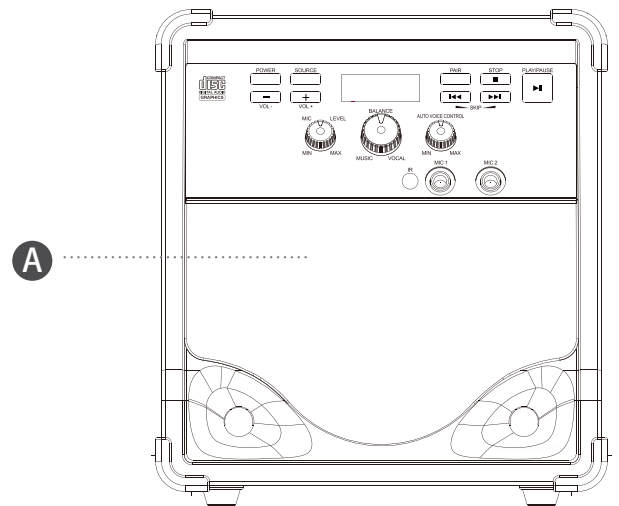

## 2.3 Top View

### **B** CD compartment. Gently press 'OPEN' or 'CLOSE' to release the CD compartment lid.

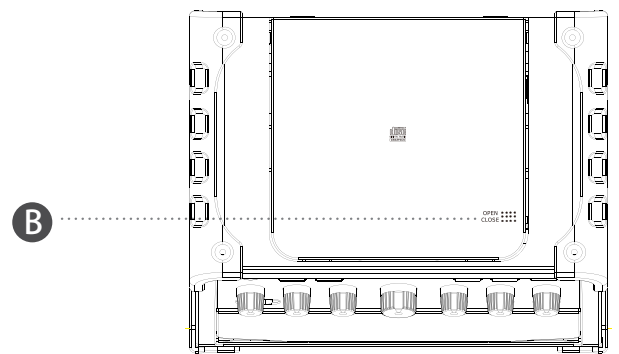

## 2.4 Rear View

### **C** CHARGING PORT

USB charging Port ( DC 5V )

### **D** LINE IN INPUT SOCKET

Connect external audio sources with a 3.5mm audio cable.

### **E** AUDIO OUT & VIDEO OUT SOCKET

Connect to TV with the AV Cable.

### **F** DC mains input socket

Connect the mains adaptor to this socket.

### **G** Battery Compartment

Insert 8x 'C' batteries for portable use.

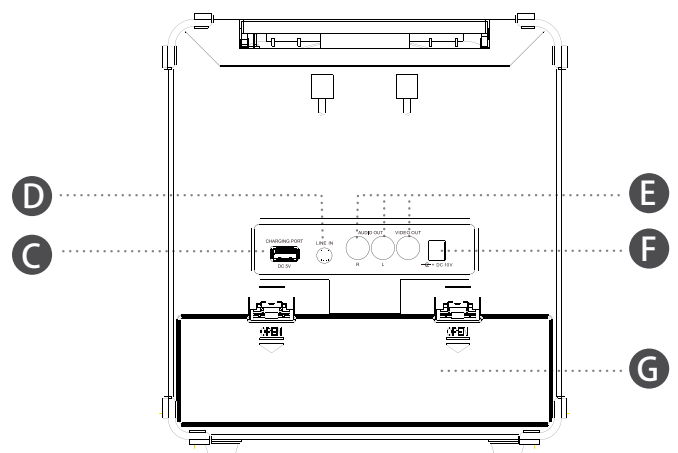



## 2.5 Control Panel

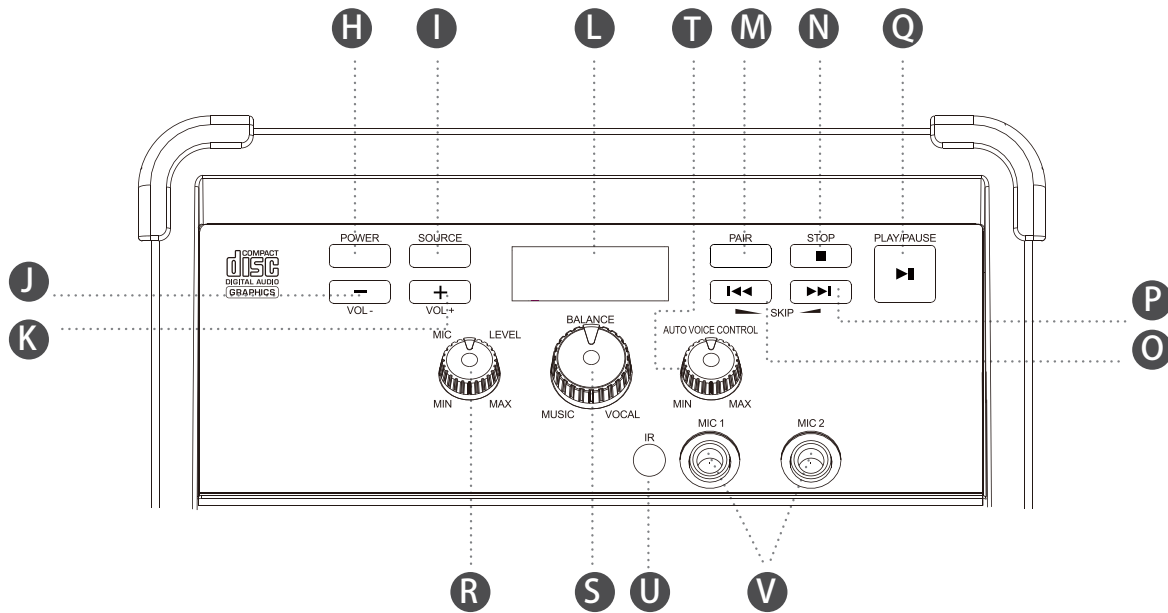

- H POWER button.** Press on/off button.
- I SOURCE button .** Press to select Bluetooth/ CD/Line mode.
- J - button .** Press to decrease the volume output.
- K + button.** Press to increase the volume output.
- L LCD DISPLAY .** Displays all current information relative to the mode selected.
- M PAIR button .** In Bluetooth mode press to initiate the pair function.
- N STOP button .** Press to stop to play the music in the CD mode.
- O ⏮ button .** Press to skip to previous CD tracks. Press and hold to fast rewind CD tracks.
- P ⏭ button .** Press to skip to next CD tracks. Press and hold to fast forward CD tracks.
- Q ▶⏮ button .** In CD mode press to play or pause playback of a CD.
- R Mic LEVEL control**
- S Balance Voice control**
- T Audio Voice control**
- U Infrared Sensor**
- V Microphone sockets**

## 3 Quick Setup



### 3.1 Power On/Off and Function Selection

1. This CD-G Karaoke is supplied with a mains adaptor.  
To connect the power insert the small end in the rear of the unit (N).
2. Insert the UK plug into a household power socket, and switch the power on.
3. Press the POWER button to turn the unit ON.
4. Press the 'SOURCE' button to select Bluetooth/CD/Line in mode.

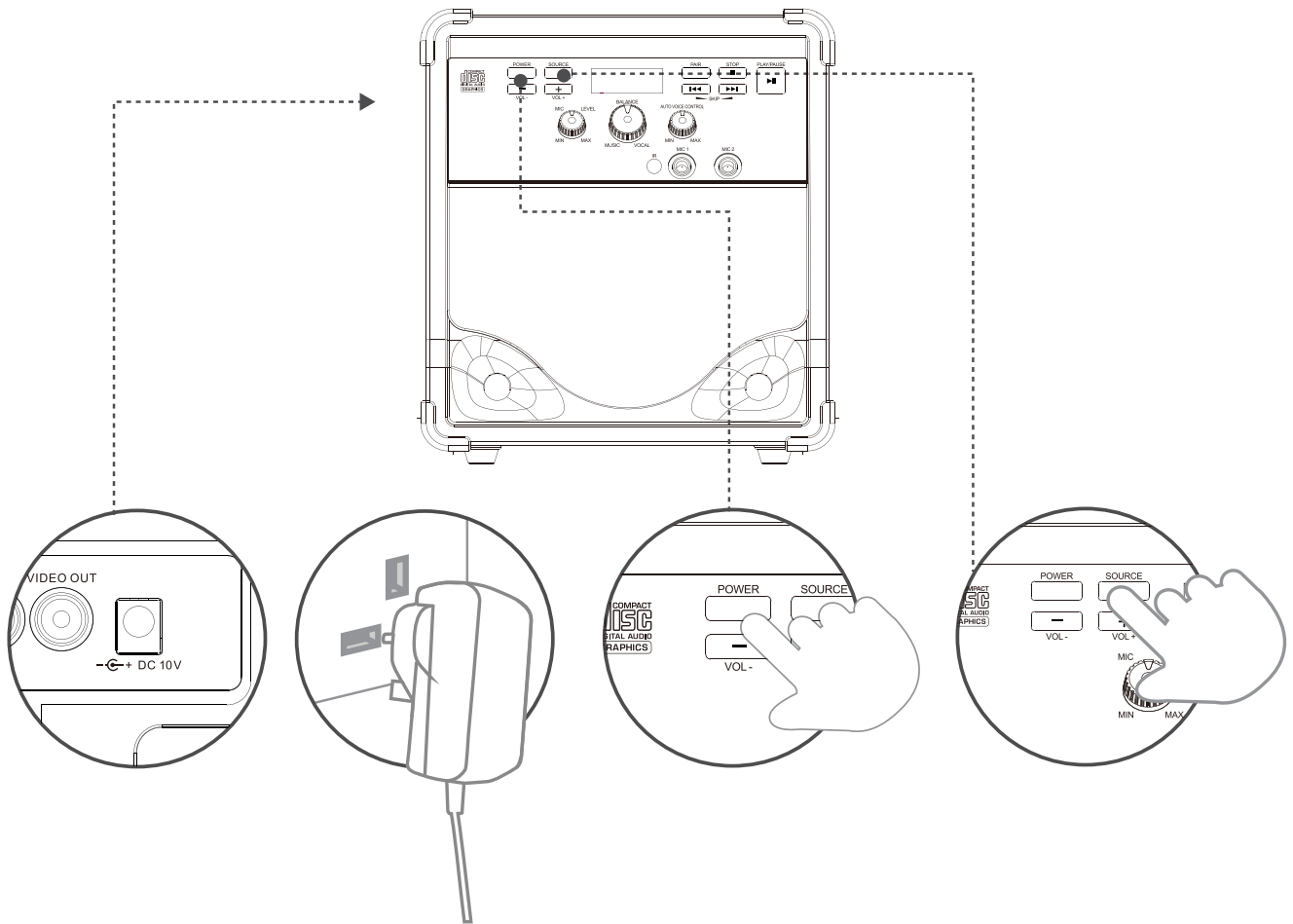

### 3.2 Auto Power Off

If no audio signal is continuously detected from CD or Aux in for more than 170 minutes, the unit will power-off automatically.



### 3.3 Adjusting the Volume

Press the VOLUME control to adjust the volume to a comfortable level.

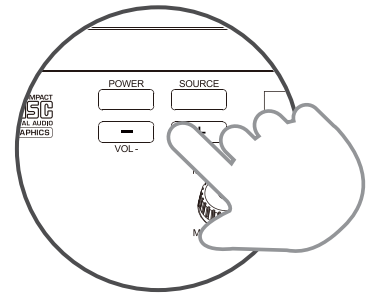

### 3.4 Auto Voice Control

To replace the original singer's voice with your own when a pre-recorded multiplex karaoke disc is used:

1. Rotate the MIC LEVEL to the desired level.
2. Rotate the AUTO VOLCE CONTROL to achieve a balance between playback and microphote volume levels.

#### **DON'T FORGET!**

When the AUTO VOICE CONTROL is selected, the pre-recorded singer's voice on the karaoke CD will mute when you start to sing into the microphone.

### 3.5 Balance Control

To adjust the balance between the original singer's voice and the music when a pre-recorded multiplex karaoke disc is used:

1. Turn the BALANCE CONTROL between music and vocal to achieve the desired effect.

### 3.6 Echo Control

1. In stop mode or playback mode, press remote the ECHO + or - buttons to increase or decrease the echo effect.

The echo effect value will show in the display.

#### **DON'T FORGET!**

There are 8 levels of echo effect available.

2. When the desired echo level is reached, the display will return to the current track number after a few seconds.



### 3.7 Fitting Batteries

1. Open the battery compartment on the bottom of the unit by pressing down on the OPEN symbol and sliding in the direction of the arrow (see diagram below).
2. Insert 8 x C size batteries taking care to match the + & - polarity symbols correctly.
3. Replace the battery compartment cover.

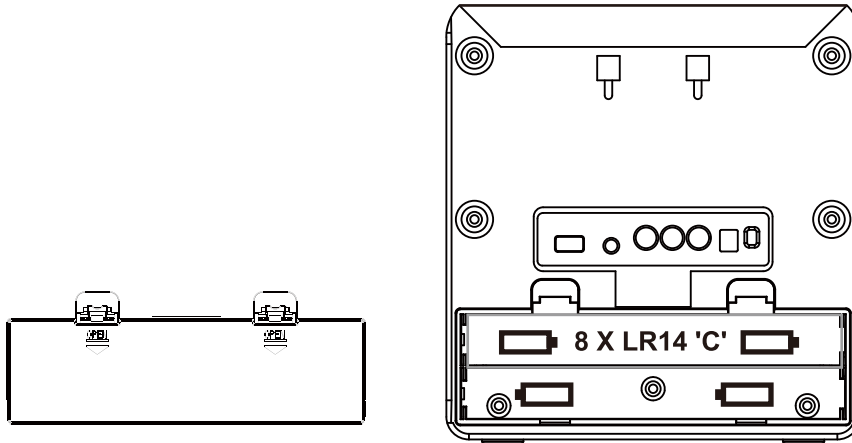

The mains cable must be detached from the DC socket of the player for the batteries to power the unit.

Leaking batteries may damage the battery cabinet and the player as a whole. If you are not going to use the CD-G Karaoke for an extended period, please remove the batteries to avoid damage.

Caution: Danger of explosion if battery is incorrectly inserted.  
Replace only with the same or equivalent type.

### 3.8 Selecting LINE IN

1. Connect one end of the 3.5mm LINE in cable (not included) to the LINE OUT output on the external audio device (for example MP3 player) and the other end of the cable to the LINE IN port on the Unit.
2. Press and hold the POWER button on the Unit, or alternatively press and release the POWER button on the Remote Control.  
Press the Source button and select line in mode.  
Power on the external audio device and use as normal.
3. You can increase or decrease the volume by using the volume buttons on either the Unit or Remote Control.



# 4 Operation



## CD Operation

### 4.1 Load a Disc

1. Open the CD lid using the OPEN button (H).
2. Load a disc onto the disc tray with the label side facing up.
3. Close the CD door.

Note: Please remove the white CD card when you open it for the first time.

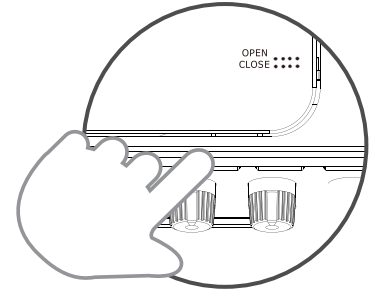

### 4.2 Playing/Pausing a track

1. Press the PLAY/PAUSE button to begin playback of the first track. The Play/Pause indicator will light.
2. To pause playback, press the PLAY/PAUSE button. The Play/Pause indicator will flash.
3. To resume playback, press the PLAY/PAUSE button again.
4. To stop playback of the CD, press the STOP button. The total number of tracks will be shown in the display.

#### **DON'T FORGET!**

If you are playing a CD+G disc, the song lyrics will be displayed when you connect the CD Karaoke to your TV set with the supplied AV lead.

### 4.3 Skipping Tracks

1. During playback, press the SKIP ◀◀ / ▶▶ buttons to skip to the next or previous track.

### 4.4 Searching tracks (audio CD only)

1. During playback, press and hold the SKIP ◀◀ / ▶▶ buttons to search forwards or backwards through the current track.
2. To resume playback, release the SKIP ◀◀ / ▶▶ buttons.

### 4.5 Repeating Tracks

1. During playback, to repeat the current track, press the REPEAT button on the remote control once. The Repeat indicator will flash.
2. To repeat all tracks on the disc, press the REPEAT button twice. The Repeat indicator will stay lit.
3. To cancel the Repeat function, press the REPEAT button again. The Repeat indicator will turn off.

#### **DON'T FORGET!**

Press SKIP ◀◀ / ▶▶ button will auto-cancel repeat function.



## 4.6 Programming Tracks

1. In STOP mode, press the PROGRAM button. The Progrm indicator will flash and “0” will show in the display.
2. Use the SKIP ◀◀ / ▶▶ buttons to select the first track you wish to program.
3. Press the PROGRAM button to enter this into the memory.
4. Repeat steps 2 and 3 until all the desired tracks are programmed into the memory.

### **DON'T FORGET!**

A maximum of 20 tracks can be programmed into the memory.  
In program mode, repeat function is can't activate.

5. To begin playback of the programmed tracks, press the PLAY/PAUSE button.
6. To clear the programmed tracks, press the STOP button twice.



## Bluetooth Operation

### 4.7 Selecting Bluetooth

1. Press and hold the POWER button on the unit or alternatively press and release the POWER button on the Remote Control.
2. Press the SOURCE button and select BT mode or press the BT button on the Remote Control to switch Bluetooth mode.
3. Press the PAIR button on the unit or press the remote control. The PAIR word will flash quickly.
4. Use the controls on your Bluetooth device to select XB16CDGBT in your Bluetooth settings to pair . If you device request a password, enter the password "0000". Refer to the user's manual for your specific device for instructions on pairing and connecting Bluetooth devices.

## 5 Troubleshooting



Problem	What to do
No Power	<p>Check the mains plug is connected to the wall socket. Switch the wall socket ON.</p> <p>Press the STANDBY button (I) to wake from Standby mode.</p>
No sound from the CD	<p>The volume level is too low. Increase using the volume control (E).</p>
No sound from an AUX input	<p>The volume level is too low. Increase using the volume control.</p> <p>The external audio source volume is too low, increase the volume level.</p>
The sound is distorted	<p>Reduce the CD boombox volume level using the volume control (E).</p>
The sound is distorted from an AUX input	<p>The external audio source volume is too high, decrease the volume level.</p>
Unable to play a CD	<p>Check there is a disc present in the CD compartment.</p> <p>Remove and re-insert the CD with the label side facing upwards.</p> <p>Clean the disc, it may be dirty. If scratched try another disc.</p>
No sound from the Bluetooth input	<p>Check the external device is paired correctly.</p> <p>The external audio source volume is too low, increase the volume level.</p>

Model Number	XB16CDGBT
Power Supply	AC 230 ~ 50 Hz DC 10V Adaptor - 8x 'C' size batteries
Speaker Output Power	10W (RMS)
Speaker Impedance	4 Ohms
Supported Disc Types	CD-DA, CD-R, CD-RW, CD-G
Max Power Consumption	AC 10W
Dimensions	226mm (H) x 185mm (W) x 248mm (D)

7

Customer Support

Our customer service team is available for technical or guarantee support. Visit [www.goodmans.co.uk/support](http://www.goodmans.co.uk/support)