

# Goodmans

**PORTABLE CD/MP3 DISC PLAYER  
STEREO RADIO CASSETTE RECORDER**

**GPS223MP3**

**Instruction Manual**

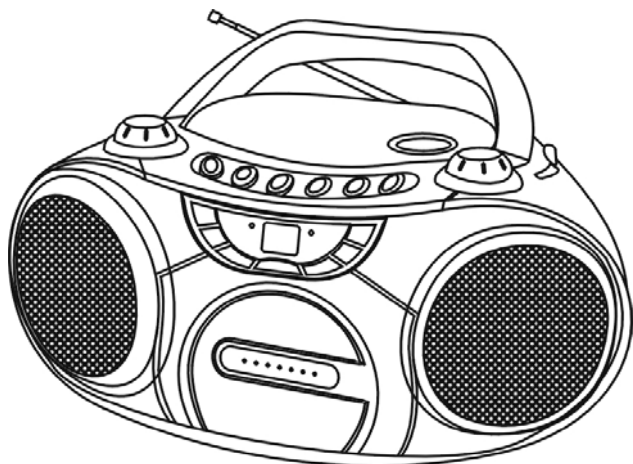

# IMPORTANT SAFEGUARDS

## Electrical Information

This appliance is fitted with a BS1363/A 13 AMP PLUG. If it is not suitable for your supply sockets it must be removed and replaced with an appropriate plug. If the plug becomes damaged and/or needs to be replaced please follow the wiring instructions below. The plug removed must be disposed of immediately. It must not be plugged into a supply socket as this will be an electrical hazard. If the fuse needs to be replaced it must be of the same rating and ASTA approved to BS1362. If the plug is changed, a fuse of the appropriate rating must be fitted in the plug, adapter or at the distribution board. If the fuse in a moulded plug is replaced, the fuse cover must be refitted before the appliance can be used.

## Wiring instructions

The supply cable will be either 2-core or 3-core. Follow the appropriate wiring instructions given below. In both cases ensure that the outer sheath of the cable is firmly held by the cable clamp.

### 2 - CORE

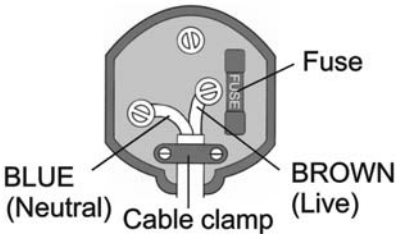

**WARNING!** Do not connect either wire to the earth terminal.

This symbol indicates that this 2-core appliance is Class II and does not require an earth connection.

The wire coloured blue must be connected to the terminal marked with the letter N or coloured black.

The wire coloured brown must be connected to the terminal marked with the letter L or coloured red.

### 3 - CORE

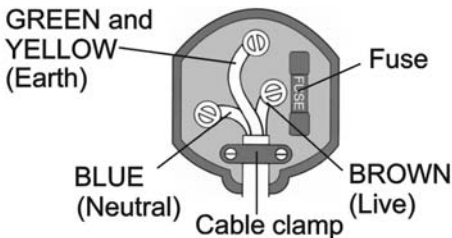

**WARNING!** This appliance must be earthed.

The wire coloured green and yellow must be connected to the terminal marked with the letter E, or by the earth symbol,  $\perp$ , or coloured green or green and yellow.

The wire coloured blue must be connected to the terminal marked with the letter N or coloured black. The wire coloured brown must be connected to the terminal marked with the letter L or coloured red.

## CAUTION

### CLASS 1 LASER PRODUCT

Use of Controls or adjustments or performance of procedures other than those specified herein may result in hazardous radiation exposure.

### LASER SAFETY

This unit employs a laser, only qualified service personnel should attempt repair.



**DANGER:** INVISIBLE LASER RADIATION WHEN OPEN AND INTERLOCK FAILED OR DEFEATED. AVOID DIRECT EXPOSURE TO BEAM.

**CAUTION:** HAZARDOUS LASER RADIATION WHEN OPEN AND INTERLOCK DEFEATED.

### CAUTION

**CLEANING:** Always disconnect unit from mains supply before attempting to clean it. Use soft cloth moistened with soapy water, wipe gently. Do not use solvents or abrasive materials.

### SOME DO'S AND DONT'S ON THE SAFEUSE OF EQUIPMENT

This equipment has been designed and manufactured to meet European safety standards but like any electrical equipment, care must be taken if you are to obtain the best results and safety is to be assured.

Do read the operating instructions before you attempt to use the equipment.

Do ensure that all electrical connections (Including the mains plug, extension leads and interconnections between pieces of equipment) are properly made in accordance with the manufacturer's instructions. Switch off and withdraw the mains plug when making or changing connections.

Do consult your dealer if you are ever in doubt of the installation, operating, or safety of your equipment.

Don't continue to operate the equipment if you are in any doubt about it working normally, or if it is damaged in any way- switch off, withdraw the mains plug and consult your dealer.

Don't remove any fixed covers as this may expose dangerous voltages.

Don't leave equipment switched on when it is unattended unless it is specifically stated that it is designed for unattended operation or has a standby mode. Switch off using the switch on the equipment and made sure that your family knows how to do this. Special arrangements may need to be made for infirm or handicapped people.

Don't listen to headphones at high volume, as such use can permanently damage your hearing.

Don't obstruct the ventilation of the equipment, for example with curtains or soft furnishings. Overheating will cause damage and shorten the life of the equipment.

Don't allow electrical equipment to be exposed to rain or moisture.

### Above all

- Never let anyone, especially children, push anything into holes, slots or any other opening as this could result in a fatal electric shock.
- Never guess or take chances with electrical equipment of any kind.
- It is better to be safe than sorry!

**WARNING:** TO REDUCE THE RISK OF FIRE OR ELECTRIC SHOCK, DO NOT EXPOSE THIS APPLIANCE TO RAIN OR MOISTURE, DANGEROUS HIGH VOLTAGES ARE PRESENT INSIDE THE ENCLOSURE, DO NOT OPEN THE CABINET, REFER SERVICING TO QUALIFIED PERSONNEL ONLY.

# IMPORTANT NOTES

Your hearing is very important to you and to us so please take care when operating this equipment. The following guidelines are provided for your information.

## ESTABLISH A SAFE SOUND LEVEL

- Over time your hearing will adapt to continuous loud sounds and will give the impression that the volume has in fact been reduced. What seems normal to you may in fact be harmful. To guard against this **BEFORE YOUR HEARING ADAPTS** set the volume at a low level.
- Slowly increase the level until you can hear comfortably and clearly and without distortion.
- Damage to your hearing is accumulative and is irreversible.
- Any ringing or discomfort in the ears indicates that the volume is too loud.
- Remember listening for prolonged period of time at high volume levels will harm your hearing.

**Once you have established a comfortable listening level, DO NOT INCREASE THE SOUND LEVEL FURTHER.**

The following list of typical sound levels may assist you in recognizing just how loud you have set the volume level.

## DECIBEL

<u>Level dB</u>	<u>Example</u>
-----------------	----------------

30dB	Quiet library, soft whisper.
40	Living room, fridge freezer bedroom away from traffic.
50	Normal conversation, quiet office, light traffic.
60	Electric sewing machine.
70	Vacuum cleaner, hair dryer, noisy restaurant.

## THE FOLLOWING NOISE CAN BE HARMFUL UNDER CONSTANT EXPOSURE

80dB	Average city traffic, alarm clock buzzer at 1 Metre, food mixer.
90	Motorcycle, heavy goods vehicle, petrol lawn mower.
100	Pneumatic drill, chain saw, garbage truck,
120	Rock band concert, thunderclap, fast train passing by.
140	<b>THRESHOLD OF PAIN</b> Gunshot, jet plane taking off.
180	Rocket Launching pad.

## TABLE OF CONTENTS

Power Sources.....	5
Player Maintenance.....	5
Disc Cleaning, Power failure.....	6

### Player Operation

Location of Controls.....	7
Location of display indicators.....	8
Radio operation.....	9
CD/MP3 playback.....	10
Cassette operation.....	12
Care of cassette tapes.....	14
To record from the built-in radio.....	15
To record from MP3/CD.....	16
Listening with headphone/earphone.....	17
Product specifications.....	17

## SAFETY PRECAUTIONS

1. As the laser beam used in this compact disc player is harmful to the eyes, do not attempt to disassemble the casing.
2. Stop operation immediately if any liquid or solid object should fall into the cabinet. Unplug the unit and have it checked by qualified personnel.
3. Do not touch the lens or poke at it. If you do, you may damage the lens and the player may not operate properly.
4. Do not put anything in the safety slot. If you do, the laser diode will be ON when the lid is still opened.
5. This unit employs a laser. The use of controls or adjustments or performance of procedures other than those specified herein may result in exposure to hazardous radiation.

## WARNING

To prevent fire or shock hazard, do not expose the unit to rain or moisture.

To avoid electrical shock, do not open the cabinet. Refer servicing to qualified personnel only.

# 1. POWER SOURCES

## AC MAINS

Insert the plug of AC power cord into wall outlet and the connector into the AC supply socket on the rear of the unit. Battery power will be disconnected automatically.



## BATTERY OPERATION

Remove the Battery Compartment Cover and insert 6 pcs UM-1 (Size D ) batteries, replace the cover.

**NOTE:**

ENSURE BATTERIES ARE CORRECTLY INSTALLED OBSERVING THE POLARITY AS SHOWN.

**NOTE:**

Old batteries may swell and leak. To avoid damage to your instrument, remove the batteries when the unit is to be stored for long periods of time, or if the batteries become exhausted (the Power Indicator will be faded if the batteries are exhausted). And if radio sound is low or distorted, your batteries probably need replacing.

# 2. PLAYER MAINTENANCE

## CLEANING THE TAPE HEADS

Clean the heads frequently to remove dust and tape residue. Dirt on the heads will impair the sound quality of both recording and playback.

The simple method is to use a head-cleaning cassette, which is available at most audio stores. Follow the instructions supplied with the cleaning cassette.

### 3. DISC CLEANING, POWER FAILURE

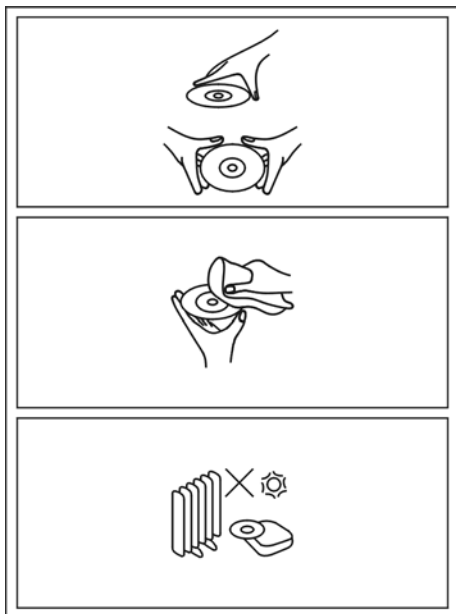

#### Cleaning the Disc

1. To handle a disc use only one of the two manners illustrated.

**Note:** Do not touch the rainbow – coloured Side.

2. To wipe a disc, use only a soft cloth. Do not use or thinner which will damage the disc. The disc should always be wiped in a straight line from the center to the edge. It should never be wiped in a circular motion.

3. Never place the disc on other equipment or near any heat source. Avoid positions where the disc would be subjected to direct sunlight for long periods.

#### Maintenance and care

1. Electronic products should never be subjected to extreme temperatures nor high humidity to ensure good performance and a long life-time. The portable stereo should not be placed in bathing areas, or around stoves and radiators, etc. Always leave sufficient space around the unit for ventilation.

2. If necessary, only clean the cabinet of the unit with a soft dampened piece of cloth (be sure the AC power cord is unplugged from the outlet) Never use a polish or a strong detergent for cleaning since this can damage the finish of the cabinet.

## 4. LOCATION OF CONTROLS

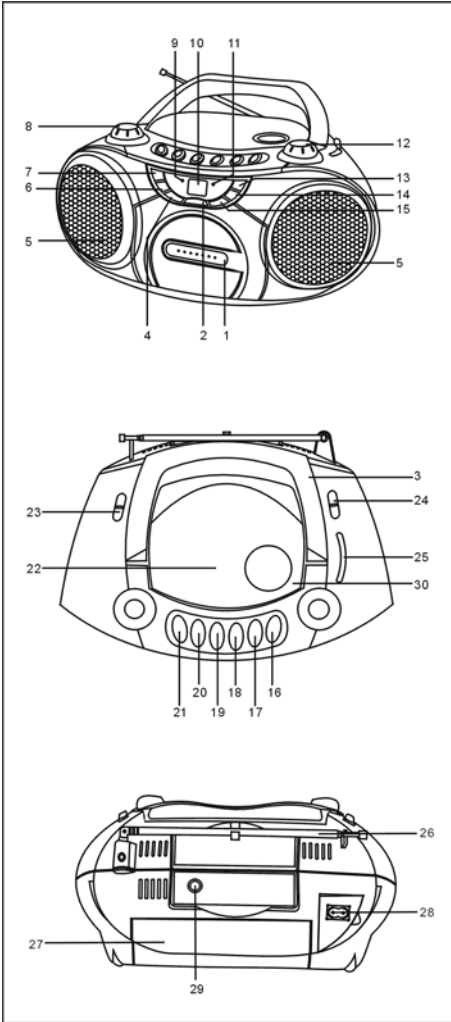

1. CASSETTE DOOR
2. CD PROGRAM BUTTON
3. HANDLE
4. CD STOP BUTTON
5. SPEAKERS
6. CD SKIP BACKWARD BUTTON
7. +10 MP3 BUTTON
8. VOLUME CONTROL
9. POWER INDICATOR
10. CD DISPLAY
11. FM STEREO INDICATOR
12. TUNING CONTROL
13. CD REPEAT BUTTON
14. CD SKIP FORWARD BUTTON
15. CD PLAY/PAUSE BUTTON
16. CASSETTE RECORD KEY
17. CASSETTE PLAY KEY
18. CASSETTE REWIND KEY
19. CASSETTE F.FWD. KEY
20. CASSETTE STOP/EJECT KEY
21. CASSETTE PAUSE KEY
22. CD DOOR
23. FUNCTION SWITCH
24. BAND SWITCH
25. DIAL SCALE
26. FM TELESCOPIC AERIAL
27. BATTERY COMPARTMENT COVER
28. AC SOCKET
29. PHONES SOCKET
30. CD DOOR OPEN/CLOSE BUTTON



## 5. LOCATION OF DISPLAY INDICATORS

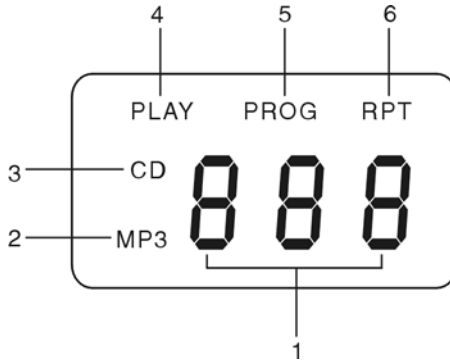

1. **TRACK NUMBER:** The current track number.
2. **MP3:** Inserted CD is MP3 CD.
3. **CD:** Inserted CD is a standard AUDIO CD.
4. **PLAY:** Playback/Play is paused.
5. **PROG:** Playback mode is set to PROGRAMMED PLAYBACK.
6. **RPT:** Playback mode is set to REPEAT mode.

## 6. RADIO OPERATION



For better reception  
For MW(AM)



For FM

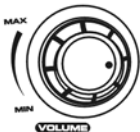

1. Slide the FUNCTION switch to the RADIO.
2. Select the desired band with the BAND switch.
3. Tune to the desired station by rotating the TUNING control and the tuning scale as a guide to current frequency.
4. The built-in MW aerial and external FM TELESCOPIC aerial are directional.
  - When receiving an FM broadcast, fully extend the TELESCOPIC aerial and position for the best reception.
  - For MW broadcasts, rotate the whole set until the best reception is heard.
5. Adjust the volume level to a comfortable listening level.
6. To turn off the radio, slide the FUNCTION switch to the TAPE position.

### NOTES:

- If a particular FM (STEREO) station is weak, or you hear too much background noise, try moving the position of the band selector switch to the FM (MONO) position. This can often result in a much clearer reception.
- When the band selector switch is set to FM STEREO and a stereo broadcast is being received, the FM STEREO indicator on the top of the unit will be lit.

## 7. CD/MP3 PLAYBACK

### PLAYING A CD

1. Make sure the power is connected, slide the FUNCTION switch to CD/MP3 position, POWER indicator will light.
2. Load a disc into the CD compartment. Close the CD door, the disc will begin to spin, and "---" is shown on the display.
3. After the disc is read successfully, the DISPLAY shows track number (CD disc). Press Play/Pause button to begin playback. The playback starts from track 1, "PLAY" is shown in the display. Adjust the VOLUME control to the desired volume level.
4. To pause playback, press the CD PLAY/PAUSE button again.
  - To interrupt playback, press PLAY/PAUSE button. "PLAY" will flash in the display.
  - To resume playback, press PLAY/PAUSE button again, "PLAY" will remain steady on in the display.
5. To stop playback, press STOP button, the total number of tracks is shown in the display.
6. To turn off the player, slide the FUNCTION switch to TAPE position.

### SELECTING A DESIRED TRACK/PASSAGE

#### To select a desired track

- Press SKIP FORWARD /SKIP BACKWARD button repeatedly in stop mode or during playback until the desired track is shown on the display.
- Press PLAY/PAUSE button to start play.

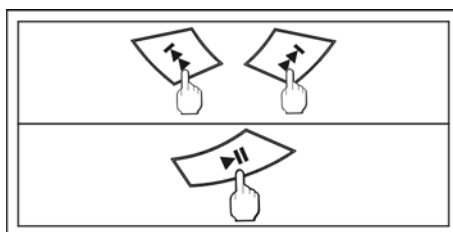
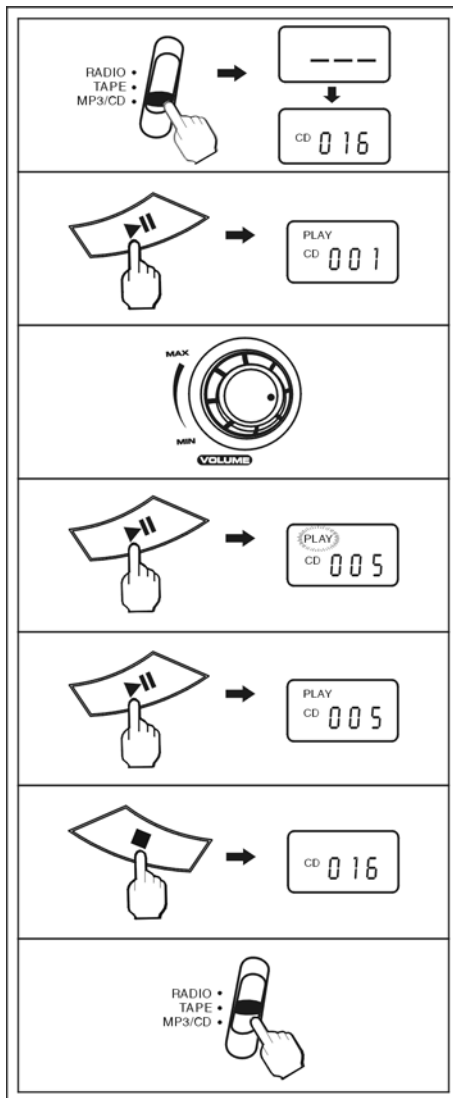

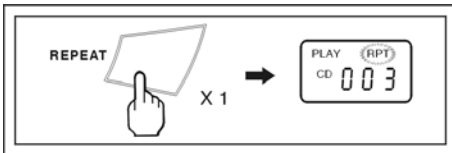
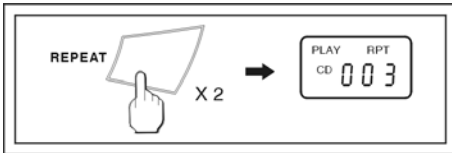
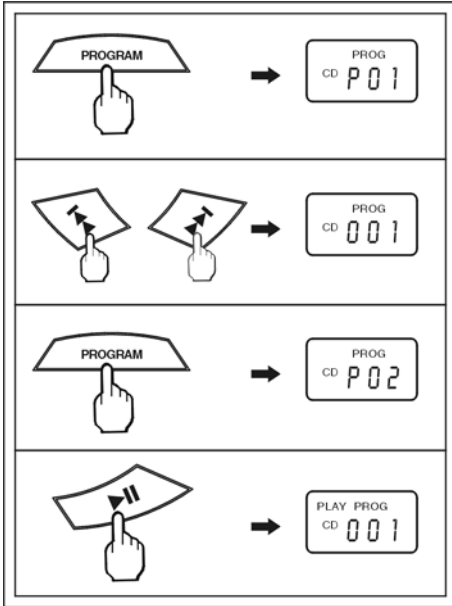

## PROGRAM TRACKS

Up to 20 tracks can be stored in the memory for playback in any order.

1. In stop mode, press PROGRAM button to enter program setting, " <sup>PROG</sup> CD P 0 1 " is shown in the display.
2. Press FORWARD SKIP button to select the first desired track to be programmed.
3. Press PROGRAM button to enter. The display shows " <sup>PROG</sup> CD P 0 2 " appears in the display.
4. Repeat steps 2 & 3 to store other desired tracks until all tracks programmed.
5. Press PLAY/PAUSE button to start playback from the first programmed track.
6. Press STOP button to stop program playback.

### To Erase the Memory (Program)

1. Press STOP button when the disc is stopped, or
2. Open the CD compartment lid, program will be erased.

## REPEAT

### To Repeat a Single Track

1. Press REPEAT button once in play, "RPT" will flash in the display. The current track will be played repeatedly until the STOP button is pressed
2. To cancel repeat play, press REPEAT button twice. "RPT" is no longer shown in the display.

### To repeat all the Tracks

1. Press REPEAT button twice in play, "RPT" is shown steadily in the display, all tracks on the disc will be played repeatedly until the STOP button is pressed.
2. To cancel repeat play, press REPEAT button once. "RPT" is no longer shown in the display.

**To select a song which track number exceeds 20 (for MP3 only)**

Press the +10 MP3 button to skip 10 tracks each time. For example, to select track 45, press +10 MP3 button 4 times, then press the SKIP FORWARD button five times, the display will show the track number.

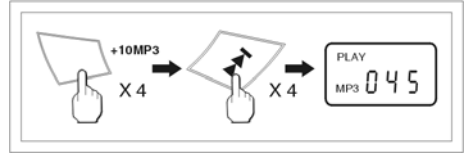

## 8. CASSETTE OPERATION

### RECORD

Press the RECORD key to make a recording from CD, RADIO or the Internal Microphone.

**Note:**

If a recordable cassette is inserted when the RECORD button is pressed, the PLAY button will be depressed at the same time. The record key will not go down if the cassette is protected; see "Protecting recordings from being erased."

### PLAY button

Press the PLAY button to start playing a cassette.

### REWIND button

Press the REWIND button to quickly rewind a tape. Press STOP/EJECT to release the button at the end of the tape.

### FF button

Press the FAST FORWARD button to quickly advance the tape. Press STOP/EJECT to release the button at the end of the tape.

### STOP EJECT button

Press the STOP/EJECT button to stop playback, recording, rewinding or Fast forwarding. In stop mode press the button to eject the cassette.

### PAUSE

Press the PAUSE button to pause playback or recording. To resume press the button again.

**Note:** In Pause mode the cassette motor is still engaged and therefore to prevent damage tapes should not be left paused for a long period of time.

### AUTOMATIC STOP

The Cassette mechanism has a built-in automatic stop. During Playing/Recording, the unit will automatically stop when the end of the tape is detected.

## TO PLAY A CASSETTE TAPE

1. Open the cassette door by pressing the cassette STOP/EJECT button.
2. Insert a cassette with the exposed tape facing upwards and the full reel on the right (unit plays from right to left) into the tracks on the inside of the cassette door.
3. Close the cassette door.
4. Set the function switch to the TAPE position.
5. Press the cassette PLAY button to start the tape playing.
6. Adjust the VOLUME CONTROL to a comfortable listening level.
7. To stop the tape playing, press the STOP/EJECT button. Press the button again to open the cassette door and eject the tape.

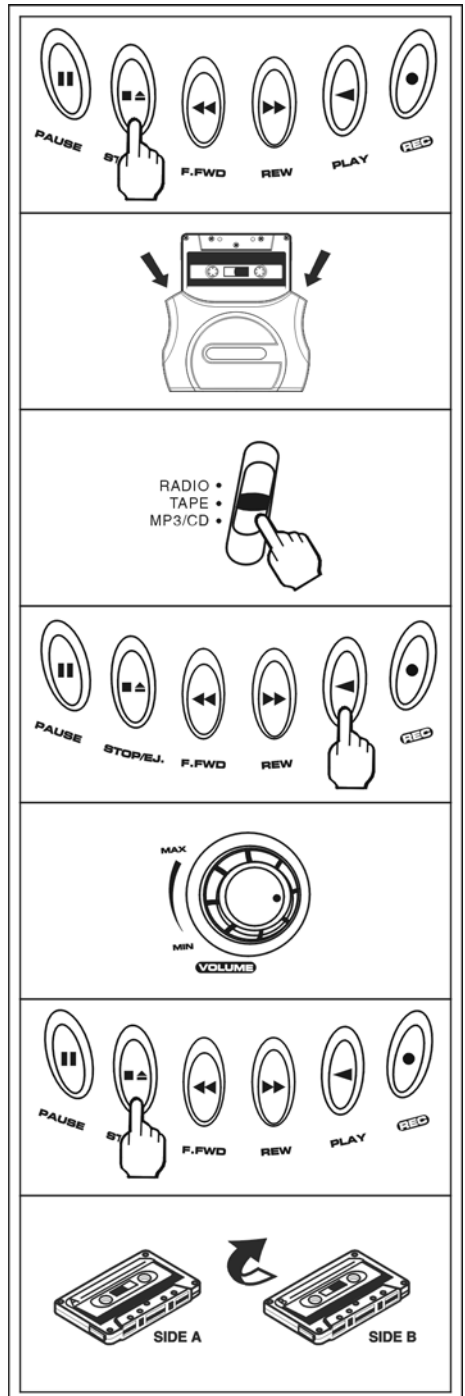

### Note:

During playback, when the end of the tape is reached the PLAY button will pop up and play will stop. To play the other side of the tape, remove the cassette, turn the cassette over so that the full reel is on the right, replace the cassette and press the PLAY button.

## 9. CARE OF CASSETTE TAPES

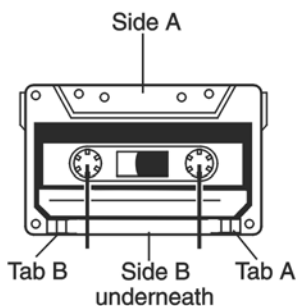
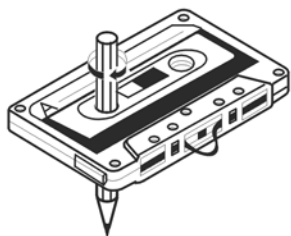

### TO HELP AVOID TANGLES

Loose tape may jam or get tangled in the cassette recorder. With a hexagonal pencil or a similar tool, gently turn the pencil to tighten the tape, as shown opposite.

If the spool feels tight when taking up slack tape as described above, this may be due to ridges on the spool of tape. Tight spools can lead to uneven playback speed or tape tangling. In most cases the ridges can be removed by fast winding the cassette from one end to the other and back again.

Avoid the use of C120 tapes with this unit.

### PROTECTING RECORDINGS FROM BEING ERASED.

To prevent recordings from being erased accidentally, break out the tab(s) with a screwdriver. When the edge with the exposed tape is facing away from you, the tab that protects the side that is uppermost is on your right, as shown opposite.

To record on a protected cassette, seal the open slots with adhesive tape.

## 10. TO RECORD FROM THE BUILT-IN RADIO

1. Slide the FUNCTION switch to the RADIO position and tune to the desired station.
2. Load a cassette into the cassette compartment, with the full reel on the right.
3. Press the cassette RECORD button until it locks in the down position (PLAY button is depressed at the same time) and recording will start.
4. To end the recording press the cassette STOP EJECT button. If this button is not pressed the recording will stop automatically when the end of the tape is reached.
5. To listen to your recording, move the FUNCTION switch to the TAPE position, press the cassette REWIND button until the start point of the recording is reached and then press the PLAY button. Use the VOLUME control to adjust the playback level to your personal taste.

### Note:

On each end of the tape there is a tape leader and no recording will take place over this portion of the tape. If you wish recording to take place as soon as the RECORD button is pressed, please ensure that the leader is wound past the record head.

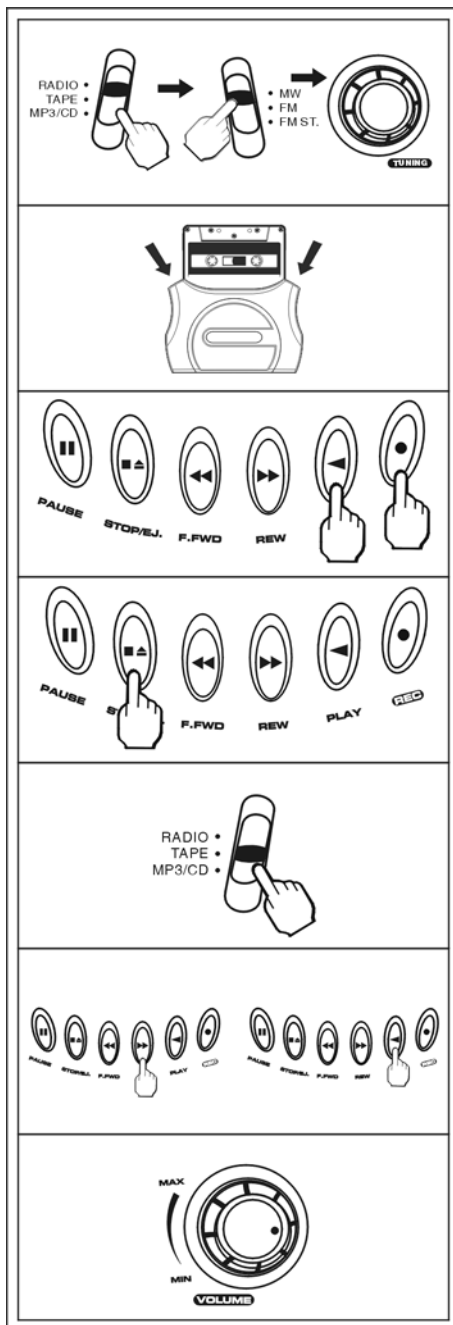



## 11. TO RECORD FROM MP3/CD

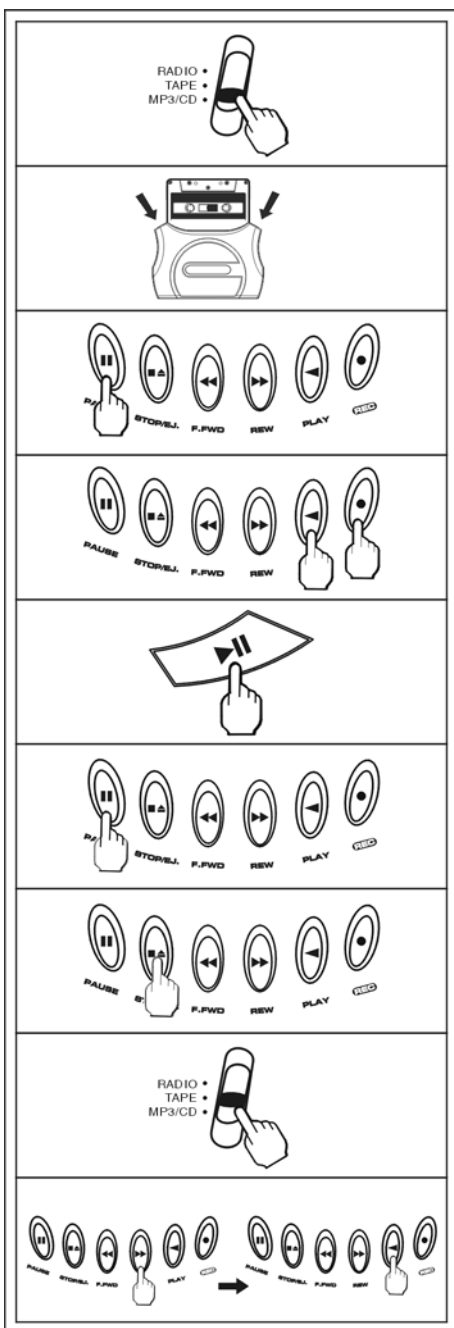

- Slide the FUNCTION switch to the CD (MP3) position.
- Load a cassette into the cassette compartment with the full reel on the right.
- Insert the compact disc to be recorded from and close the CD door.
- Press the cassette PAUSE button on the tape deck.
- Press the cassette RECORD and PLAY buttons so they lock in the down position. (The unit is now in recording standby mode).
- Start the CD playing by pressing the CD PLAY PAUSE button.
- Press the cassette PAUSE button again and then recording begins.
- To end the recording, press the cassette STOP/EJECT button.
- Press the CD STOP button and then move the FUNCTION switch to the TAPE position.
- To listen to your recording, press the REWIND button to return to the point where the recording started and then press the PLAY button.

## 12. LISTENING WITH HEADPHONE/EARPHONE (NOT SUPPLIED)

For private listening without disturbing others, you may enjoy the music with headphone/earphone, set the Volume Control to minimum level, plug the headphone/earphone into Phones socket, adjust the Volume Control to your listening preference. When the headphone is connected the set's speakers will automatically turn off.

**CAUTION:**

Listening at high power for a long periods could damage your hearing.

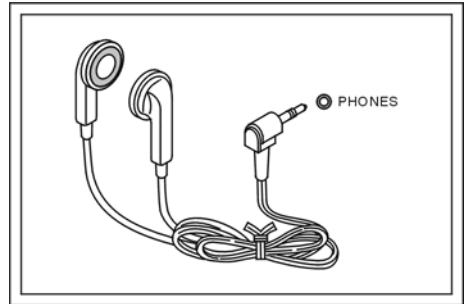

## 13. PRODUCT SPECIFICATIONS

**GENERAL**

Power requirements	AC 230V/50Hz
	DC 9V UM-1 X 6 PCS
Power consumption	AC 15 Watts
Dimensions	Approx.300mm(W)x235mm(D)x155mm(H)
Operation temperature	+5 ° C – +35 ° C

**RECEIVER SECTION**

Receiving Bands	MW/FM
Tuning Range	MW 540 – 1600 KHz
	FM 87.5 – 108 MHz

**COMPACT DISC SECTION**

Optical Pickup	3 – Beam Laser
Frequency Response	100Hz – 16KHz

**CASSETTE SECTION**

Recording System	2 Tracks 2 Channel (Stereo)
Bias System	DC Bias
Frequency Response	125 – 6.3 K H z
Wow And Flutter	0.35% WRMS (JIS)

**AUDIO SECTION**

Power output	1.5 Watts x 2
Headphone Impedance	4 ~ 32 Ohms

**ACCESSORIES**

Instruction Booklet	1
---------------------	---

Please note: Due to the continual improvement of our products, specifications are subject to change without notice.