

Goodmans

PORTABLE CD/MP3 DISC PLAYER STEREO RADIO CASSETTE RECORDER

GPS222MP3

Instruction Manual

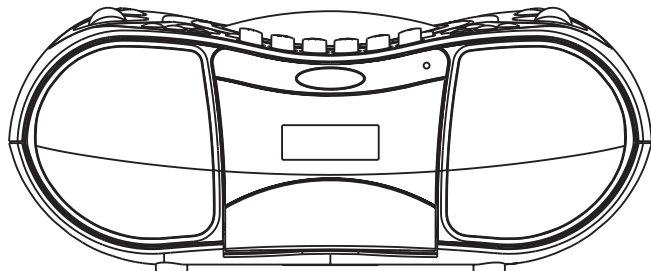

IMPORTANT SAFEGUARDS

PRE FITTED MAINS PLUGS

For your convenience a mains plug has been fitted to this appliance. For your safety please observe the following information.

1. Should the fuse in the plug fail, remove the plug from the wall socket and replace the fuse with a 3 Amp ASTA approved to BS 1362 fuse.
2. Never use the plug without the fuse cover fitted. Replacement fuse covers are available from your dealer or most electrical retail outlets.
3. If the mains plug is cut off the cable, rewire the replacement plug in accordance with instruction given in this manual.
4. CAUTION: Under no circumstances should the discarded plug be inserted into a mains socket. To prevent a shock hazard carefully dispose of the discarded plug. Do not leave the plug lying around where children might see it.

WARNING: To prevent fire or shock hazard do not expose this unit to rain or moisture.

CAUTION: DANGEROUS VOLTAGES EXIST INSIDE THIS UNIT, DO NOT REMOVE COVER (OR BACK). NO USER SERVICEABLE PARTS INSIDE. REFER SERVICING TO QUALIFIED SERVICE PERSONNEL. DISCONNECT FROM MAINS SUPPLY WHEN NOT IN USE.

PLUG WIRING DETAILS

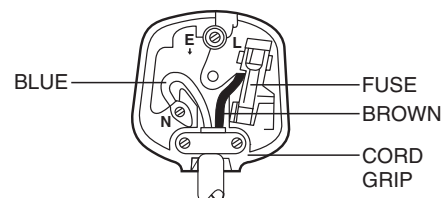

The wires in this mains lead are coloured in accordance with the following wiring codes:

Blue..... Neutral
Brown..... Live

The wires in this mains lead must be connected to the terminals in the plugs as follows:

Blue Wire..... N or Black
Brown Wire..... L or Red

Only a 3 Amp fuse should be fitted in the plug or a 5 Amp fuse at the distribution board.

WARNING: UNDER NO CIRCUMSTANCES MUST THE LIVE OR NEUTRAL WIRES BE CONNECTED TO THE EARTH TERMINAL IN A 3-PIN MAINS PLUG.



This symbol means that this unit is double insulated.
An earth connection is not required.

CAUTION

CLASS 1 LASER PRODUCT

Use of Controls or adjustments or performance of procedures other than those specified herein may result in hazardous radiation exposure.

LASER SAFETY

This unit employs a laser, only qualified service personnel should attempt repair.

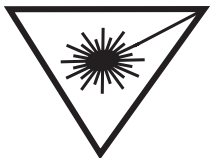

DANGER: INVISIBLE LASER RADIATION WHEN OPEN AND INTERLOCK FAILED OR DEFEATED. AVOID DIRECT EXPOSURE TO BEAM.

CAUTION: HAZARDOUS LASER RADIATION WHEN OPEN AND INTERLOCK DEFEATED.

CAUTION

CLEANING: Always disconnect unit from mains supply before attempting to clean it. Use soft cloth moistened with soapy water, wipe gently. Do not use solvents or abrasive materials.

SOME DO'S AND DONT'S ON THE SAFE USE OF EQUIPMENT

This equipment has been designed and manufactured to meet European safety standards but like any electrical equipment, care must be taken if you are to obtain the best results and safety is to be assured.

Do read the operating instructions before you attempt to use the equipment.

Do ensure that all electrical connections (Including the mains plug, extension leads and interconnections between pieces of equipment) are properly made in accordance with the manufacturer's instructions. Switch off and withdraw the mains plug when making or changing connections.

Do consult your dealer if you are ever in doubt of the installation, operating, or safety of your equipment.

Don't continue to operate the equipment if you are in any doubt about it working normally, or if it is damaged in any way- switch off, withdraw the mains plug and consult your dealer.

Don't remove any fixed covers as this may expose dangerous voltages.

Don't leave equipment switched on when it is unattended unless it is specifically stated that it is designed for unattended operation or has a standby mode. Switch off using the switch on the equipment and made sure that your family knows how to do this. Special arrangements may need to be made for infirm or handicapped people.

Don't listen to headphones at high volume, as such use can permanently damage your hearing.

Don't obstruct the ventilation of the equipment, for example with curtains or soft furnishings. Overheating will cause damage and shorten the life of the equipment.

Don't allow electrical equipment to be exposed to rain or moisture.

Above all

- Never let anyone, especially children, push anything into holes, slots or any other opening as this could result in a fatal electric shock.
- Never guess or take chances with electrical equipment of any kind.
- It is better to be safe than sorry!

WARNING: TO REDUCE THE RISK OF FIRE OR ELECTRIC SHOCK, DO NOT EXPOSE THIS APPLIANCE TO RAIN OR MOISTURE, DANGEROUS HIGH VOLTAGES ARE PRESENT INSIDE THE ENCLOSURE, DO NOT OPEN THE CABINET, REFER SERVICING TO QUALIFIED PERSONNEL ONLY.

IMPORTANT NOTES

Your hearing is very important to you and to us so please take care when operating this equipment. The following guidelines are provided for your information.

ESTABLISH A SAFE SOUND LEVEL

- Over time your hearing will adapt to continuous loud sounds and will give the impression that the volume has in fact been reduced. What seems normal to you may in fact be harmful. To guard against this **BEFORE YOUR HEARING ADAPTS** set the volume at a low level.
- Slowly increase the level until you can hear comfortably and clearly and without distortion.
- Damage to your hearing is accumulative and is irreversible.
- Any ringing or discomfort in the ears indicates that the volume is too loud.
- Remember listening for prolonged period of time at high volume levels will harm your hearing.

Once you have established a comfortable listening level, DO NOT INCREASE THE SOUND LEVEL FURTHER.

The following list of typical sound levels may assist you in recognizing just how loud you have set the volume level.

DECIBEL

<u>Level dB</u>	<u>Example</u>
30dB	Quiet library, soft whisper.
40	Living room, fridge freezer bedroom away from traffic.
50	Normal conversation, quiet office, light traffic.
60	Electric sewing machine.
70	Vacuum cleaner, hair dryer, noisy restaurant.

THE FOLLOWING NOISE CAN BE HARMFUL UNDER CONSTANT EXPOSURE

80dB	Average city traffic, alarm clock buzzer at 1 Metre, food mixer.
90	Motorcycle, heavy goods vehicle, petrol lawn mower.
100	Pneumatic drill, chain saw, garbage truck, discotec/night-club.
120	Rock band concert, thunderclap, fast train passing by.
140	THRESHOLD OF PAIN Gunshot, jet plane taking off.
180	Rocket Launching pad.

TABLE OF CONTENTS

Power Sources.....	1
Player Maintenance.....	2
Disc Cleaning, Power failure.....	3

Player Operation

Location of Controls.....	4
Location of display indicators.....	5
Radio operation.....	6
CD playback.....	7
MP3/WMA disc section.....	8
Cassette operation.....	9
Care of cassette tapes.....	10
To record from the built-in radio.....	11
To record from WMA/MP3/CD.....	12
To record from the built-in microphone.....	13
Listening with headphone/earphone.....	14
Product specifications.....	15

WARNING

To prevent fire or shock hazard, do not expose the unit to rain or moisture.

To avoid electrical shock, do not open the cabinet. Refer servicing to qualified personnel only.

SAFETY PRECAUTIONS

1. As the laser beam used in this compact disc player is harmful to the eyes, do not attempt to disassemble the casing.
2. Stop operation immediately if any liquid or solid object should fall into the cabinet. Unplug the unit and have it checked by qualified personnel.
3. Do not touch the lens or poke at it. If you do, you may damage the lens and the player may not operate properly.
4. Do not put anything in the safety slot. If you do, the laser diode will be ON when the lid is still opened.
5. This unit employs a laser. The use of controls or adjustments or performance of procedures other than those specified herein may result in exposure to hazardous radiation.

1. POWER SOURCES

AC MAINS

Insert the plug of AC power cord into wall outlet and the connector into the AC supply socket on the rear of the unit. Press the Power On/Off Button to turn on the unit. Battery power will be disconnected automatically.

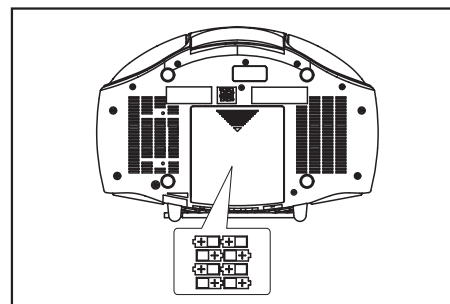

BATTERY OPERATION

Remove the Battery Compartment Cover and insert 8 pcs UM-2 (Size C) batteries, replace the cover.

NOTE: ENSURE BATTERIES ARE CORRECTLY INSTALLED OBSERVING THE POLARITY AS SHOWN.

NOTE: Old batteries may swell and leak. To avoid damage to your instrument, remove the batteries when the unit is to be stored for long periods of time, or if the batteries become exhausted (the Power Indicator will be faded if the batteries are exhausted). And if radio sound is low or distorted, your batteries probably need replacing.

2. PLAYER MAINTENANCE

CLEANING THE TAPE HEADS

Clean the heads frequently to remove dust and tape residue. Dirt on the heads will impair the sound quality of both recording and playback.

The simple method is to use a head-cleaning cassette, which is available at most audio stores. Follow the instructions supplied with the cleaning cassette.

3. DISC CLEANING, POWER FAILURE

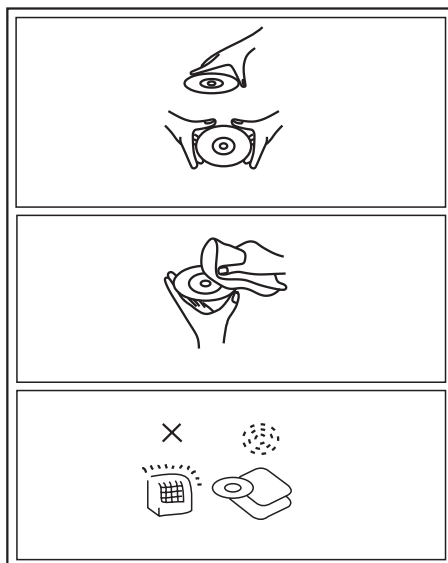

Cleaning the Disc

1. To handle a disc use only one of the two manners illustrated.

Note Do not touch the rainbow - coloured Side.

2. To wipe a disc, use only a soft cloth. Do not use petroleum based products or thinner which will damage the disc. The disc should always be wiped in a straight line from the center to the edge. It should never be wiped in a circular motion.
3. Never place the disc on other equipment or near any heat source. Avoid positions where the disc would be subjected to direct sunlight for long periods.

Maintenance and care

1. Electronic products should never be subjected to extreme temperatures nor high humidity to ensure good performance and a long life-time. The portable stereo should not be placed in bathing areas, or around stoves and radiators, etc. Always leave sufficient space around the unit for ventilation.
2. If necessary, only clean the cabinet of the unit with a soft dampened piece of cloth (be sure the AC power cord is unplugged from the outlet) Never use a polish or a strong detergent for cleaning since this can damage the finish of the cabinet.

4. LOCATION OF CONTROLS

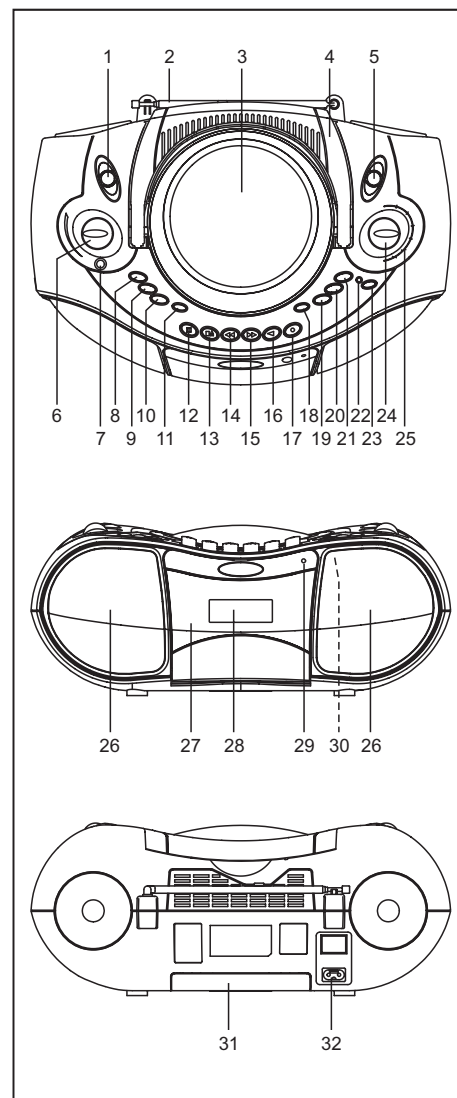

1. FUNCTION SWITCH
2. FM TELESCOPIC AERIAL
3. CD DOOR
4. HANDLE
5. BAND SWITCH
6. VOLUME CONTROL
7. PHONES SOCKET
8. BASS BOOST BUTTON
9. CD PLAY/PAUSE BUTTON
10. CD STOP BUTTON
11. CD MODE BUTTON
12. CASSETTE PAUSE BUTTON
13. CASSETTE STOP/EJECT BUTTON
14. CASSETTE F.FWD. BUTTON
15. CASSETTE REWIND BUTTON
16. CASSETTE PLAY BUTTON
17. CASSETTE RECORD BUTTON
18. CD DOOR OPEN BUTTON
19. CD SKIP/SEARCH DOWN BUTTON
20. CD SKIP/SEARCH UP BUTTON
21. CD PROG BUTTON
22. FM ST. INDICATOR
23. CD ALBUM/10+ BUTTON
24. RADIO TUNING CONTROL
25. DIAL SCALE
26. SPEAKERS
27. CASSETTE DOOR
28. LCD
29. POWER INDICATOR
30. BUILT-IN MIC
31. BATTERY COMPARTMENT COVER
32. AC SOCKET

5. LOCATION OF DISPLAY INDICATORS

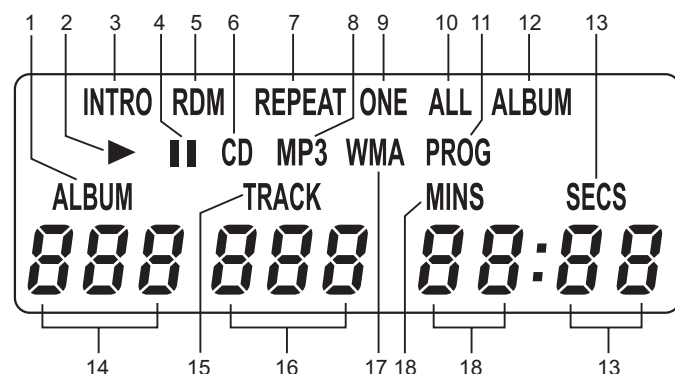

1. ALBUM: The indicator for the current album number (MP3/WMA-CD only).
2. PLAYBACK INDICATOR: Playback.
3. INTRO: Playback mode is set to INTRO SCAN.
4. PAUSE INDICATOR: Playback is paused.
5. RDM: Playback mode is set to RANDOM.
6. CD: Inserted CD is a standard AUDIO CD.
7. REPEAT: Playback mode is set to REPEAT (this icon will show with ONE, ALL or ALBUM). Inserted CD is MP3 CD.
8. MP3: Repeat mode is set to play current track continuously.
9. ONE: Repeat mode is set to play the whole disc continuously.
10. ALL: Playback mode is set to PROGRAMMED PLAYBACK.
11. PROG: Repeat mode is set to play the current directory (album) repeatedly.
12. ALBUM: The elapsed seconds of the current track.
13. ELAPSED SECONDS: The current album number (MP3/WMA-CD only).
14. ALBUM NUMBER: The indicator for the current track number.
15. TRACK: The current track number.
16. TRACK NUMBER: Inserted CD is WMA-CD
17. WMA: The elapsed minutes of the current track.
18. ELAPSED MINUTES:

6. RADIO OPERATION

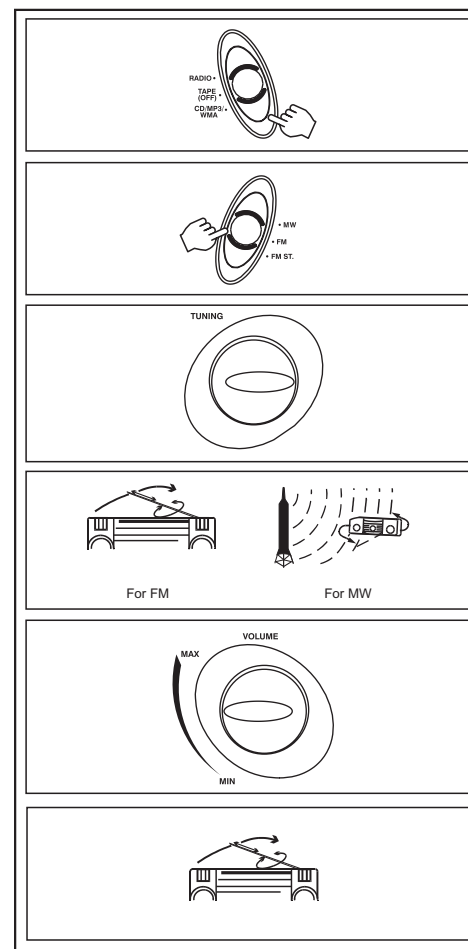

1. Slide the FUNCTION switch to the RADIO.
2. Select the desired band with the BAND switch.
3. Tune to the desired station by rotating the TUNING control.
4. The built-in MW aerial and external FM TELESCOPIC aerial are directional.
 - When receiving an FM broadcast, fully extend the TELESCOPIC aerial and position for the best reception.
 - For MW broadcasts, rotate the whole set until the best reception is heard.
5. Adjust the volume level to a comfortable listening level.
6. To turn off the radio, slide the FUNCTION switch to the TAPE position.

NOTES:

- If a particular FM (STEREO) station is weak, or you hear too much background noise, try moving the position of the band selector switch to the FM (MONO) position. This can often result in a much clearer reception.
- When the band selector switch is set to FM STEREO and a stereo broadcast is being received, the FM STEREO indicator on the top of the unit will be lit.

7. CD PLAYBACK

PLAYING A CD

1. Make sure the power is connected, slide the FUNCTION switch to CD(MP3) position, POWER indicator will light.
2. Load a disc into the CD compartment. Close the CD door, the disc will begin to spin, and "-----" appears on the display.
3. After the disc is read successfully, the DISPLAY shows track number (CD disc). Press Play/Pause button to begin playback. Adjust the VOLUME control to the desired volume level. Press the Bass Boost button for more bass sound effect.
4. To pause playback, press the CD PLAY/PAUSE button again.
 - The current playing track will flash on the display, and the Pause indicator will show in the display.
 - Resume normal playback by pressing PLAY/PAUSE button once more.
5. To stop playing, press the STOP button. The total tracks' number and whole playing time will be shown on the display.
6. To turn off the player, slide the FUNCTION switch to TAPE position.

NOTE: When a CD is burnt with a mix of music files in CD, MP3 and WMA formats, the unit will play it in the sequence of CD, MP3 and WMA files respectively.

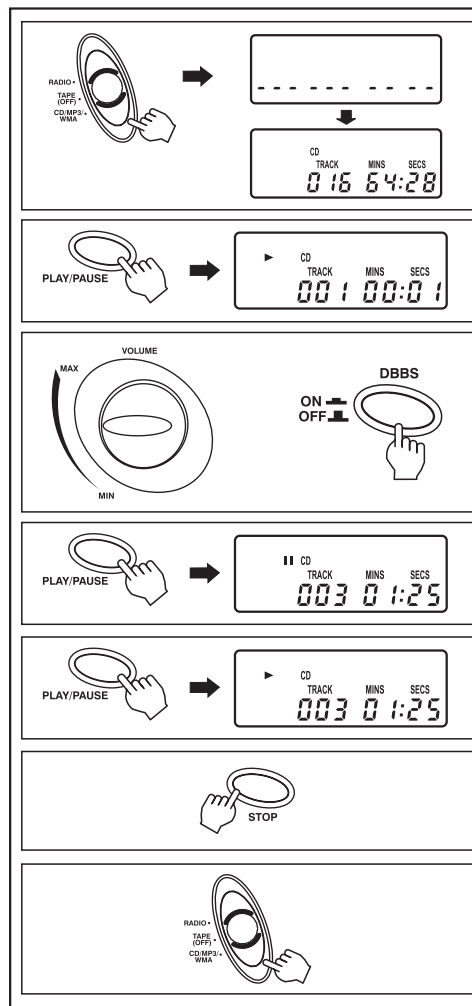

TRACKS SKIPPING

Press the BACK and FWD SEARCH buttons during play to skip to the desired track.

1. Press the ►► button to skip to the next track on the disc.
2. Press the ◄◄ button once to skip to the beginning of the track currently playing.
3. Press the ◄◄ button twice or more to skip to previous tracks.

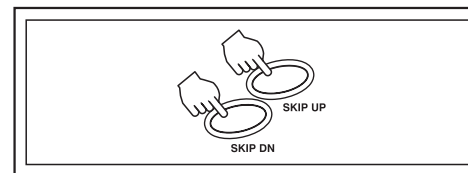

FORWARD/REVERSE SEARCH

Press and hold the BACK or FWD SEARCH buttons during play to scan the disc at high speed. When the desired section of the disc is found, release the button. Normal play will resume.

►► FWDFORWARD
◄◄ BACK.....REVERSE

1. Press and hold the FWD button while playing to scan the disc forward from the current played track at high speed.
2. Press and hold the BACK button while playing to scan the disc backward from the current played track at high speed.
3. During disc playback, press ALBUM/10+ button once to skip to the track 10 tracks ahead of the current track, twice to the track 20 tracks ahead etc.

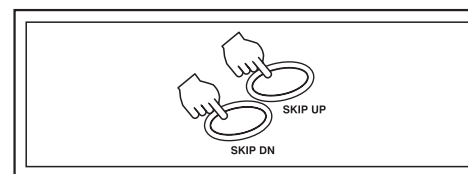

PROGRAMMED PLAYBACK

The tracks on the disc can be programmed for playback in any order (Up to 99 tracks can be programmed).

1. Press the PROG button in stop mode, "PROG" and program number "P-01" are shown in the display.
2. Press the BACK or FWD SKIP/SEARCH button to select the first track to be programmed.
3. Press the PROG button. The first track number is now stored into memory, program number changes to "P-02" waiting for the next track to be entered.
4. Repeat steps 2 and 3 to program additional tracks.
5. After programming is finished, press the PLAY/PAUSE button.
 - Programmed play begins from the first programmed track.
 - The player stops automatically after all programmed tracks have been played. To play the same programmed tracks again, press the PLAY/PAUSE button.
 - In stop mode, press the STOP button once, "PROG" disappears from the display and the programmed tracks in the memory will be cleared. The memory will also be cleared if the disc compartment is opened, or power is turned off.

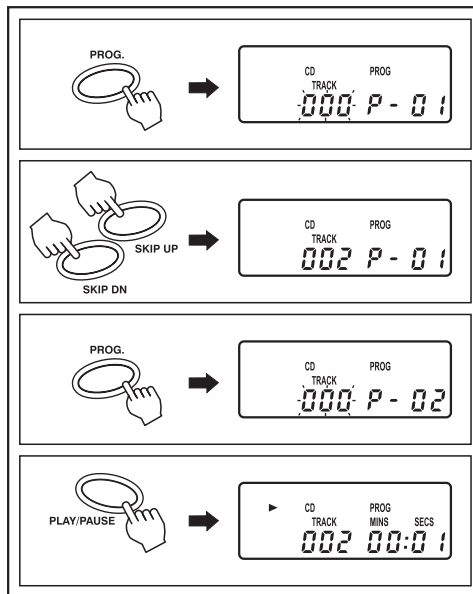

SINGLE TRACK REPEAT

Press the MODE button once during playback, "REPEAT ONE" appears in the display, press the BACK or FORWARD SKIP/SEARCH button to select the track to be repeated.

To cancel SINGLE TRACK REPEAT press the repeat button repeatedly until the REPEAT indicator is no longer shown in the display.

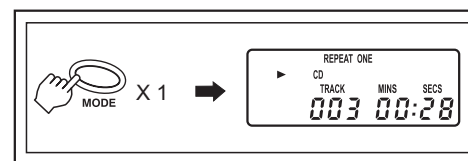

ALL TRACKS REPEAT

Press the MODE button twice during playback, "REPEAT ALL" shows in the display.

To cancel ALL TRACKS REPEAT press the REPEAT button repeatedly until the REPEAT indicator is no longer shown in the display.

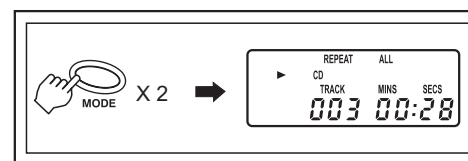

INTRO SCAN PLAY

1. Press the MODE button three times during playback.
2. "INTRO" shows in the display. Playback begins immediately from the first track and will play the first 10 seconds of each track. To cancel press the mode button repeatedly until the INTRO indicator is no longer shown in the display.

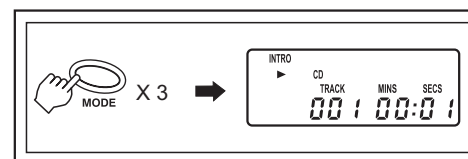

RANDOM PLAY

Press the MODE button four times during playback. "RDM" shows in the display, Playback begins immediately with tracks being selected randomly. To cancel press the MODE button repeatedly until the RDM indicator is no longer shown in the display.

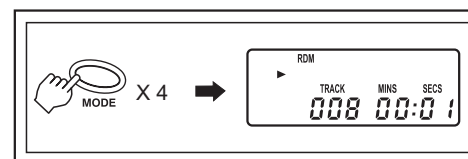

8. MP3/WMA DISC SECTION

TRACK SKIPPING

- Press FORWARD SKIP/ SEARCH button (or BACKWARD SKIP/SEARCH button) to select the tracks you require, the operations are identical to the operations when listening to a normal audio CD.
- During disc playback, press ALBUM/10+ button once to skip to the track 10 tracks ahead of the current track, twice to the track 20 tracks ahead etc.
- During playback press and hold the ALBUM/10+ button, the album number advances, when the desired album is reached, release the button to begin playback of the first track of the selected album.

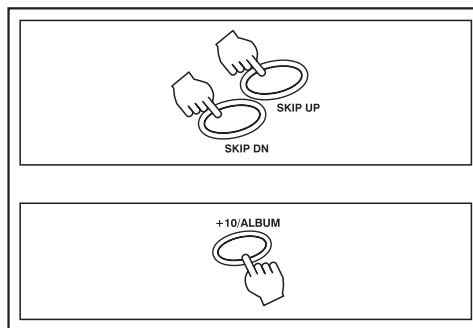

SINGLE TRACK REPEAT

During playback, press the MODE button once to repeat the current track, "REPEAT ONE" will be shown in the display. To cancel SINGLE TRACK REPEAT press the MODE button repeatedly until REPEAT is no longer shown on the display.

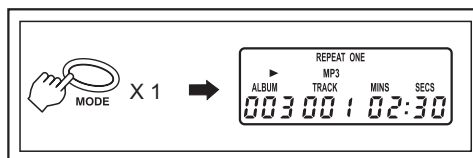

ALBUM REPEAT

During playback, press the MODE button once to repeat the current track, "REPEAT ALBUM" will be shown in the display. To cancel ALBUM REPEAT press the MODE button repeatedly until REPEAT is no longer shown on the display.

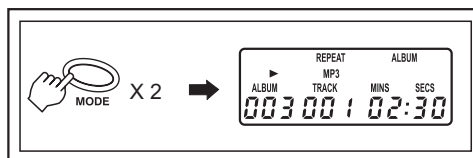

DISC REPEAT

During playback, press the MODE button once to repeat the current track, "REPEAT ALL" will be shown in the display. To cancel DISC REPEAT press the MODE button repeatedly until REPEAT is no longer shown on the display.

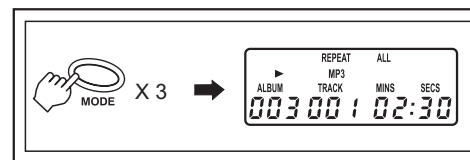

INTRO SCAN PLAY

1. Press the MODE button four times during playback.
2. "INTRO" shows in the display. Playback begins immediately from the first track and will play the first 10 seconds of each track. To cancel INTRO SCAN press the MODE button repeatedly until INTRO is no longer shown in the display

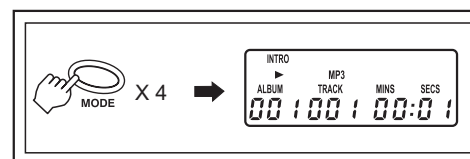

RANDOM PLAY

Press the MODE button five times in playing mode. "RDM" shows in the display, Playback begins immediately with tracks being selected randomly.

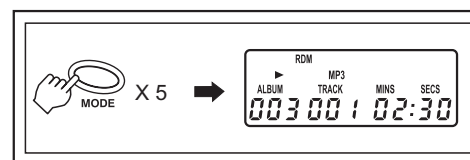

PROGRAM PLAY

NOTE: Up to 99 tracks can be stored in memory. Programming can only be completed when the disc is stopped.

The tracks on the disc can be programmed for play in any order (Up to 99 tracks can be programmed).

1. Press the PROG button when the disc is stopped, "PROG" and program number "P-01" are shown in the display.
2. Press and hold the ALBUM/10+ button to select the desired album
3. Press the BACK or FWD SKIP/SEARCH button to select the first track to be programmed.
4. Press the PROG button. The first track number is now stored into memory, program number changes to "P-02" waiting for the next track.
5. Repeat steps 2, 3 and 4 to program additional tracks.
6. After programming is finished, press the PLAY/PAUSE button. Programmed play begins from the first programmed track. The player stops automatically after all programmed tracks have been played. To play the same programmed tracks again, press the PLAY/PAUSE button. In stop mode, press the STOP button once, "PROG" disappears from the display and the programmed tracks in the memory will be cleared. The memory will also be cleared if the disc compartment is opened, or power is turned off.

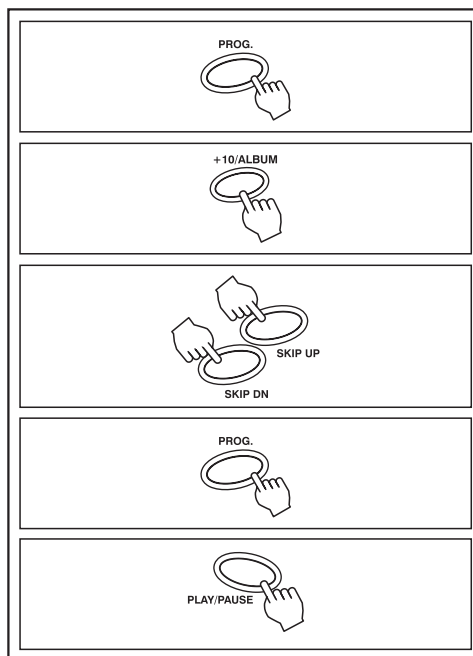

9. CASSETTE OPERATION

RECORD

Press the RECORD key to make a recording from CD, RADIO or the Internal Microphone.

Note: If a recordable cassette is inserted when the RECORD button is pressed, the PLAY button will be depressed at the same time. The record key will not go down if the cassette is protected; see "Protecting recordings from being erased."

PLAY button

Press the PLAY button to start playing a cassette.

REWIND button

Press the REWIND button to quickly rewind a tape. Press STOP/EJECT to release the button at the end of the tape.

FF button

Press the FAST FORWARD button to quickly advance the tape. Press STOP/EJECT to release the button at the end of the tape.

STOP/EJECT button

Press the STOP/EJECT button to stop playback, recording, rewinding or Fast forwarding. In stop mode press the button to eject the cassette.

PAUSE

Press the PAUSE button to pause playback or recording. To resume press the button again.

Note: In Pause mode the cassette motor is still engaged and therefore to prevent damage tapes should not be left paused for a long period of time.

AUTOMATIC STOP

The Cassette mechanism has a built-in automatic stop. During Playing/Recording, the unit will automatically stop when the end of the tape is detected.

TO PLAY A CASSETTE TAPE

1. Open the cassette door by pressing the cassette STOP/EJECT button.
2. Insert a cassette with the exposed tape facing upwards and the full reel on the right (unit plays from right to left) into the tracks on the inside of the cassette door.
3. Close the cassette door.
4. Set the function switch to the TAPE position.
5. Press the cassette PLAY button to start the tape playing.
6. Adjust the VOLUME CONTROL to a comfortable listening level.
7. To stop the tape playing, press the STOP/EJECT button. Press the button again to open the cassette door and eject the tape.

Note: During playback, when the end of the tape is reached the PLAY button will pop up and play will stop. To play the other side of the tape, remove the cassette, turn the cassette over so that the full reel is on the right, replace the cassette and press the PLAY button.

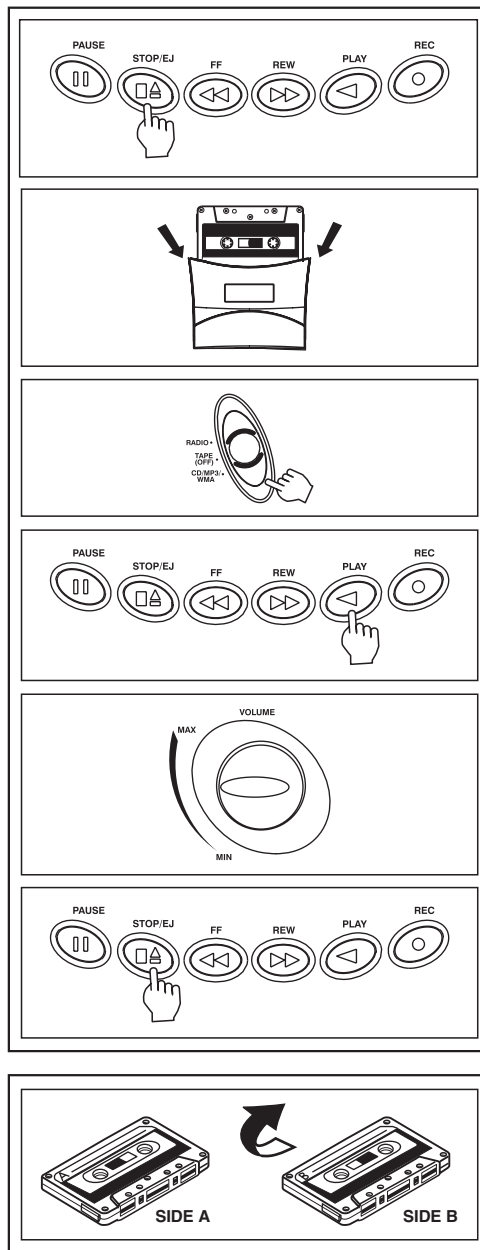

10. CARE OF CASSETTE TAPES

TO HELP AVOID TANGLES

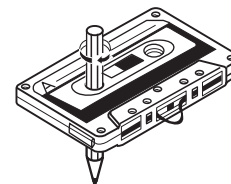

Loose tape may jam or get tangled in the cassette recorder. With a hexagonal pencil or a similar tool, gently turn the pencil to tighten the tape, as shown opposite.

If the spool feels tight when taking up slack tape as described above, this may be due to ridges on the spool of tape. Tight spools can lead to uneven playback speed or tape tangling. In most cases the ridges can be removed by fast winding the cassette from one end to the other and back again.

Avoid the use of C120 tapes with this unit.

PROTECTING RECORDINGS FROM BEING ERASED.

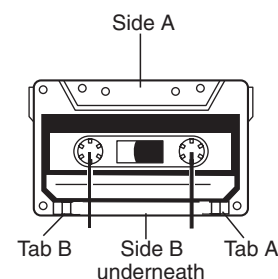

To prevent recordings from being erased accidentally, break out the tab(s) with a screwdriver. When the edge with the exposed tape is facing away from you, the tab that protects the side that is uppermost is on your right, as shown opposite.



To record on a protected cassette, seal the open slots with adhesive tape.

11. TO RECORD FROM THE BUILT-IN RADIO

1. Slide the FUNCTION switch to the RADIO position and tune to the desired station.
2. Load a cassette into the cassette compartment, with the full reel on the right.
3. Press the cassette RECORD button until it locks in the down position (PLAY button is depressed at the same time) and recording will start.
4. To end the recording press the cassette STOP/EJECT button. If this button is not pressed the recording will stop automatically when the end of the tape is reached.
5. To listen to your recording, move the FUNCTION switch to the TAPE position, press the cassette REWIND button until the start point of the recording is reached and then press the PLAY button. Use the VOLUME control to adjust the playback level to your personal taste.

Note: On each end of the tape there is a tape leader and no recording will take place over this portion of the tape. If you wish recording to take place as soon as the RECORD button is pressed, please ensure that the leader is wound past the record head.

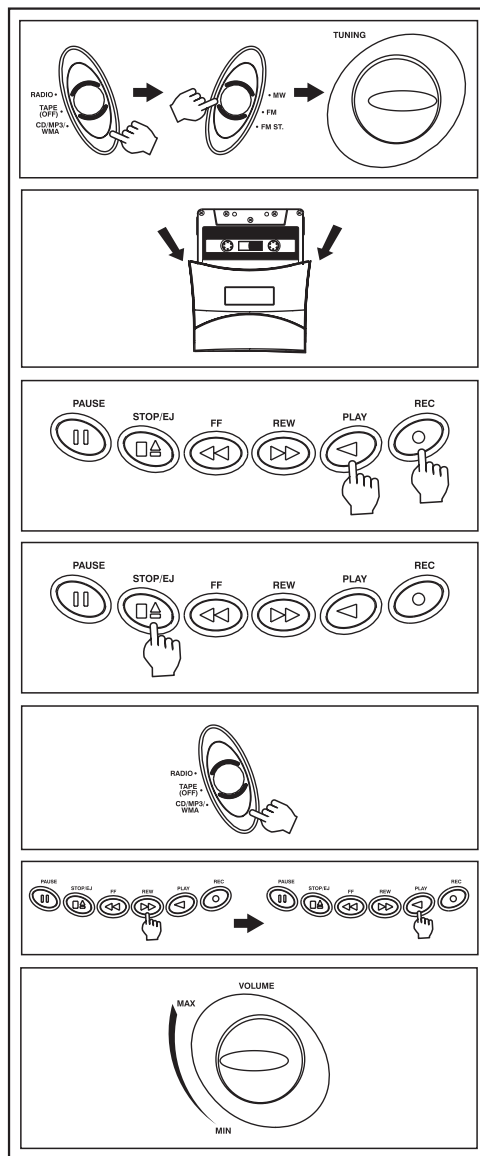

12. TO RECORD FROM WMA/MP3/CD

1. Slide the FUNCTION switch to the CD (MP3) position.
2. Load a cassette into the cassette compartment with the full reel on the right.
3. Insert the compact disc to be recorded from and close the CD door.
4. Press the cassette PAUSE button on the tape deck.
5. Press the cassette RECORD and PLAY buttons so they lock in the down position. (The unit is now in recording standby mode)
6. Start the CD playing by pressing the CD PLAY/PAUSE button.
7. Press the cassette PAUSE button again and then recording begins.
8. To end the recording, press the cassette STOP/EJECT button.
9. Press the CD STOP button and then move the FUNCTION switch to the TAPE position.
10. To listen to your recording, press the REWIND button to return to the point where the recording started and then press the PLAY button.

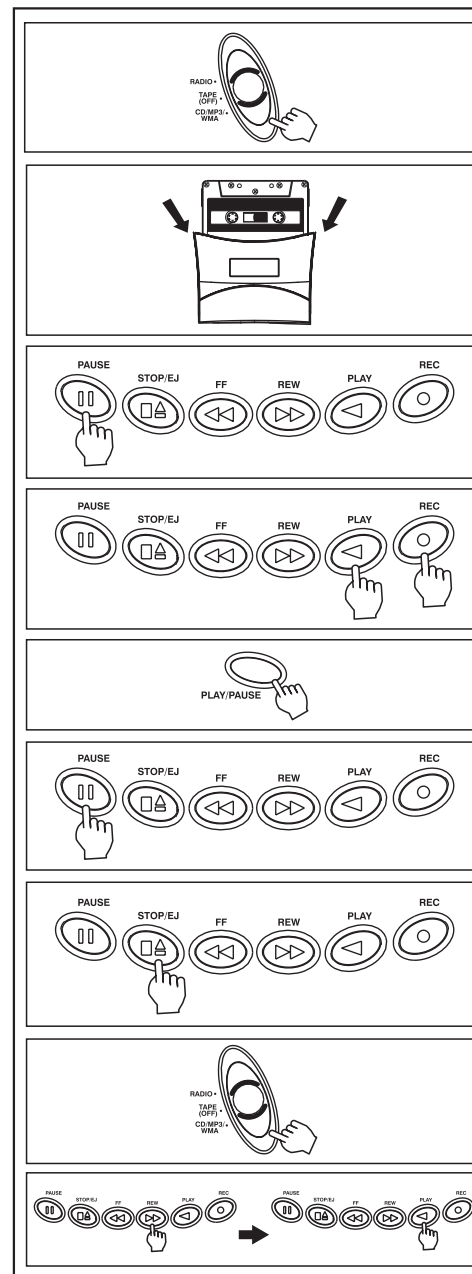

13. TO RECORD FROM THE BUILT-IN MICROPHONE

1. Set the FUNCTION Switch to the TAPE position.
2. Load the cassette which you wish to record on into the tracks on the cassette door. (Full reel on the right hand side).
3. Press the cassette RECORD button and speak into the built-in microphone.
4. Press the STOP/EJECT button to end the recording.
5. Rewind the tape and then press the PLAY button to listen to your recording.

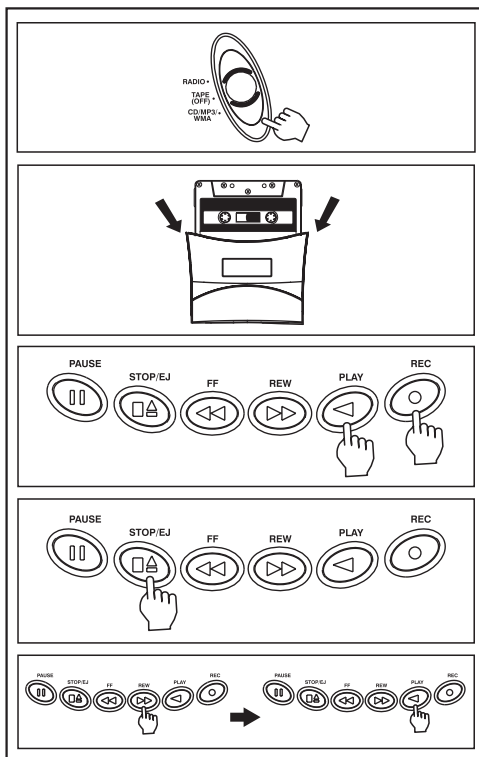

14. LISTENING WITH HEADPHONE/EARPHONE (NOT SUPPLIED)

For private listening without disturbing others, you may enjoy the music with headphone/earphone, set the Volume Control to minimum level, plug the headphone/earphone into Phones socket, adjust the Volume Control to your listening preference. When the headphone is plugged into, the set's speakers will automatically turn off.

CAUTION: Listening at high power for a long periods could damage your hearing.

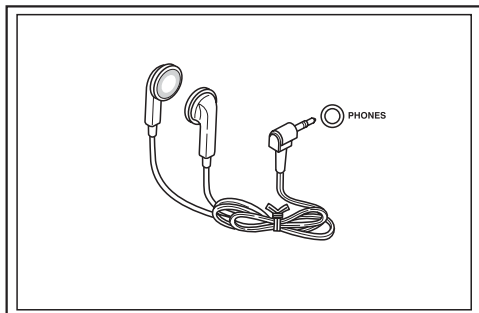

15. PRODUCT SPECIFICATIONS

PICK-UP

System	Compact disc digital audio system
Laser diode	material: GaAlAs
Properties	Wavelength: 780nm Emission duration: continuous Laser output level 44.6uW
Error correction	Cross-interleave Reed-solomon code

AUDIO

D/A conversion	1-bit DAC 8 times oversampling
Frequency response	20-20,000Hz (+1/-3 dB)
Wow and flutter	Below measurable limits
No. of channels	2 channels (stereo)
Output level of earphones	20mW * 2
Main speakers	3W/8 Ohms * 2

RADIO

Receiving bands	MW/FM
Frequency range	MW 540 - 1600 KHz/1000μV/m FM 88 - 108 MHz/30μV

GENERAL

Power requirements	AC 230V/50Hz
Power consumption	16W
Dimension	Approx. 344 (L) x 237.5 (W) x 136 (H) mm
Weight	Approx. 2.3kg(Without batteries)

Please note: Due to the continual improvement of our products, specifications are subject to change without notice.