

Goodmans

STEREO RADIO CASSETTE RECORDER COMPACT DISC PLAYER GPS214PLLR

Instruction Manual

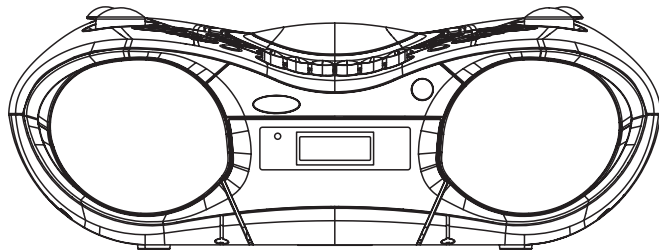

SPECIFICATIONS

| | |
|-------------------------|--|
| Programme Play | Up to 20 tracks |
| Earphone output | 20mW x 2 (32 Ω) |
| Power requirement | AC 230V/50Hz |
| Dimension | Approx. 446.5(L)X240.5(W)X163.0(W) mm |
| Weight | Approx. 3.20Kg (not including batteries) |

For improvement purposes, specification and design are subject to change without notice.

IMPORTANT SAFEGUARDS

PRE FITTED MAINS PLUGS

For your convenience a mains plug has been fitted to this appliance. For your safety please observe the following information.

1. Should the fuse in the plug remove the plug from the wall socket and replace the fuse with a 3 Amp ASTA approved to BS 1362 fuse.
2. Never use the plug without the fuse cover fitted. Replacement fuse covers are available from your dealer or most electrical retail outlets.
3. If the mains plug is cut off the cable, rewire the replacement plug in accordance with instruction given in this manual.
4. CAUTION: Under no circumstances should the discarded plug be inserted mains socket. To prevent a shock hazard carefully dispose of the discarded plug. Do not leave the plug lying around where children might see it.

WARNING: To prevent fire or shock hazard do not expose this unit to rain or moisture.

CAUTION: DANGEROUS VOLTAGES EXIST INSIDE THIS UNIT, DO NOT REMOVE COVER (OR BACK). NO USER SERVICEABLE PARTS INSIDE. REFER SERVICING TO QUALIFIED SERVICE PERSONNEL. DISCONNECT FROM MAINS SUPPLY WHEN NOT IN USE.

PLUG WIRING DETAILS

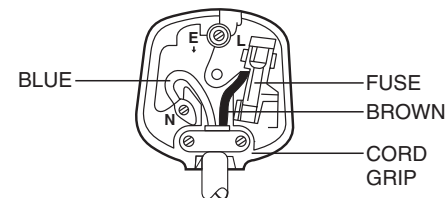

The wires in this mains lead are coloured in accordance with the following wiring codes:

Blue..... Neutral
Brown..... Live

The wires in this mains lead must be connected to the terminals in the plugs as follows:

Blue Wire..... N or Black
Brown Wire..... L or Red

Only a 3 Amp fuse should be fitted in the plug or a 5 Amp fuse at the distribution board.

WARNING: UNDER NO CIRCUMSTANCES MUST THE LIVE OR NEUTRAL WIRES BE CONNECTED TO THE EARTH TERMINAL IN A 3-PIN MAINS PLUG.



This symbol means that this unit is double insulated.
An earth connection is not required.

CAUTION

CLASS 1 LASER PRODUCT

Use of Controls or adjustments or performance of procedures other than those specified herein may result in hazardous radiation exposure.

LASER SAFETY

This unit employs a laser, only qualified service personnel should attempt repair.

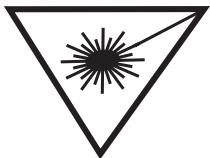

DANGER: INVISIBLE LASER RADIATION WHEN OPEN AND INTERLOCK FAILED OR DEFEATED. AVOID DIRECT EXPOSURE TO BEAM.

CAUTION: HAZARDOUS LASER RADIATION WHEN OPEN AND INTERLOCK DEFEATED.

CAUTION

CLEANING: Always disconnect unit from mains supply before attempting to clean it. Use soft cloth moistened with soapy water, wipe gently. Do not use solvents or abrasive materials.

SOME DO'S AND DONT'S ON THE SAFE USE OF EQUIPMENT

This equipment has been designed and manufactured to meet European safety standards but like any electrical equipment, care must be taken if you are to obtain the best results and safety is to be assured.

Do read the operating instructions before you attempt to use the equipment.

Do ensure that all electrical connections (Including the mains plug, extension leads and interconnections between pieces of equipment) are properly made in accordance with the manufacturer's instructions. Switch off and withdraw the mains plug when making or changing connections.

Do consult your dealer if you are ever in doubt of the installation, operating, or safety of your equipment.

Don't continue to operate the equipment if you are in any doubt about it working normally, or if it is damaged in any way - switch off, withdraw the mains plug and consult your dealer.

Don't remove any fixed covers as this may expose dangerous voltages.

Don't leave equipment switched on when it is unattended unless it is specifically stated that it is designed for unattended operation or has a standby mode. Switch off using the switch on the equipment and make sure that your family knows how to do this. Special arrangements may need to be made for infirm or handicapped people.

Don't listen to headphones at high volume, as such use can permanently damage your hearing.

Don't obstruct the ventilation of the equipment, for example with curtains or soft furnishings. Overheating will cause damage and shorten the life of the equipment.

Don't allow electrical equipment to be exposed to rain or moisture.

Above all

- Never let anyone, especially children, push anything into holes, slots or any other opening as this could result in a fatal electric shock.
- Never guess or take chances with electrical equipment of any kind.
- It is better to be safe than sorry!

WARNING: TO REDUCE THE RISK OF FIRE OR ELECTRIC SHOCK, DO NOT EXPOSE THIS APPLIANCE TO RAIN OR MOISTURE, DANGEROUS HIGH VOLTAGES ARE PRESENT INSIDE THE ENCLOSURE, DO NOT OPEN THE CABINET, REFER SERVICING TO QUALIFIED PERSONNEL ONLY.

IMPORTANT NOTES

Your hearing is very important to you and to us so please take care when operating this equipment. The following guidelines are provided for your information.

ESTABLISH A SAFE SOUND LEVEL

- Over time your hearing will adapt to continuous loud sounds and will give the impression that the volume has in fact been reduced. What seems normal to you may in fact be harmful. To guard against this **BEFORE YOUR HEARING ADAPTS** set the volume at a low level.
- Slowly increase the level until you can hear comfortably and clearly and without distortion.
- Damage to your hearing is accumulative and is irreversible.
- Any ringing or discomfort in the ears indicates that the volume is too loud.
- Remember listening for prolonged period of time at high volume levels will harm your hearing.

Once you have established a comfortable listening level, DO NOT INCREASE THE SOUND LEVEL FURTHER.

The following list of typical sound levels may assist you in recognizing just how loud you have set the volume level.

DECIBEL

| <u>Level dB</u> | <u>Example</u> |
|-----------------|--|
| 30dB | Quiet library, soft whisper. |
| 40 | Living room, fridge freezer bedroom away from traffic. |
| 50 | Normal conversation, quiet office, light traffic. |
| 60 | Electric sewing machine. |
| 70 | Vacuum cleaner, hair dryer, noisy restaurant. |

THE FOLLOWING NOISE CAN BE HARMFUL UNDER CONSTANT EXPOSURE

| | |
|------|--|
| 80dB | Average city traffic, alarm clock buzzer at 1 Metre, food mixer. |
| 90 | Motorcycle, heavy goods vehicle, petrol lawn mower. |
| 100 | Pneumatic drill, chain saw, garbage truck, discotec/night-club. |
| 120 | Rock band concert, thunderclap, fast train passing by. |
| 140 | THRESHOLD OF PAIN Gunshot, jet plane taking off. |
| 180 | Rocket Launching pad. |

TABLE OF CONTENTS

| | |
|-----------------------------------|---|
| Power Sources | 1 |
| Player Maintenance..... | 2 |
| Disc Cleaning, Power failure..... | 3 |

Player Operation

| | |
|----------------------------------|----|
| Location of Controls..... | 4 |
| Radio operation..... | 5 |
| Listening to a compact disc..... | 6 |
| Program play operation..... | 7 |
| Repeat play operation..... | 8 |
| Random play operation..... | 9 |
| Cassettes..... | 10 |
| Recording from Radio/MIC/CD..... | 11 |
| Remote Control..... | 12 |
| Product Specifications..... | 13 |

WARNING

To prevent fire or shock hazard, do not expose the unit to rain or moisture.

To avoid electrical shock, do not open the cabinet. Refer servicing to qualified personnel only.

SAFETY PRECAUTIONS

1. As the laser beam used in this compact disc player is harmful to the eyes, do not attempt to disassemble the casing.
2. Stop operation immediately if any liquid or solid object should fall into the cabinet. Unplug the unit and have it checked by qualified personnel.
3. Do not touch the lens or poke at it. If you do, you may damage the lens and the player may not operate properly.
4. Do not put anything in the safety slot. If you do, the laser diode will be ON when the lid is still opened.
5. This unit employs a laser. The use of controls or adjustments or performance of procedures other than those specified herein may result in exposure to hazardous radiation.

1. POWER SOURCES

AC MAINS OPERATION

1. Remove the AC cord which is packed inside the box.
2. Connect the cord to the AC input socket.
3. Connect the 3 pin mains plug to an AC mains socket.

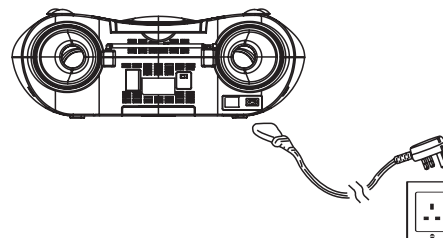

BATTERY OPERATION

1. Insert 8 LR14 (C Size) batteries (not supplied) into the battery compartment observing the correct polarity as indicated.
2. Ensure compartment cover is securely fitted.
3. Product will only function from batteries once AC cord is removed from the unit.
4. When replacing flat batteries, ensure all batteries are replaced at the same time with the same type.
5. If the product is not to be used for an extended period of time the batteries should be removed to prevent any possible damage to the product.

2. PLAYER MAINTENANCE

CASSETTE DECK MAINTENANCE

When the heads, capstan and pinch roller become dirty, this may result in muffled, distorted or reduced sound during play back and may even result in tape jams. Clean the tape head with a head cleaning tape.

CLEANING THE LENS

If the lens in the CD pick-up is dirty, dusty, etc, it could degrade the sound or prevent disc play. Open the disc holder and clean the lens as shown.

- Use a blower (available from camera stores) to blow dust off the lens.
- If there are fingerprints, etc., on the lens, gently wipe clean with a cotton swab.

3. DISC CLEANING, POWER FAILURE

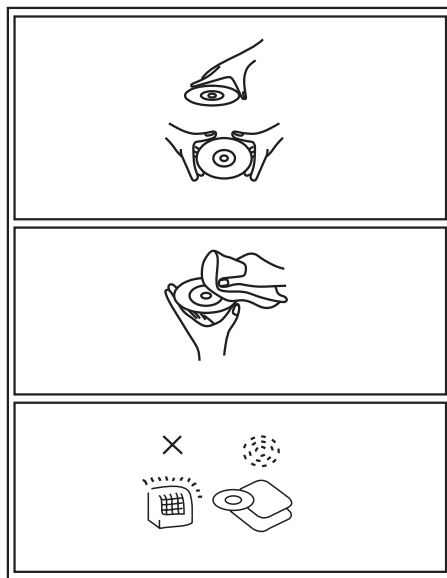

Cleaning the Disc

1. To handle a disc use only one of the two methods illustrated.

NOTE: Do not touch the rainbow-colored side.

2. To wipe a disc, use only a soft cloth. Do not use petroleum products or thinner which will damage the disc. The disc should always be wiped in a straight line from the center to the edge. It should never be wiped in a circular motion.

3. Never place the disc on other equipment or near any heat source. Avoid positions where the disc would be subjected to direct sunlight for long periods.

Maintenance and care

1. Electronic products should never be subjected to extreme temperatures nor high humidity to ensure good performance and a long life-time. The player should not be placed in bathing areas, or around stoves and radiators, etc. Always leave sufficient space around the unit for ventilation.
2. If necessary, only clean the cabinet of the unit with a soft dampened piece of cloth. (be sure the AC power cord is unplugged from the outlet) Never use a polish or a strong detergent for cleaning since this can damage the finish of the cabinet.

4. LOCATION OF CONTROLS

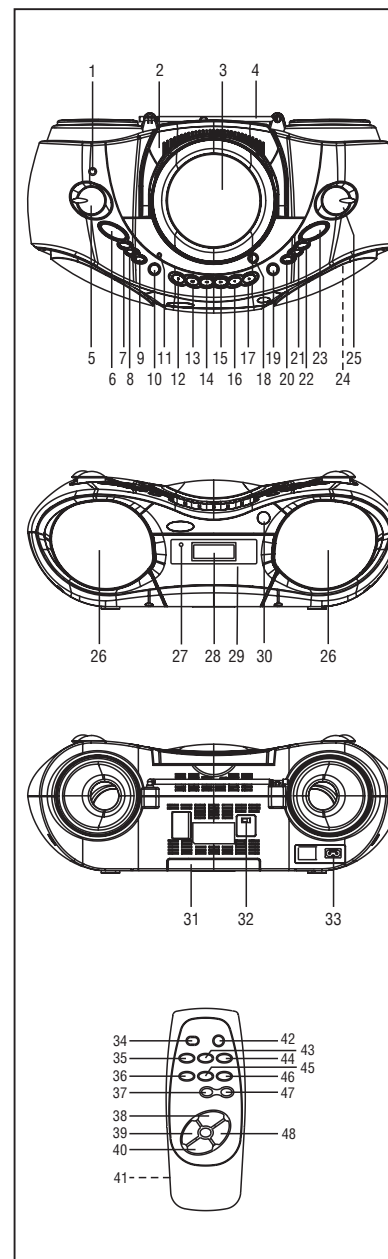

LOCATION OF CONTROLS

1. HEADPHONES SOCKET
2. FOLDING HANDLE
3. CD DOOR
4. FM TELESCOPIC AERIAL
5. VOLUME CONTROL
6. POWER BUTTON
7. CD BUTTON
8. TAPE BUTTON
9. RADIO BUTTON
10. BASS BOOST BUTTON
11. DBBS INDICATOR
12. CASSETTE PAUSE BUTTON
13. CASSETTE STOP/EJECT BUTTON
14. CASSETTE FAST FORWARD BUTTON
15. CASSETTE REWIND BUTTON
16. CASSETTE PLAY BUTTON
17. CASSETTE RECORD BUTTON
18. CD DOOR OPEN BUTTON
19. CD RANDOM/RADIO BAND BUTTON
20. CD PROGRAM/RADIO STATION STORE BUTTON
21. CD REPEAT/RADIO PRESET BUTTON
22. CD STOP BUTTON
23. CD PLAY/PAUSE BUTTON
24. BUILT-IN CONDENSER MIC
25. CD FORWARD/BACKWARD SKIP/SEARCH / RADIO TUNING UP/DOWN CONTROL(▶▶|◀◀)
26. SPEAKERS
27. STANDBY INDICATOR
28. LCD DISPLAY
29. CASSETTE DOOR
30. REMOTE SENSOR
31. BATTERY COMPARTMENT DOOR
32. FM STEREO/MONO SELECTOR
33. AC SOCKET

REMOTE CONTROL

34. MUTE BUTTON
35. CD BUTTON
36. CD PROGRAM/RADIO STATION STORE BUTTON
37. VOLUME DOWN BUTTON
38. CD PLAY/PAUSE BUTTON
39. CD BACKWARD SKIP/SEARCH / RADIO TUNING DOWN BUTTON
40. CD STOP BUTTON
41. BATTERY COMPARTMENT
42. POWER BUTTON
43. RADIO BUTTON
44. BAND BUTTON
45. CD REPEAT/RADIO PRESET BUTTON
46. TAPE BUTTON
47. VOLUME UP BUTTON
48. CD FORWARD SKIP/SEARCH / RADIO TUNING UP BUTTON

5. RADIO OPERATION

1. Press the Radio button after the power button has been pressed.
2. Press the Radio Band Button to select the desired wave band.
3. Tune to desired station by giving force on the Radio Tuning & Search Down or Up control.
4. To search for a station quickly (automatic tuning), hold the Tuning Down or Up control until the frequency value starts to change rapidly, then release your finger and the unit will stop search at the next receivable station.
5. When listening to an FM station in stereo, and there is a large amount of hiss, slide the FM Mono/Stereo selector switch to the Mono position.
6. Adjust the Volume Control to your listening preference.
7. To turn off the radio, press the power button to set the unit to the Standby mode.

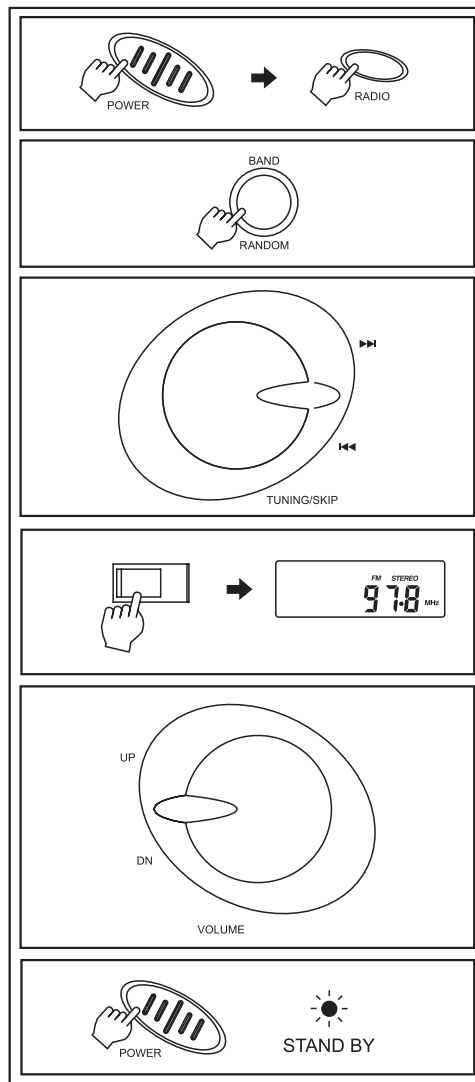

PRESETTING STATIONS

UP TO 10 FM AND 10 MW STATIONS CAN BE STORED INTO THE PRESET MEMORIES. (THEY WILL REMAIN IN MEMORY AS LONG AS THE BATTERIES ARE INSTALLED, OR AC POWER CORD IS CONNECTED.)

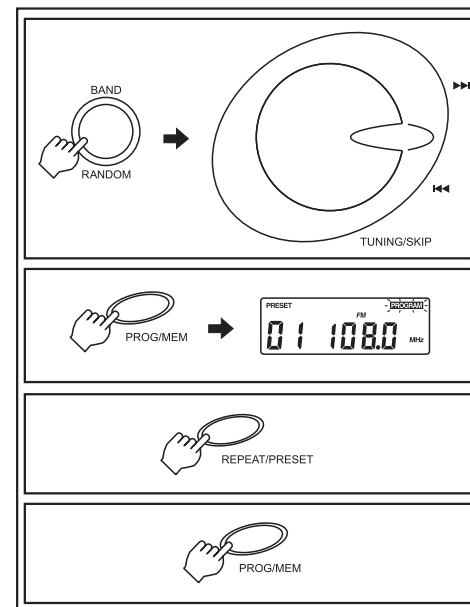

1. Press the Radio Band Button to select MW or FM band, and use the Radio Tuning & Search Down or Up control to search for a station.
2. Press the Program/Store Button, "PROGRAM" will flash in the display.
3. While the "PROGRAM" is flashing, Press the Radio Preset Button to choose a memory position (FM :01- 10 or MW: 01- 10). (Example: Press this button 3 times, and the Number 3 Preset station will be selected.)
4. Press the Program/Store Button again to confirm. The station is stored into that preset memory position.
NOTE: Steps 2-4 should be done within 5 seconds or the display will time out.
5. Repeat steps 1 to 4 to store other stations in memory.
6. Each memory position can store 2 stations, one for an MW, the other for FM.

TO LISTEN TO PRESET MEMORY STATIONS (after you programmed them)

1. Press the Radio button to select the radio.
2. Press the Radio Band Button to select your desired wave band.
3. Press the Radio Preset Button repeatedly to select the required station (FM :01-10 or AM: 01-10). (Example: Press this button 3 times to select the Number 3 Preset station, and so on).
4. To turn off the radio, press the Power button to set the unit to Standby.

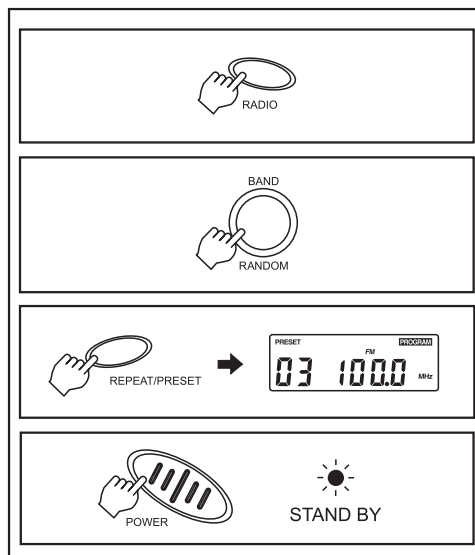

6. LISTENING TO A COMPACT DISC

PLAYING A COMPACT DISC

This set is designed to play only compact discs bearing this  identification logo (logo must say DIGITAL AUDIO).

1. Press the Power button to turn on the unit and then press the CD button.
2. Press the CD Door Open button to open the CD Door.
3. Insert a CD with the LABEL side facing UP, close the CD Door by gently pushing it down.
4. The display will show 2 zeros "00", and after the disc has been read the total number of tracks (songs) and the total play time of the disc. (If the disc is upside down or damaged, the Display will show 2 zeros "00", and then "no disc" will be shown).

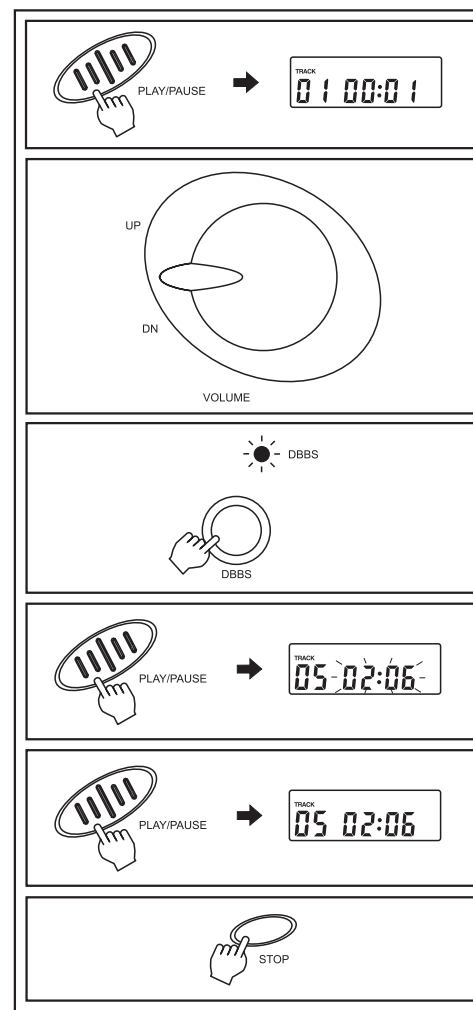
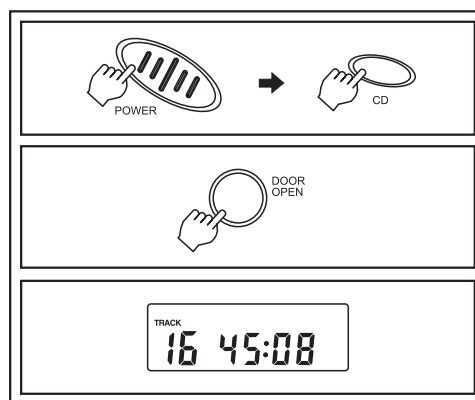

5. To start the music, press the CD Play/Pause Button. The first track number "01" will appear in the Display, and the disc will start playing. The elapsed time will be shown in the display also.
6. Adjust the Volume Control to your taste. For extra bass press the Bass Boost Button.
7. To pause playback, press the Play/Pause Button, the elapsed time will flash to remind you that you are in pause mode.
8. To resume playback, press the Play/Pause Button again. The elapsed time will be steady on (not flashing).
9. To stop playback, press the CD Stop Button.

SKIPPING TRACKS (SEARCH)

1. This function enables you to pinpoint the beginning of any intended track during playback. If the CD Search/Skip control is twisted anti-clockwise once or repeatedly, the NEXT TRACK or one of the subsequent tracks will be selected. The Display will show the track number.
2. If the CD Search/Skip control is twisted clockwise twice or more in rapid succession, a previous track can be selected.
3. When the set is in the pause mode, it is also possible to select the beginning of a certain track by using the CD Search/Skip control to select the intended track. After the selection, press Play.
4. Twist and hold the CD Search/Skip control to search forward or backwards at high speed to search for a section of a track. When the section is found release the control and normal playback will resume.

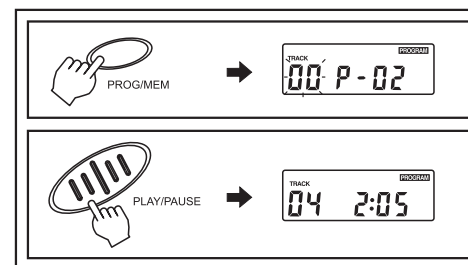
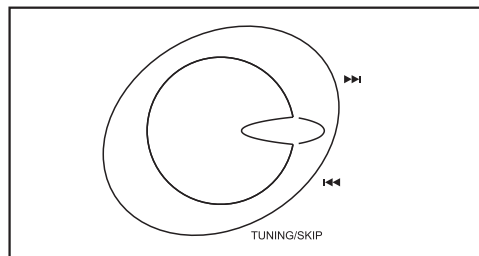

4. Press the Program Button. The Display will show "00 P-02".
5. Repeat steps 3 and 4 until all the desired tracks are programmed.
6. When you finished programming, press the CD Play/Pause Button.
7. All songs will be played in the order you programmed.
8. The Display will show the track number being played, and the "PROGRAM" indicator will show (but not flashing) in the display during programmed play.
9. When all the songs have finished playing, the set will stop. "PROGRAM" disappears from the display.

NOTE: Programming can only be done when the CD is in the stop mode.

NOTE: The programmed memory will be cleared if the CD power is turned off.

8. REPEAT PLAY OPERATION

7. PROGRAM PLAY OPERATION

PROGRAMMED (MEMORY) PLAYBACK (up to 20 tracks can be programmed)

1. When the CD is stopped, press the Program Button.
2. The Display will show "00 P-01" and "PROGRAM".
3. Use the Skip/Search control until the desired track shows in the display.

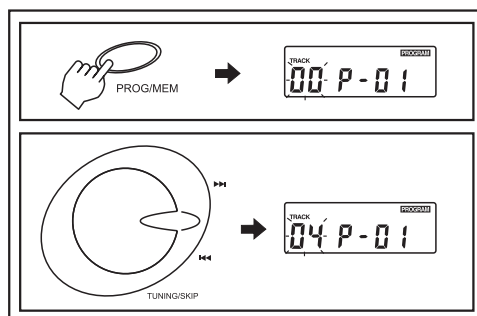

REPEAT ONE TRACK

To repeat the SAME track over and over again, do the following:

1. Press the Repeat Button once during playback or in stop mode.
2. The "REPEAT" icon will flash in the display. The song currently playing will play over and over, till you press Stop.
3. To stop the repeat function, press the Repeat Button twice until the "REPEAT" icon clears from the display.

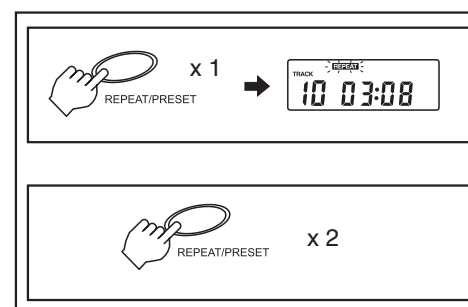

REPEAT ALL TRACKS

To repeat ALL TRACKS on a disc and play them again and again.

1. Press the Repeat Button twice during playback .
2. The " **REPEAT** " icon will show steadily (not flashing) in the display. All the songs on the CD will be played in order and then start all over again.
3. To stop the repeat function, press the Repeat Button once until the " **REPEAT** " icon removed from the display.

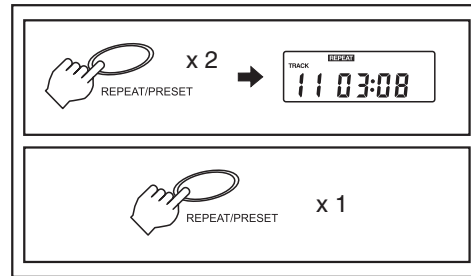

9. RANDOM PLAY OPERATION

Press the CD Random button in CD stop mode or during CD playback.

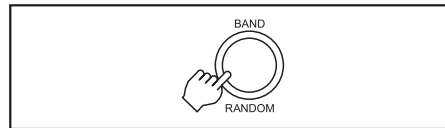

10. CASSETTES

CASSETTE TAPE SELECTION

The quality and condition of the cassette tapes you use will have a direct effect on the performance of this set.

Low quality tapes tend to break and stretch and a broken tape can easily become entangled in the drive mechanism, causing major damage. Stretched tapes will run at uneven speeds and will distort anything recorded on them.

- Use only well-known brands of tapes.
- Use of C-120 (120 minutes) cassette is not recommended. The extreme thinness of this tape may result in breakage or other failures.
- This set is not designed for CrO₂, Fe-Cr or METAL tape use. Therefore, be sure to use named brand normal cassette tapes.

TO PLAY A CASSETTE TAPE

1. Open the Cassette Door by pressing the Cassette Stop/Eject Button (in some cases, you may have to press the Cassette Stop/Eject Button twice since this button has combined functions).
 2. Insert cassette tape into deck door track. Make sure the full reel is on the right and the exposed part of the tape faces upward, make sure the tape inside is not slack or loosely wound. If it is, insert a pencil into the reel and turn until the tape is wound up.
 3. Close the Cassette Door.
 4. Press the Tape button after the Power button has been pressed.
 5. Press the Cassette Play Button.
- NOTE:** If the Play button pops up, reverse the tape or press Rewind.
6. Adjust the Volume Control to your listening preference.
 7. To stop the tape, press the Cassette Stop/Eject Button.
 8. To remove the cassette, press the Cassette Stop/Eject Button again and the Cassette Door will open.

Unload the cassette tape, reverse it and re-insert into cassette compartment if you want to play the other side of the cassette tape.

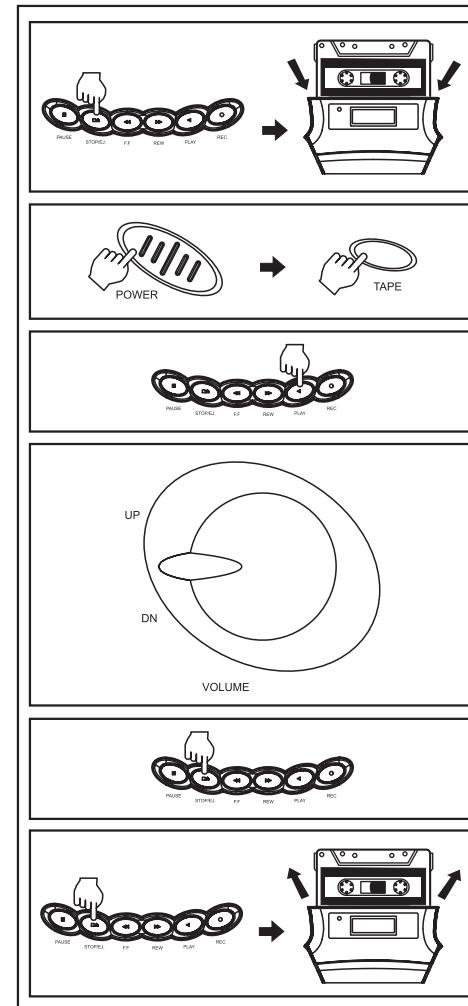

AUTOMATIC LEVEL CONTROL (ALC)

This product utilizes the latest Automatic Level Control circuitry, therefore, it is not necessary to adjust the Volume Control when recording. This circuit automatically records at the correct level and prevents over loading.

NOTE: While recording you may adjust the Volume Control as desired without affecting the recording operation.

11. RECORDING FROM RADIO/MICROPHONE/CD

RECORDING FROM RADIO

1. Follow the instructions to listen to the radio.
2. Press the RADIO button.
3. Load a blank cassette tape with full spool on right into the door.
4. Locate the portion of the tape where the recording is to begin by using the Rewind or Fast Forward buttons or start at the beginning of the tape.
5. Tune in to the station you want to record, press the Cassette Record Button and Cassette Play button simultaneously. Both buttons should remain in their depressed positions when released.
6. The recording process will automatically stop at the end of the tape and shut itself off.
7. To stop the recording manually, press the Cassette Stop/Eject Button.

NOTE: When you want to play the cassette tape after recording, press the TAPE button, press Cassette Rewind Button, and then press Cassette Play Button. Adjust the Volume Control to your taste.

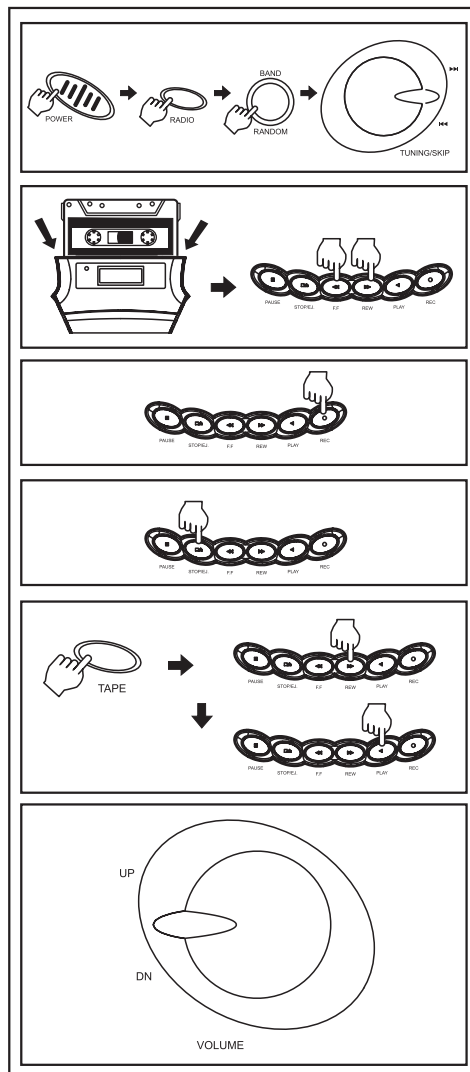

RECORDING FROM THE BUILT-IN MICROPHONE

1. Load a blank cassette tape into the Cassette door (full reel or spool on right side).
2. Press TAPE button.
3. Press the Cassette Record button and Cassette Play button at the same time. Both buttons should remain in their down positions when released.
4. When you talk in front of the set your voice will be recorded. You are now recording using the Built-in Condenser Microphone and the recording process will automatically stop at the end of the tape and shut itself off.
5. To stop the recording manually, press the Cassette Stop/Eject button.
6. To hear what you recorded, press the Cassette Rewind button and Cassette Play button.

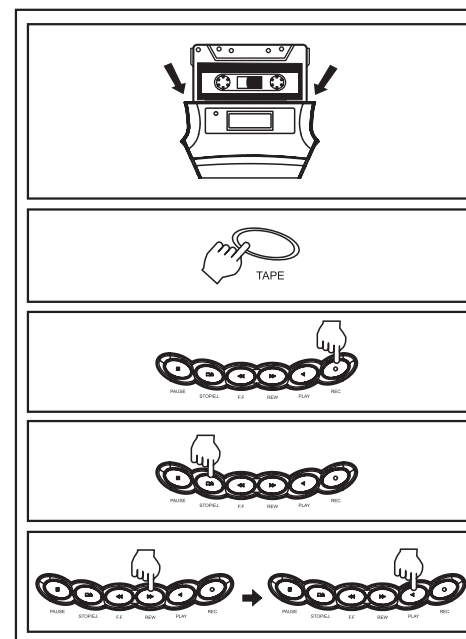

RECORDING FROM A CD

1. Load the cassette tape into the Cassette Door (full reel on the right).
 2. Load the compact disc and close the CD Door.
 3. Press CD button.
 4. Press the Cassette Pause button.
 5. Press the Cassette Record button for record stand by.
- NOTE:** When pressing the Cassette Record Button, the Cassette Play Button will automatically go down (If the buttons do not go down, reverse the tape or check record prevention tab).
6. Start the CD playing by pressing the CD Play/Pause button.

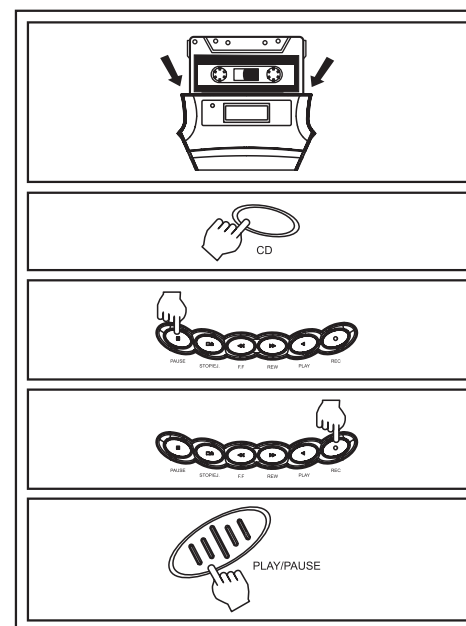

7. Press (and release) the Cassette Pause button when you wish to start recording.
8. Press the Cassette Stop/Eject button to stop the recording.
9. The recording will stop when the tape has reached the end and the Record and Play buttons will pop up.
10. To hear what you recorded, press TAPE button, press Rewind and Play button.

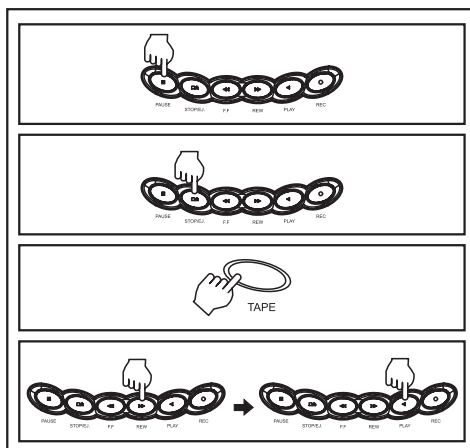

12. REMOTE CONTROL

REMOTE OPERATION

By using the remote controller, you can operate the system in almost the same way as with the controls of the main unit.

MUTE BUTTON

To mute the sound press the MUTE Button on remote controller, then there will be no sound. Press the MUTE Button again, and the music will resume.

REMOTE CONTROL RANGE

Use the remote control within an angle of 30° at the left and right horizontally and over distances up to about 3 meters.

INSERTING BATTERIES

1. Open the battery compartment cover.
2. Install 2pcs UM-4 (size AAA) batteries into the battery Compartment matching the polarity as shown in the battery compartment.
3. Close the battery compartment lid.

NOTE: Always remove batteries if the remote controller is not going to be used for a month or more. Batteries left in the unit may leak and cause damage.

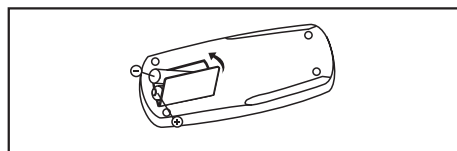

13. PRODUCT SPECIFICATIONS

PICK-UP

| | |
|------------------|---|
| System | Compact disc digital audio system |
| Laser diode | material: GaAlAs |
| Properties | Wavelength: $\lambda = 780\text{nm}$ Emission Duration: continuous Laser output: $<44.6\mu\text{W}$ |
| Error correction | Cross-interleave Reed-solomon code |

AUDIO

| | |
|--------------------|--------------------------------|
| D/A conversion | 1-bit DAC 8 times oversampling |
| Frequency response | 20-20,000Hz (+1/-3 dB) |
| Wow and flutter | Below measurable limits |
| No. of channels | 2 channels (stereo) |
| Output level | Earphone: 20mW (32 Ω) |
| Speakers Impedance | 4 Ω 5W*2 |

RADIO

| | |
|-----------------|---------------------------------------|
| Receiving bands | MW/FM |
| Frequency range | MW 522-1620 KHz FM 87.5 -108.0 MHz |

GENERAL

| | |
|--------------------|--|
| Power requirements | AC 230V DC 8* "C" size (or equivalents) batteries |
| Power consumption | 22W |
| Dimension | Approx. 446.5(L)X240.5(W)X163.0(W) mm |
| Net Weight | Approx. 3.20Kg (not including batteries) |