

Goodmans

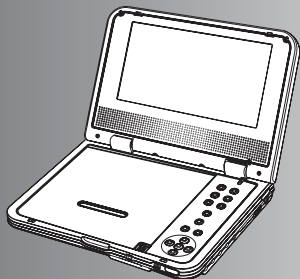

GDVD80W8

Portable DVD Player

User Guide



Getting Started	3	Rotating Pictures	12
Front View	3	Viewing the Next or Previous Picture	12
Side View	4	Thumbnail Function	12
Connections	5		
Using the Battery Pack	7	OSD Setup	13
		Language Setup	13
DVD Playback	9	- OSD Language	13
Basic DVD Playback	9	- Audio Language	13
Stopping Playback and Returning to the Menu Screen		- Subtitle Language	13
(If a Menu Screen is Available on the Disc)	9	- Menu Language	13
Stopping Playback	9	Audio Setup	13
Fast Forward and Backward	9	- Digital Out	13
Skipping a Chapter Ahead or Back	9	Video Setup	14
Pausing Playback	9	- Video Out	14
Frame Advance (Step)	9	- TV Type	14
Muting the Player	9	- TV System	14
Repeating Viewing	9	System Setup	15
Displaying Scene Information	10	- Screen Saver	15
Changing Audio Soundtrack Language	10	- Parental Control [DVD]	15
Changing Subtitle Languages	10	- Password [DVD]	16
Viewing from Different Angles	10	- Angle Mark	16
Using a DVD Menu	10	- Default	16
Using the Menu Function	10		
		LCD Setup	17
Audio CD Playback	11	Panel Setting	17
Basic Audio CDs Playback	11	Color Setting	17
Stopping Playback	11	Brightness Setting	17
Pausing Playback	11	LCD Setting	17
Displaying Track Information	11		
Skipping a Track Ahead or Back	11	Important Safety Information	18
		Disc Use and Care	20
Picture CD Playback	12	Precautions	21
Basic Picture CDs Playback	12	Troubleshooting	22
Stopping Playback	12	Disc Handling and Maintenance	23
Pausing Playback	12	Specifications	24



Front View

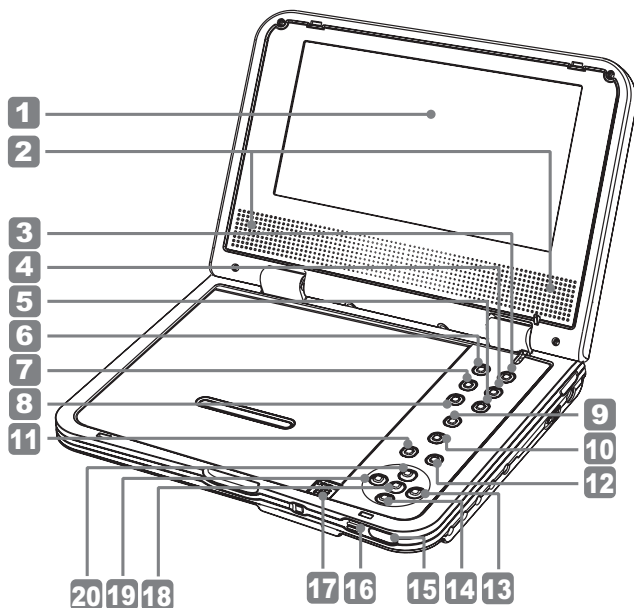

- | | |
|-----------------------|-----------------------|
| 1 LCD Screen | 11 PREVIOUS Button |
| 2 Speakers | 12 NEXT Button |
| 3 SETUP Button | 13 F.FWD/RIGHT Button |
| 4 MENU Button | 14 STOP/DOWN Button |
| 5 SUBTITLE Button | 15 Remote Sensor |
| 6 LCD Button | 16 LED Indicator |
| 7 TITLE Button | 17 EJECT Button |
| 8 AUDIO Button | 18 PLAY/PAUSE Button |
| 9 VOLUME UP Button | 19 F.BWD/LEFT Button |
| 10 VOLUME DOWN Button | 20 INFO./UP Button |



Side Views

Right Side Panel

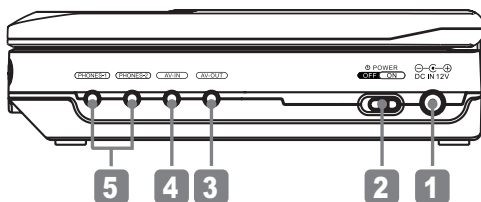

- 1 DC IN Jack
- 2 POWER Switch
- 3 AV OUT Jack
- 4 AV IN Jack
- 5 PHONE Jacks

Back Panel

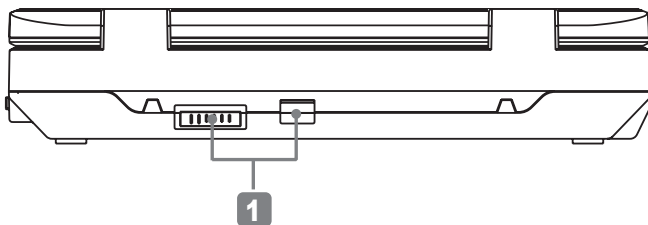

- 1 Battery Connectors



Connections

Connect TV

- 1 Connect the DVD Player to Power.
Please connect the supplied AC adapter to the DC IN jack on the right side of the unit.
- 2 Connect the AV Out of the DVD Player to the Video In and Audio In of your TV with an Audio/Video Cable.

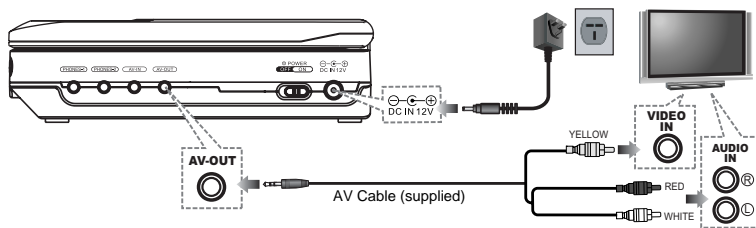

Connect to Other Equipment

- 1 Connect the DVD Player to Power.
Please connect the supplied AC adapter to the DC IN jack on the right side of the unit.
- 2 Connect the Audio/Video Out of the DVD Player to the Audio/Video In of external devices.

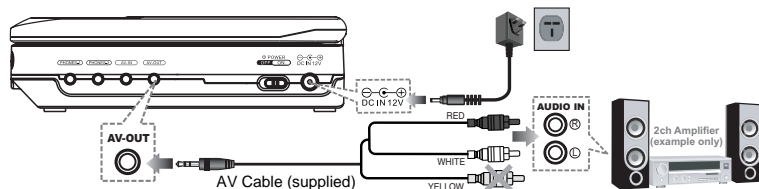



Input from External Equipment

- 1** Connect the DVD Player to Power.
Please connect the supplied AC adapter to the DC IN jack on the right side of the unit.
- 2** Connect the Audio/Video In of the DVD Player to the Audio/Video Out of external devices.

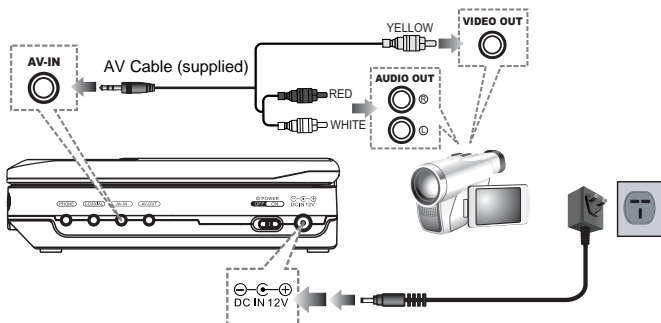



Using the Battery Pack

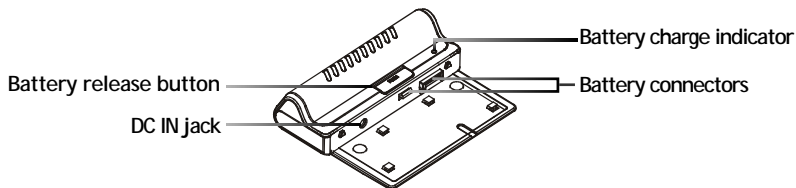

Before using the battery pack, please ensure that it is fully charged. You can charge the battery pack directly or charge it while the battery pack attached to the portable DVD player.

Note:

1. Battery will not charge whilst using the unit.
2. The charging time the battery pack is approximately 4.5 hours and the playing time is approximately 2.5 hours.

A. Charge the battery pack directly

Connect the AC power adaptor to the DC IN socket on the left side of the battery pack and a wall outlet.

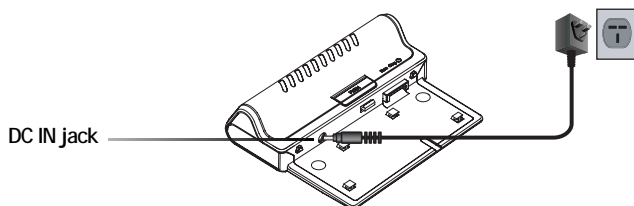

Note:

1. The battery charge indicator will turn red and start charging.
2. When the battery pack is fully charged, the battery charge indicator will turn green.



- B. Charge the battery pack while the battery pack attached to the portable DVD player

STEP 1.

Please align the portable DVD player's battery connectors with the battery pack's battery connectors. Then attach the battery pack to the portable DVD player.

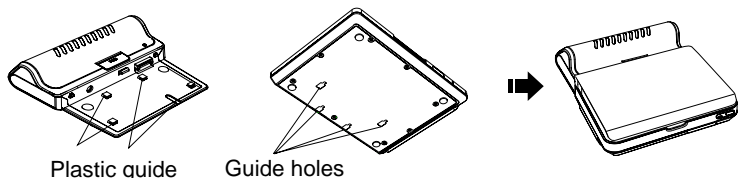

Note:

1. Please turn Power off when attaching or removing the battery pack.
2. If you want to remove the battery pack, press battery release button, then slowly remove it from the portable DVD player by sliding it carefully away from the player.

STEP 2.

Connect the AC power adaptor to the DC IN socket on the right side of the portable DVD player and a wall outlet.

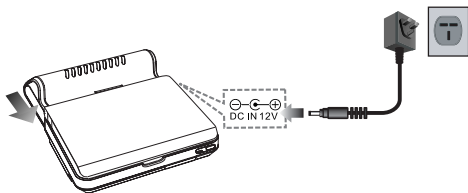

Note:

1. The battery charge indicator will turn red and start charging.
2. When the battery pack is fully charged, the battery charge indicator will turn green.
3. The battery pack is not charged while the portable DVD player is turned on.
4. Please use the specific AC power adaptor to charge the battery pack.



Basic DVD Playback

- 1 Turn on the player. Press **Eject** button to open the disc cover.
- 2 Hold the edge of the disc to put it in the disc tray with the printed side up.
- 3 Close disc cover.
 - Close the disc cover and the portable DVD player starts playback if the disc does not have any menus recorded on it.
 - If the disc has one or more titles recorded on it, a menu screen will appear on the screen.
- 4 To play a title, press **Up / Down / Left / Right** to highlight it and then press **Play** button.

Stopping Playback and Returning to the Menu Screen

(If a Menu Screen is Available on the Disc)

Press **Menu** button.

Stopping Playback

- 1 Press **Stop** button once to enter prestop mode. In prestop status, the disc can be played from where the playback has been stopped by pressing **Play** button.
- 2 To completely stop the disc playback, press **Stop** button again.

Pausing Playback

- 1 Press **Pause** button.
- 2 To return to normal playback, press **Play** button.

Frame Advance (Step)

- 1 Press **Pause** button to pause playback.
 - The disc is advanced by one frame each time pressing **Pause**.
- 2 To return to normal playback, press **Play** button.

Fast Forward and Backward

- 1 Press **Fast Forward** button or **Fast Backward** button during playback.

The speed of advance (**FF**x2, **FF**x4, **FF**x8 and **FF**x20) or reverse (**BB**x2, **BB**x4, **BB**x8 and **BB**x20) changes for each press of **Fast Forward** or **Fast Backward**.
- 2 To return to normal playback, press **Play** button.

Skipping a Chapter Ahead or Back

Skipping Ahead

- Press **Next** button during playback.
- Skip a chapter each time pressing the button.

Skipping Back

- Press **Previous** button during playback.
- When pressing the button once midway through a chapter, the player returns to the beginning of the chapter being played back. The player skips a chapter each time you press the button.



Displaying Scene Information

- 1 Press **Info.** button during playback
 - Press **Info.** a number of times, the title number, chapter number, and other information will show on the screen.
- 2 To stop displaying scene information, press **Info.** button a number of times until the information disappears.

Changing Audio Soundtrack Language

- 1 Press **Audio** button during playback.
- 2 Press **Audio** button a number of times until a preferred language is selected.



Note:

- When the preferred language is not selected even after pressing the button several times, it may indicate that language is not available on the disc.

Changing Subtitle Languages

- 1 Press **Subtitle** button during playback.
- 2 Press **Subtitle** button a number of times until a preferred language is selected.
- 3 To clear the subtitle display, press **Subtitle** until  : [OFF] appears on the screen.

Using a DVD Menu

- 1 Press **Title** button in stop mode. The DVD menu available on the disc appears.

Using a DVD Menu

- 1 Press **Title** button in stop mode. The DVD menu available on the disc appears.
- 2 Press **Up / Down / Left / Right** to select the preferred item.
- 3 Press **Play** button to enter to the selected item.
- 4 To return to the previous menu screen, press **Title** button.

Using the Menu Function

- 1 Press **Play** button.
- 2 Press **Menu** button.
- 3 Press **Up / Down / Left / Right** to select the preferred.



Basic Audio CDs Playback

- 1 Load an Audio CD.
 - For audio CDs without playback control, the DVD player starts playback.
 - For audio CDs provided with playback control, a menu appears after a few seconds.

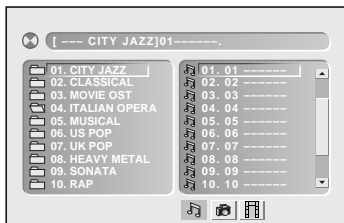

- 2 To play a music track in the menu, press **Left** button to enter the folder list on the left of the screen. Press **Up** / **Down** to highlight a folder and then press **Play** button.

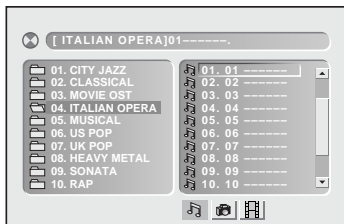

- 3 Press **Right** button to enter the file list on the right of the screen. Press **Up** / **Down** to highlight a track and then press **Play** button.

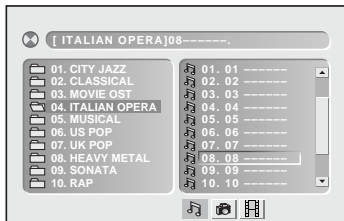

Stopping Playback

Press **Stop** button.

Pausing Playback

- 1 Press **Pause** button.
- 2 To return to normal playback, press **Play** button.

Displaying Track Information

- 1 Press **Info.** button during playback.
- 2 To stop displaying track information, press **Info.** button again.

Skipping a Track Ahead or Back

Skipping Ahead

Press **Next** button during playback.

- Skip a track each time you press the button.

Skipping Back

Press **Previous** button during playback.

- When you press the button once midway through a track, the player returns to the beginning of the track being played back. The player skips a track each time you press the button.



Basic Picture CDs Playback

- 1 Load a Picture CD.
 - For Kodak Picture CDs, the DVD player starts slide show playback.
 - For picture CDs with a menu screen, the menu appears after a few seconds.
- 2 Press **Left** button to enter the folder list on the left screen. Press **Up** / **Down** to highlight a folder and then press **Play** button.





- 3 Press **Right** button to enter the file list on the right screen. Press **Up** / **Down** to highlight a picture and picture review is shown on the left screen.



- 4 To play picture slide show, press **Play** button.



Note: Some discs may contain various music, picture and video file formats. When the player reads the disc, Audio CD mode  will be selected first. To select Picture CD mode, press **Right** until the Picture CD icon  is selected and then press **Play/Sel.**



Select Picture CD icon

Stopping Playback

To stop playback and return to the menu screen, press **Stop** button.

Pausing Playback

- 1 Press **Pause** button playback.
- 2 To return to normal playback, press **Play** button.

Rotating Pictures

Press **Fast Forward** button during playback to rotate the picture clockwise by 90° or press **Fast Backward** button to rotate the picture counter-clockwise by 90°.

Viewing the Next or Previous Picture

Press **Next** button to view the next picture or **Previous** button to view the previous one.

Thumbnail Function

- 1 Press **Title** button.
- 2 Press **Up** / **Down** / **Left** / **Right** to select the preferred picture.
- 3 Press **Play** button to play.



Language Setup

- 1 Press **Setup** button in stop mode.
- 2 Press **Left / Right** button to select **LANGUAGE SETUP** icon and then press **Play** button.

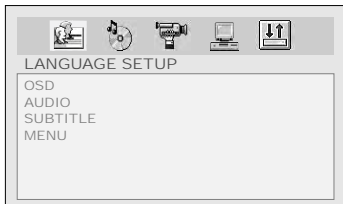

- 3 Press **Up / Down** to select an option and then press **Play** button.

OSD Language



Audio Language



Subtitle Language



Menu Language



- 4 Press **Up / Down** to select a preferred language and then press **Play** button.
- To leave SETUP MENU, press **Setup**.



Note: If the language selected is not recorded on the disc, the player will play the top-priority language of the disc.

Audio Setup

Digital Out

- 1 Press **Setup** button in stop mode.
- 2 Press **Left / Right** button to select **AUDIO SETUP** icon and then press **Play** button.

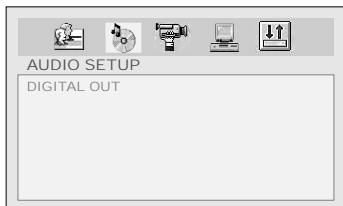



- 3** Press **Up / Down** to select **DIGITAL OUT** and then press **Play** button.



- 4** Press **Up / Down** to select a preferred option and then press **Play** button.
- To leave SETUP MENU, press **Setup**.

**Note:**

- Select **RAW** when connecting the player's Digital Out (Coaxial) jack to a Dolby Digital decoder or an equipment with a Dolby Digital decoder.
- Select **PCM** when connecting the player's Digital Out (Coaxial) jack to a 2-channel digital stereo amplifier. Please do not adjust the volume to zero.

Video Setup

- 1** Press **Setup** button in stop mode.
- 2** Press **Left / Right** button to select **VIDEO SETUP** icon and then press **Play** button.

Video Output

- 3** Press **Up / Down** to select **VIDEO OUTPUT** and then press **Play** button.



- 4** Press **Play** button to confirm the selection.
- To leave SETUP MENU, press **Setup**.

TV Type

- 3** Press **Up / Down** to select **TV TYPE** and then press **Play** button.

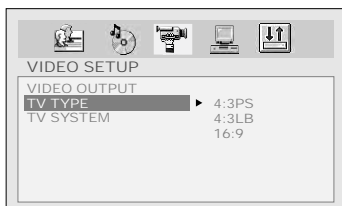

- 4** Press **Up / Down** to select a preferred option and then press **Play** button.
- a** **4:3 Pan Scan** : Select "4:3 PanScan" for a conventional size TV set.



- b** **4:3 Letter Box** : Select "4:3 Letter Box" for a conventional size TV set. Black bands appear at top and bottom of screen (letter-box style).





- C 16:9 Wide**  : Select "16:9 Wide" for a wide-screen TV set to played in "FULL" size.



- To leave SETUP MENU, press **Setup**.

TV System

- 3** Press **Up / Down** to select **TV SYSTEM** and then press **Play** button.

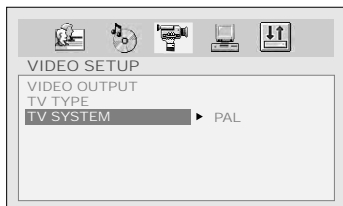

- 4** Press **Play** button to select the option.
- To leave SETUP MENU, press **Setup**.

System Setup

- 1** Press **Setup** button in stop mode.
- 2** Press **Left / Right** to select **SYSTEM SETUP** icon and then press **Play** button.



Screen Saver

- 3** Press **Up / Down** to select **SCREEN SAVER** and then press **Play** button.

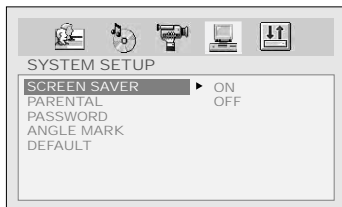

- 4** Press **Up / Down** to select a preferred option and then press **Play** button.
- To leave SETUP MENU, press **Setup**.

Parental

- 3** Press **Up / Down** to select **PARENTAL** and then press **Play** button.

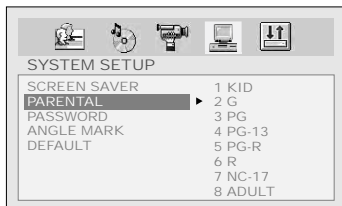

- 4** Enter 4-digit password and press **Play** button.
- Enter factory pre-set password "0000" for the first time setup.

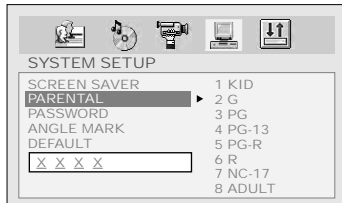



- 5** Press **Up / Down** to select a preferred rating and then press **Play** button.
- To leave SETUP MENU, press **Setup**.

Rating Explanations

1. **KID:** Kid safe; it is safe even for kids.
2. **G:** General audience; recommended as acceptable for viewers of all ages.
3. **PG:** Parental Guidance suggested.
4. **PG-13:** Material is unsuitable for children under the age of 13.
5. **PG-R:** Parental Guidance-restricted; recommended that parents restrict children under age 17 from viewing or allow children to view only when supervised by a parent or adult guardian.
6. **R:** Restricted, children under 17 would not be admitted without an accompanying parent or adult guardian.
7. **NC-17:** No children under the age of 17, not recommended viewing for children under age 17.
8. **ADULT:** Adult only.



Note:

- You can use the parental control lock **ONLY** with DVD discs featured with the parental lock function.
- Please keep in mind that discs not encoded with rating lock protection will play regardless of rating and content.

- 5** Enter new password and then press **Play** button.

- 6** Enter the password again to verify and then press **Play** button.
- To leave SETUP MENU, press **Setup**.

Angle Mark

- 3** Press **Up / Down** to select **ANGLE MARK** and then press **Play** button.



- 4** Press **Up / Down** to select a preferred option and then press **Play** button.
- To leave SETUP MENU, press **Setup**.



Note: Pressing **Angle** button will change camera angles for movies that support this feature regardless of whether the **ANGLE MARK** feature is "On" or "Off".

Password

- 3** Press **Up / Down** to select **PASSWORD** and then press **Play** button.

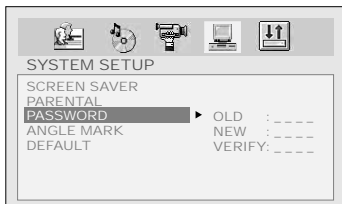

- 4** Enter the previously set password or factory pre-set password "**0000**" and then press **Play** button.

Default

- 3** Press **Up / Down** to select **DEFAULT** and then press **Play** button.



- 4** Press **Right** button to select **DEFAULT** and then press **Play** button.
- To leave SETUP MENU, press **Setup**.

**Panel Setting**

- 1 Press **LCD** a number of times to select **PANEL**.
- 2 Press **Left** / **Right** to choose a preferred panel setting.

PANEL: <- NORMAL ->

PANEL: <- 16:9 ->

- Press **LCD** again until the LCD setting box disappears.

Colour Setting

- 1 Press **LCD** a number of times to select **COLOUR**.
- 2 Press **Left** / **Right** to choose a preferred color setting.

COLOUR: <- +3 ->

COLOUR: <- +2 ->

COLOUR: <- +1 ->

COLOUR: <- 0 ->

COLOUR: <- -1 ->

COLOUR: <- -2 ->

COLOUR: <- -3 ->

- Press **LCD** again until the LCD setting box disappears.

Brightness Setting

- 1 Press **LCD** a number of times to select **BRIGHT**.
- 2 Press **Left** / **Right** to choose a preferred brightness setting.

BRIGHT: <- +3 ->

BRIGHT: <- +2 ->

BRIGHT: <- +1 ->

BRIGHT: <- 0 ->

BRIGHT: <- -1 ->

BRIGHT: <- -2 ->

BRIGHT: <- -3 ->

- Press **LCD** again until the LCD setting box disappears.

Contrast Setting

- 1 Press **LCD** a number of times to select **Contrast**.
- 2 Press **Left** / **Right** to choose a preferred contrast setting.

CONTRAST: <- +3 ->

CONTRAST: <- +2 ->

CONTRAST: <- +1 ->

CONTRAST: <- 0 ->

CONTRAST: <- -1 ->

CONTRAST: <- -2 ->

CONTRAST: <- -3 ->

- Press **LCD** again until the LCD setting box disappears.



Important Safety Information

This manual contains important information about how to safely and properly install, operate and care for this product.

Failure to properly install, operate and care for this product can increase the risk of electric shock or fire. It can also increase the risk of monitor failure and possibly personal injury. To reduce the risk of serious injury, death, or damage.

Read these instructions.
Keep these instructions.
Heed all warnings.
Follow all instructions.



- Do not** attempt to service or repair the monitor & DVD Player yourself. Refer all servicing to qualified service personnel.
- Do not** block any ventilation openings. Do not place the Monitor and DVD Player on a bed, sofa, or other soft surface that may block ventilation openings.
- Do not** install the monitor and DVD Player near any heat sources, such as radiators, stoves, or other devices that produce heat.
- Do not** use this apparatus near water (for example, sinks, tubs, and pools) or expose it to rain, moisture, or dripping or splashing liquids. No objects filled with water (such as vases) should be placed on the apparatus.
- Do not** attempt to service or repair the monitor & DVD Player yourself. Refer all servicing to qualified service personnel.
- Do not** play headphones at a high volume to avoid exposure to excessive sound pressures. You should use extreme caution or temporarily discontinue use in potentially hazardous situation. Even if your headset is an open-air type designed to let you hear outside sounds, do not turn up the volume so high that you can not hear what is around you.



General Electrical Precautions

As with any other electrical devices, failure to take the following precautions can result in serious injury or death from electrical shock or fire, and will lead to damage to the Monitor and DVD Player.

Avoid Laser hazards

As the laser beam used in the DVD Player is harmful to eyes, and to avoid electrical hazards, do not attempt to disassemble the housing. Refer servicing to qualified personnel.

Cleaning

Unplug the unit and turn power off before cleaning this unit.

**IMPORTANT AUDIO SAFETY**

Your hearing is very important to you and to us, so please take care when operating this equipment. It is strongly recommended that you follow the listed guidelines in order to prevent possible damage to or loss of hearing.

Establish a safe sound level

Over time your hearing will adapt to continuous loud sounds and will give the impression that the volume has in fact been reduced. What seems normal to you may in fact be harmful. To guard against this before your hearing adapts set the volume at a low level.

Decibel

Level dB example

30dB quiet library, soft whisper.

40dB Living room, fridge freezer, bedroom away from traffic.

50dB normal conversation, quiet office, light traffic.

60dB Electric sewing machine

The following noise can be harmful under constant exposure

80dB Average city traffic, alarm clock buzzer at 2 feet, food mixer.

90dB Motorcycle, heavy goods vehicle, petrol lawn mower.

100dB Pneumatic drill, chain saw, garbage truck, discotec/night club.

120dB Rock bandconcert, thunderclap.

Permanent loss of hearing

140dB Threshold of pain, gunshot 2 feet away.

180dB Rocket launching pad.

This product incorporates copyright protection technology that is protected by method claims of certain U.S. patents and other intellectual property rights owned by Macrovision Corporation and other rights owners. Use of this copyright protection technology must be authorized by Macrovision Corporation, and is intended for home and other limited viewing uses only unless otherwise authorized by Macrovision Corporation. Reverse engineering or disassembly is prohibited.



DO NOT use non-circular DVD discs, otherwise it may lead to damage to this DVD player.

In order to keep the disc surface clean, please hold the DVD disc by its edge.

DO NOT touch the recorded surface of DVD disc.

DO NOT stick anything on the surface of DVD disc. If there is glue and other adhesive article, please remove it before loading the disc.

DO NOT leave the disc in direct sunlight.

DO NOT leave the disc near a heat source, such as heating pipe.

DO NOT leave a disc inside a car under direct sunlight.

After Playback, always remove the disc from the player and return it to the display/storage case.

To clean discs, use a dry soft cloth moving the cloth from the centre to the outside across the disc surface. **DO NOT** use a rotary motion as this can make the disc unplayable.

DO NOT use Petroleum products or aggressive cleaning agents, as these will damage the disc.

Use of the in car power lead

This lead is specially designed for the unit. **DO NOT** use it for other in car products as this may result in damage to lead or the other equipment.



Please read these precautions before operating this player.

■ Placement

Avoid placing the player in areas of:

- direct sunlight radiators, or closed automobiles
- high temperature (over 35°C) or high humidity (over 90%)
- large amounts of dust as the internal parts may be seriously damaged

■ Non-use periods

When the player is not being used, turn it off. When left unused for a long period of time, the player should be unplugged from the household mains supply.

■ Do not insert fingers or other objects inside unit

- Touching internal parts of this unit is dangerous, and may cause serious damage to the player. Do not attempt to disassemble the player.
- Do not put any foreign object onto the player on the disc tray.

■ Keep away from water/magnet

- Keep the player away from flower vases, tubs, sinks, etc. If liquids are spilled into the player, serious damage could occur.
- Never bring a magnet or magnetized object near the player.

■ Stacking

- Place the player in a horizontal position, and do not place anything heavy on it.

■ Condensation

Moisture may form on the lens in the following conditions:

- immediately after a heater has been turned on
- in a steamy or very humid room
- when the player is suddenly moved from a cold environment to a warm one

If moisture forms inside this player, it may not operate properly. In this case, turn on the power and wait for one hour for the moisture to evaporate.



Troubleshooting

Before requesting service for the DVD Player, check the chart below for a possible cause of the problem you are experiencing. Some simple checkups or a minor adjustment on your part may eliminate the problem and restore proper operation.

SYMPTOM (COMMON)	REMEDY
No power.	<ul style="list-style-type: none">• Insert the power plug securely into the power outlet.• Check if the ON/OFF button on the top of the player is set to on.• Check if no power at the AC outlet by plugging in another appliance for a test.
The player does not start playback when PLAY is pressed.	<ul style="list-style-type: none">• Condensation has formed: wait about 1 to 2 hours to allow the player to dry out.• The player cannot play discs other than DVDs, audio CDs and picture CDs.• Check if the disc is defective by trying another disc.• Check the region (local) code.
The player starts playback but stops immediately.	<ul style="list-style-type: none">• The disc may be dirty and may require cleaning.• Ensure that the disc is correctly placed in the disc frame.
No picture.	<ul style="list-style-type: none">• Ensure that the equipment is connected properly.• Select the same channel and source on the TV as on the player.
No sound.	<ul style="list-style-type: none">• Ensure that the equipment is connected properly.
Distorted sound.	<ul style="list-style-type: none">• Ensure that the input settings for the TV and stereo system are proper.• No sound is heard during still picture (pause) or slow-motion playback.
No audio at Digital Output.	<ul style="list-style-type: none">• Check the digital connections.• Check the settings menu to make sure that the digital output is set to on.• Check if the audio format of the selected audio language matches your receiver capabilities.
Distorted picture.	<ul style="list-style-type: none">• Check the disc for fingerprints and clean with a soft cloth, wiping from center to edge.• Sometimes a small amount of picture distortion may appear. This is not a mal-function.
Completely distorted picture or no color in picture.	<ul style="list-style-type: none">• The disc format is not according to the TV-set used (PAL/NTSC).
Picture is distorted during rapid advance or rapid reverse.	<ul style="list-style-type: none">• The picture will be somewhat distorted at times: this is normal.
No rapid advance (or rapid reverse) playback.	<ul style="list-style-type: none">• Some discs may have sections which prohibit rapid advance (or rapid reverse).
No 4:3 (16:9) picture.	<ul style="list-style-type: none">• Choose the correct setup "TV Aspect" item.
No subtitles.	<ul style="list-style-type: none">• Subtitles appear only with discs that contain them.• Subtitles are hidden from the TV screen. Press SUBTITLE to display the subtitles.
Alternative audio soundtrack (or subtitle) language available.	<ul style="list-style-type: none">• An alternative language can not be selected may result of no more than one languages cannot be selected.
Angle cannot change.	<ul style="list-style-type: none">• This function depends on software availability. Even if a disc has a number from angles recorded, these angles may be recorded for specific scenes only.
No sound when connecting to 5.1 Channel speaker	<ul style="list-style-type: none">• Check if the disc supports 5.1 Channel.• Check if the speaker is properly connected.• Check if the audio output setting is right.
No key operation by the DVD Player.	<ul style="list-style-type: none">• Turn the unit off and then back to on. Alternatively, turn off the unit, disconnect the AC power cord and then re-connect it. (The player may not be operating properly due to lightning, static electricity or some other external factor.)
Distorted picture or no image	<ul style="list-style-type: none">• Check if the TV system setting is correct.• Check If you set output format in "Progressive Scan", then you have to set "Component" in the video output setting. The actual output format must match to the output format setting.
OSD setting	<ul style="list-style-type: none">• Some setting must be stored by pressing left button.



Handling Precautions

- Hold the disc by the edges so the surface will not be soiled with finger-prints. (A)
- Fingerprints, dirt and scratches can cause skipping and distortion.
- Do not write on the label side with a ball-point pen or other writing utensils.
- Do not use record cleaning sprays, benzine, thinner, static electricity prevention liquids or any other solvent.
- Be careful not to drop or bend the disc.
- Do not install more than 1 disc on the disc tray.
- Do not try to close the disc tray when the disc is not installed properly.
- Be sure to store the disc in its exclusive case when not in use.

If the surface is soiled (B)

Wipe gently with a soft, damp (water only) cloth.

When wiping discs, always move the cloth from the center hole toward the outer edge.

(If you wipe the discs using a circular motion, circular scratches are likely to occur, which will cause noise.)

If the disc is brought from a cold to a warm environment, moisture may form on the disc

Wipe the moisture off with a soft, dry, lint-free cloth before using the disc.

Improper disc storage

You can damage discs if you store them in the following places:

- Areas exposed to direct sunlight
- Humid or dusty areas
- Areas directly exposed to a heat outlet or heating appliance

Playable disc format

- MPEG4, DVD, DVD+RW, DVD+R, DVD-RW, DVD-R, CD-DA, Mixed CD-DA, JPEG file disc and Kodak Picture Disc.

Disc which cannot be played with this player

- CD-ROM
- CVD
- CD-G

Maintenance

- Be sure to turn the unit off and disconnect the AC power cord before maintaining the unit.
- Wipe this unit with a dry soft cloth.
If the surfaces are extremely dirty, wipe clean with a cloth which has been dipped in a weak soap-and-water solution and wrung out thoroughly, and then wipe again with a dry cloth.
- Never use alcohol, benzine, thinner, cleaning fluid or other chemicals.
And do not use compressed air to remove dust.

(A)

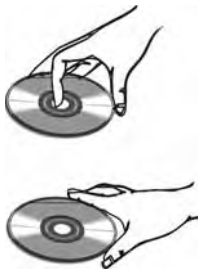

(B)





GDVD80W8	
Disk Format.	DVD/CD/CD-R/CD-RW.
Video System	PAL
Video Decompression	MPEG-2(ISO/IEC-13818)/MPEG-1/MPEG4
LCD Display	8" active-matrix TFT type
Terminals:.	
Audio/Video Section	AV Output x 1 AV Input x 1
Headphone Jacks	Headphone Jack x 2
Line Voltage	AC 100-240 VAC 10% (50/60 Hz) Adapter
Power Consumption	15W (12V, 1.25A)
Dimensions	210 mm (L) x 155 mm (W) x 41 mm (H)
Supplied Accessories	
Power adaptor	1
Cigarette lighter adaptor	1
AV-RCA cable	1
2800mAh battery	1
Earphone	2
User guide	1
Quick guide	1