

Goodmans

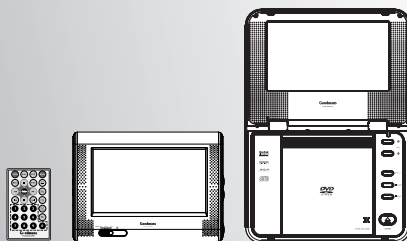

GCE67W5DVK

Dual-Screen Portable DVD Player
With Remote Control

User Guide

Contents

Introduction	3	Displaying Track Information	20
Precations	4	Skipping a Track Ahead or Back	20
Important Safety Information....	5,6	Picture CD Playback	21
Package Contents	7	Basic Picture CDs Playback	21
Getting Started	8	Stopping Playback	21
Remote Control	8	Pausing Playback	21
Portable DVD player.....	9	Rotating Pictures	21
Monitor.....	10	Viewing the Next or Previous Picture	21
Power Supply	11	Thumbnail Function	21
Installing In a Vehicle.....	12,13	OSD Setup	22
Using the Battery Pack.....	14,15	Language Setup	22
Connections	16	- OSD Language	22
Connecting to TV	16	- Audio Language	22
Connecting to Other Audio Equipment... ..	16	- Subtitle Language	22
Input from External Equipment.....	17	- Menu Language	22
Connecting to Earphones	17	Audio Setup	22
DVD Operation	18	- Digital Out	22
Basic DVD Playback	18	Video Setup	23
Stopping Playback and Returning to the Menu Screen (If a Menu Screen is Available on the Disc)	18	- Video Out	23
Stopping Playback	18	- TV Type	23
Fast Forward and Backward	18	- TV System	23
Skipping a Chapter Ahead or Back	18	System Setup	24
Pausing Playback	18	- Screen Saver	24
Frame Advance (Step)	18	- Parental Control [DVD]	25
Muting the Player	18	- Password [DVD]	25
Repeating Viewing	18	- Angle Mark	26
Displaying Scene Information	19	- Default	26
Changing Audio Soundtrack Language	19	LCD Setup	27
Changing Subtitle Languages	19	Panel Setting	27
Viewing from Different Angles	19	Color Setting	27
Using a DVD Menu	19	Brightness Setting	27
Using the Menu Function	19	LCD Setting	27
Audio CD Playback	20	Disc Use and Care	28
Basic Audio CDs Playback	20	Troubleshooting	29
Stopping Playback	20	Disc Handling and Maintenance	30
Pausing Playback	20	Specifications	31

Thank you for purchasing GCE67W5DVVK Dual-Screen Portable DVD Player which has been designed and manufactured to give you many years of trouble-free service.

You may already be familiar with using a similar product but please take time to read these instructions which have been written to ensure you get the very best from your purchase.

NOTE

NOTE: This product incorporates copyright protection technology that is protected by method claims of certain U.S. patents and other intellectual property rights owned by Macrovision Corporation and other rights owners. Use of this copyright technology must be authorised by Macrovision Corporation, and is intended for home and other limited viewing uses only, unless otherwise authorised by Macrovision Corporation. Reverse engineering or disassembly is prohibited.

NOTE

NOTE: Manufactured with permission from Dolby Laboratories. The 'Dolby' label and the double-D logo are trademarks of Dolby Laboratories. Confidential unpublished material. © 1992-1997 Dolby Laboratories, Inc. All rights reserved.

Safety is Important

To ensure your safety and the safety of others, please read the Safety precautions before you operate this product.

Keep this information in a safe place for future reference.



WARNING! THIS PRODUCT UTILISES A CLASS 1 LASER. USE OF CONTROLS, ADJUSTMENTS OR PROCEDURES NOT LISTED IN THIS USER GUIDE MAY RESULT IN HAZARDOUS RADIATION EXPOSURE.



WARNING! ENSURE THAT YOU READ ALL OF THE SAFETY INSTRUCTIONS BEFORE USING YOUR PORTABLE DVD PLAYER.

Power Source

- The Portable DVD Player must only be connected to a 12VDC 1.25A supply.

Safety Considerations

- Position the power lead and other connected leads so that they are not likely to be walked on, pinched or where items can be placed on or against them.
- Do not use the Portable DVD Player in humid or damp conditions.
- Do not place water filled items, such as a vase, on top of the Portable DVD Player.
- Do not place naked flame sources, such as candles on top of the Portable DVD Player.

Cleaning

- Ensure that the mains adapter is disconnected from the mains supply before the Portable DVD Player is cleaned.
- Do not use any liquids or aerosol cleaners, as this may damage the Portable DVD Player.
- The Portable DVD Player should be cleaned with a soft, damp cloth.

Ventilation

- Do not cover any ventilation slots on the Portable DVD Player, as this may cause it to overheat.
- Never allow children to insert foreign objects into holes or slots on the Portable DVD Player.

Battery Disposal

- Please ensure that used batteries are disposed of safely.

Important Safety Information

This manual contains important information about how to safely and properly install, operate and care for this product.

Failure to properly install, operate and care for this product can increase the risk of electric shock or fire. It can also increase the risk of monitor failure and possibly personal injury. To reduce the risk of serious injury, death, or damage.

Read these instruction.
Keep these instructions.
Heed all warnings.
Follow all instructions.



- DO NOT** attempt to service or repair the monitor & DVD Player yourself. Refer all servicing to qualified service personnel.
- DO NOT** block any ventilation openings. Do not place the Monitor and DVD Player on a bed, sofa, or other soft surface that may block ventilation openings.
- DO NOT** install the monitor and DVD Player near any heat sources, such as radiators, stoves, or other devices that produce heat.
- DO NOT** use this apparatus near water (for example, sinks, tubs, and pools) or expose it to rain, moisture, or dripping or splashing liquids. No objects filled with water (such as vases) should be placed on the apparatus.
- DO NOT** attempt to service or repair the monitor & DVD Player yourself. Refer all servicing to qualified service personnel.
- DO NOT** play headphones at a high volume to avoid exposure to excessive sound pressures. You should use extreme caution or temporarily discontinue use in potentially hazardous situation. Even if your headset is an open-air type designed to let you hear outside sounds, do not turn up the volume so high that you can not hear what is around you.



General Electrical Precautions

As with any other electrical devices, failure to take the following precautions can result in serious injury or death from electrical shock or fire, and will lead to damage to the Monitor and DVD Player.

Avoid Laser hazards

As the laser beam used in the DVD Player is harmful to eyes, and to avoid electrical hazards, do not attempt to disassemble the housing. Refer servicing to qualified personnel.

IMPORTANT AUDIO SAFETY

Your hearing is very important to you and to us, so please take care when operating this equipment. It is strongly recommended that you follow the listed guidelines in order to prevent possible damage to or loss of hearing.

Establish a safe sound level

Over time your hearing will adapt to continuous loud sounds and will give the impression that the volume has in fact been reduced. What seems normal to you may in fact be harmful. To guard against this before your hearing adapts set the volume at a low level.

Decibel

Level dB example

30dB quiet library, soft whisper.

40dB Living room, fridge freezer, bedroom away from traffic.

50dB normal conversation, quiet office, light traffic.

60dB Electric sewing machine

The following noise can be harmful under constant exposure

80dB Average city traffic, alarm clock buzzer at 2 feet, food mixer.

90dB Motorcycle, heavy goods vehicle, petrol lawn mower.

100dB Pneumatic drill, chain saw, garbage truck, discotec/night club.

120dB Rock bandconcert, thunderclap.

Permanent loss of hearing

140dB Threshold of pain, gunshot 2 feet away.

180dB Rocket launching pad.

Included in this package should be:

Portable DVD player X 1
Monitor X 1
Remote Control X 1
Rechargeable battery (2800mAh) X 1
Power adaptor X 1
12V cigar adaptor X 1
AV-RCA cable X 1
Earphone X 2
Carry bag (for the DVD player) X 1
Mounting straps (for the monitor) X 1
User guide X 1
Quick guide X 1

Remote Control

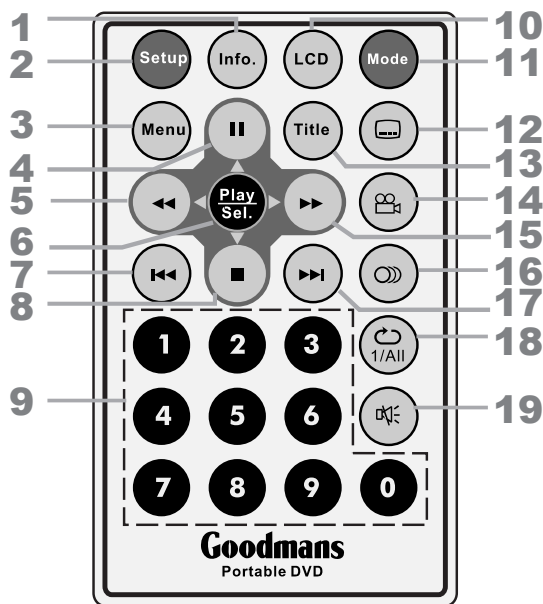

- | | | | |
|----|-------------------|----|---------------------|
| 1 | INFO. Button | 11 | MODE Button |
| 2 | SETUP Button | 12 | SUBTITLE Button |
| 3 | MENU Button | 13 | TITLE Button |
| 4 | PAUSE/UP Button | 14 | ANGLE Button |
| 5 | F.BWD/LEFT Button | 15 | F.FWD/RIGHT Button |
| 6 | PLAY/SEL. Button | 16 | AUDIO Button |
| 7 | PREVIOUS Button | 17 | NEXT Button |
| 8 | STOP/DOWN Button | 18 | REPEAT 1/ALL Button |
| 9 | Number Buttons | 19 | MUTE Button |
| 10 | LCD Button | | |

PORTABLE DVD PLAYER

Front Panel

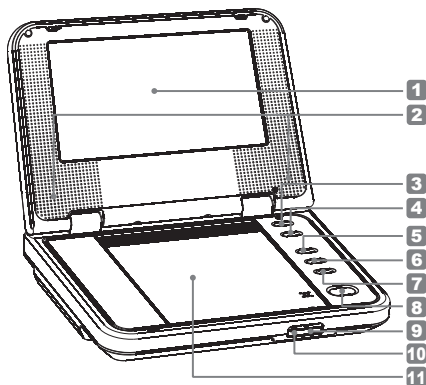

Right Panel

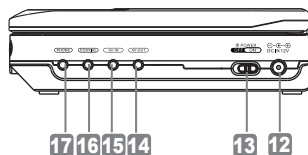

Back Panel

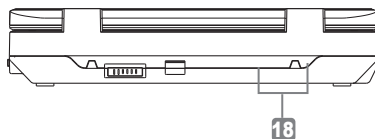

- 1** LCD Screen
- 2** Speakers
- 3** VOLUME(+) Button
- 4** VOLUME(-) Button
- 5** PLAY Button
- 6** PAUSE Button
- 7** STOP Button
- 8** OPEN Button
- 9** Remote Sensor

- 10** LED Indicator
- 11** Disc Cover
- 12** DC IN Socket
- 13** POWER Switch
- 14** AV OUT Socket
- 15** AV IN Socket
- 16** COAXIAL Socket
- 17** PHONE Socket
- 18** Battery Connector

MONITOR

Front Panel

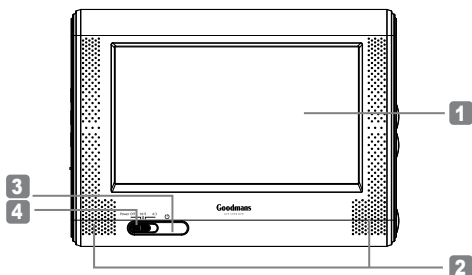

Right/Left Panel

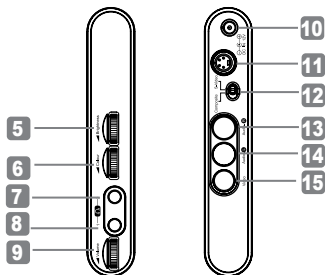

Back Panel

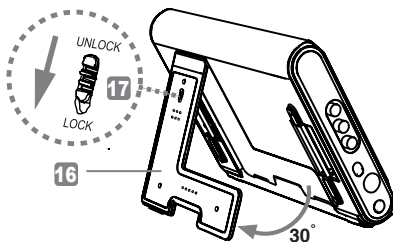

- 1** LCD Screen
- 2** Speakers
- 3** POWER indicator
- 4** POWER OFF/16:9/4:3 switch
- 5** BRIGHTNESS adjustment dial
- 6** COLOUR adjustment dial
- 7** Earphone 1 socket
- 8** Earphone 2 socket

- 9** Volume adjustment dial
- 10** DC IN socket
- 11** S-VIDEO socket
- 12** COMPOSITE/S-VIDEO input switch
- 13** AUDIO R socket
- 14** AUDIO L socket
- 15** VIDEO socket
- 16** Retractable Stand
- 17** Lock/Unlock switch

Power Supply**Connect the portable DVD player to Power.****(a) By AC power adaptor**

Connect the supplied AC power adaptor (12Vdc, 1.25A), the other end to the wall outlet.

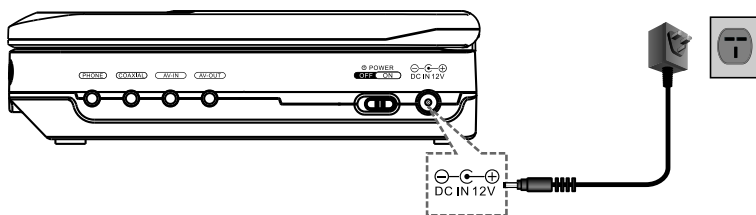
**(b) By cigar adaptor plug**

Connect the supplied 12 volt cigar adaptor plug to the DC IN socket on the player, the other end to the cigar lighter socket.

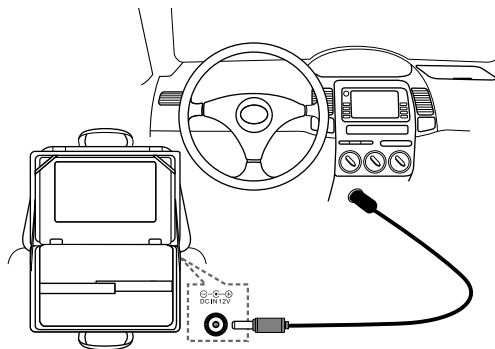

Installing In a Vehicle

For using the Dual-screen Portable DVD Player in a vehicle, please proceed following steps:

Note: Always remember to lock the clips and tighten the straps to ensure safety of your passengers.

1 Place your portable DVD player into the carry bag.



2 Pull the elastic straps over the top corners of the screen; and then fasten the straps with the velcros.

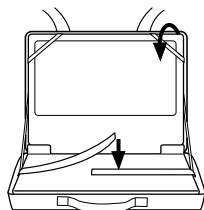

3 Loop the straps around the headrest, with the DVD player facing the rear seat, then fasten the straps with the clip.

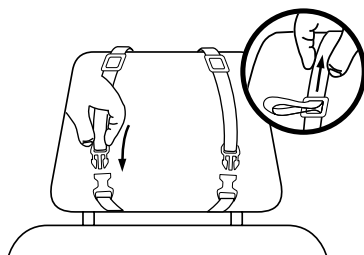

4 Flip down 180 degrees

If you want to place a disc whilst releasing the velcros, please hold still the DVD player to prevent slip-out of the carry bag.

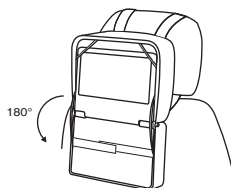

5 Thread both strap ends through eyelets of the monitor(1). Loop the straps around the headrest, with the screen facing the rear seat, and then fasten the straps with the velcros (2).

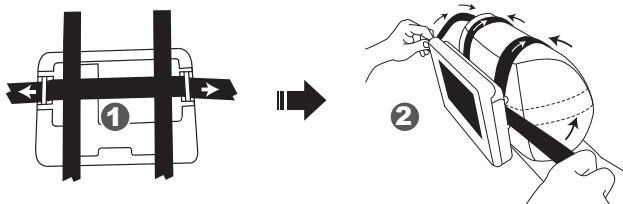

6 Connect the DVD player and the monitor to your car's DC12V cigarette lighter socket with the branched power cord (1). Then, connect the 3.5mm AV plug to the DVD player and the AV plugs to the Monitor (2).

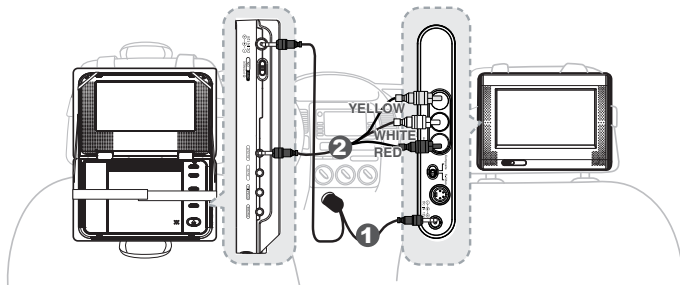

Using the Battery Pack

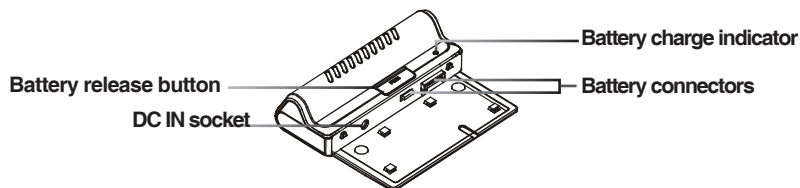

Before using the battery pack, please ensure that it is fully charged. You can charge the battery pack directly or charge it while the battery pack attached to the portable DVD player.

Note:

1. Battery will not charge whilst using the unit.
2. The charging time the battery pack is approximately 3.5 hours and the playing time is approximately 2.5 hours.

Battery Pack Information (Charge & Playback Time)

	Charge Time (hr)	DVD Playback Time (hr)
NiMH 2800mAh	3.5	2.5

Charge the battery pack directly

Connect the AC power adaptor to the DC IN socket on the left side of the battery pack and a wall outlet.

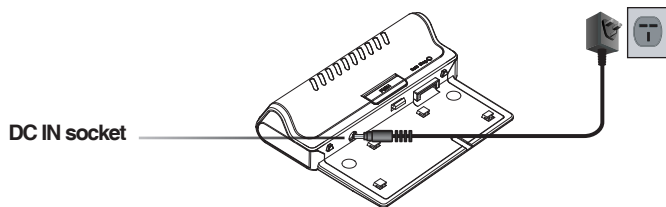

Note:

1. The battery charge indicator will turn red and start charging.
2. When the battery pack is fully charged, the battery charge indicator will turn green.

Charge the battery pack while the battery pack attached to the portable DVD player

- 1 Please align the portable DVD player's battery connectors with the battery pack's battery connectors. Then attach the battery pack to the portable DVD player.

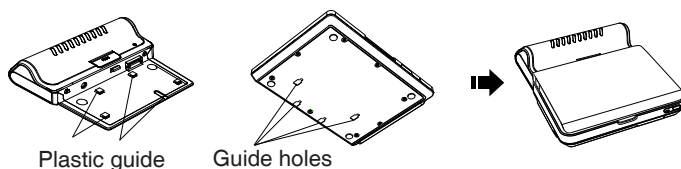

Note:

1. Please turn Power off when attaching or removing the battery pack.
2. If you want to remove the battery pack, press battery release button, then slowly remove it from the portable DVD player by sliding it carefully away from the player.

- 2 Connect the AC power adaptor to the DC IN socket on the right side of the portable DVD player and a wall outlet.

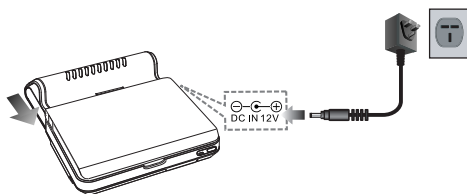

Note:

1. The battery charge indicator will turn red and start charging.
2. When the battery pack is fully charged, the battery charge indicator will turn green.
3. The battery pack is not charged while the portable DVD player is turned on.
4. Please use the specific AC power adaptor to charge the battery pack.

Connecting TV

- 1 Connect the DVD Player to Power.
Please connect the supplied AC adapter to the DC IN socket on the right side of the unit.
- 2 Connect the AV Out of the DVD Player to the Video In and Audio In of your TV with an Audio/Video Cable.
- 3 Press **Mode** button to switch to AV OUT Mode (if the player is in AV IN Mode).
Note: "AV OUT" appears on the screen after switching the mode.

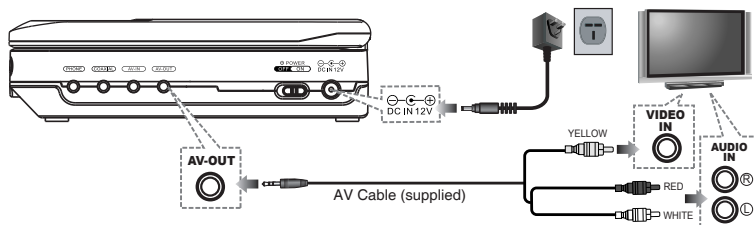

Connecting to Other Audio Equipment

- 1 Connect the DVD Player to Power.
- 2 Connect the Coaxial output of the DVD Player to the Coaxial input of external devices.
"SPDIF RAW" should be selected for digital output. (Refer to "Digital Out" on page 22)
- 3 Press **Mode** button to switch AV OUT Mode (if the player is in AV IN Mode).
Note: "AV OUT" appears on the screen after switching the mode.

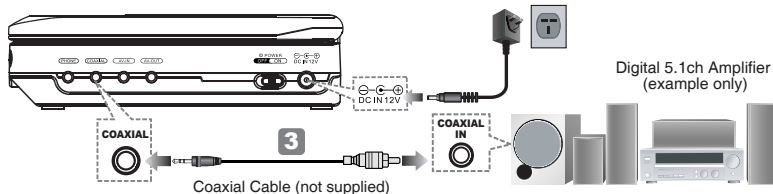

Input from External Equipment

- 1 Connect the DVD Player to Power.
- 2 Connect the Audio/Video In of the DVD Player to the Audio/Video Out of external devices.
- 3 Press **Mode** button to switch to AV IN Mode (if the player is in AV OUT mode).

Note: "AV IN" appears on the screen after switching the mode.

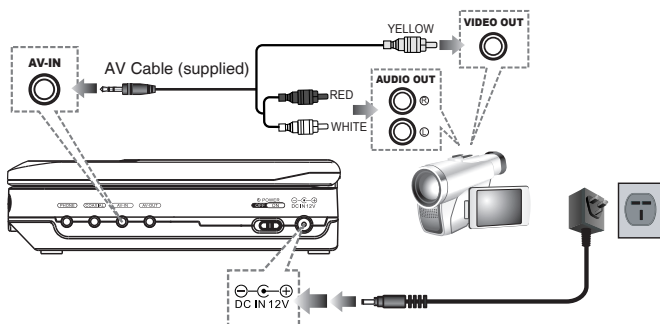

Connecting to Earphones

You may connect earphones to both the DVD player and the monitor's earphone sockets.

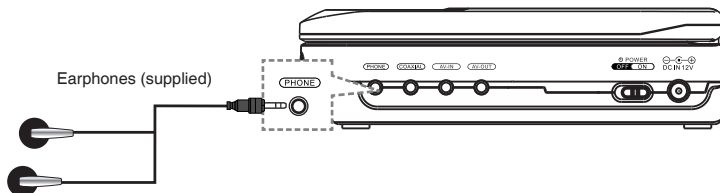

Basic DVD Playback

- 1 Turn on the player. Press **OPEN** to open the disc cover.
- 2 Hold the edge of the disc to put it in the disc tray with the printed side up.
- 3 Close disc cover.
 - Close the disc cover and the portable DVD player starts playback if the disc does not have any menus recorded on it.
 - If the disc has one or more titles recorded on it, a menu screen will appear on the screen.
- 4 To play a title, press **Up** / **Down** / **Left** / **Right** or **Number Button(s)** to highlight it and then press **Play/Sel..**

Stopping Playback and Returning to the Menu Screen (If a Menu Screen is Available on the Disc)

Press **Menu**.

Stopping Playback

- 1 Press **Stop** once to enter prestop mode. In prestop status, the disc can be played from where the playback has been stopped by pressing **Play/Sel..**
- 2 To completely stop the disc playback, press **Stop** again.

Pausing Playback

- 1 Press **Pause**.
- 2 To return to normal playback, press **Play/Sel..**

Frame Advance (Step)

- 1 Press **Pause** to pause playback.
 - The disc is advanced by one frame each time pressing **Pause**.
- 2 To return to normal playback, press **Play/Sel..**

Fast Forward and Backward

- 1 Press **Fast Forward** or **Fast Backward** during playback.
The speed of advance (x2, x4, x8 and x20) or reverse (x2, x4, x8 and x20) changes for each press of **Fast Forward** or **Fast Backward**.
- 2 To return to normal playback, press **Play/Sel..**

Skipping a Chapter Ahead or Back

Skipping Ahead

- Press **Next** during playback.
- Skip a chapter each time pressing the button.

Skipping Back

- Press **Previous** during playback.
- When pressing the button once midway through a chapter, the player returns to the beginning of the chapter being played back. The player skips a chapter each time you press the button.

Muting the Player

- 1 Press **Mute**.
- 2 To resume the sound, press **Mute** again.

Repeat Viewing



During playback, press  **1/All Repeat** repeatedly to select the following options:

REP: [CHAPTER] : Repeat Chapter



REP: [TITLE] : Repeat Title

REP: [OFF] : Repeat Off

Displaying Scene Information

- 1 Press  **Info.** during playback
- Press  **Info.** a number of times, the title number, chapter number, and other information will show on the screen.
- 2 To stop displaying scene information, press  **Info.** a number of times until the information disappears.

Changing Audio Soundtrack Language





- 1 Press  **Audio** during playback.
- 2 Press  **Audio** a number of times until a preferred language is selected.





Note:

- When the preferred language is not selected even after pressing the button several times, it may indicate that language is not available on the disc.

Changing Subtitle Languages

- 1 Press  **Subtitle** during playback.
- 2 Press  **Subtitle** a number of times until a preferred language is selected.
- 3 To clear the subtitle display, press  **Subtitle** until  : **[OFF]** appears on the screen.

Viewing from Different Angles







- 1 Press  **Angle** during playback.
- 2 Press  **Angle** a number of times until the preferred viewing angle is selected.







Note:

- This operation works only with discs on which multiple viewing angles are recorded.

Using a DVD Menu

- 1 Press  **Title** in stop mode. The DVD menu available on the disc appears.
- 2 Press  **Up** /  **Down** /  **Left** /  **Right** to select the preferred item.
- 3 Press  **Play/Sel.** to enter to the selected item.
- 4 To return to the previous menu screen, press  **Title**.

Using the Menu Function

- 1 Press  **Play/Sel..**
- 2 Press  **Menu.**
- 3 Press  **Up** /  **Down** /  **Left** /  **Right** or **Number Button(s)** to select the preferred title.

Basic Audio CDs Playback

- 1 Load an Audio CD.
 - For audio CDs without playback control, the DVD player starts playback.
 - For audio CDs provided with playback control, a menu appears after a few seconds.

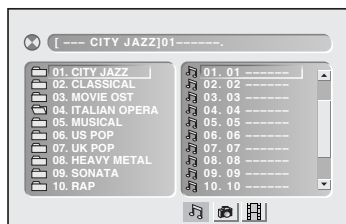

- 2 To play a music track in the menu, press **Left** to enter the folder list on the left of the screen. Press **Up** / **Down** to highlight a folder and then press **Play/Sel.**



- 3 Press **Right** to enter the file list on the right of the screen. Press **Up** / **Down** to highlight a track and then press **Play/Sel.**



Stopping Playback

Press **Stop**.

Pausing Playback

- 1 Press **Pause**.
- 2 To return to normal playback, press **Play/Sel.**

Displaying Track Information

- 1 Press **Info.** during playback.
- 2 To stop displaying track information, press **Info.** again.

Skipping a Track Ahead or Back

Skipping Ahead

- Press **Next** during playback.
- Skip a track each time you press the button.

Skipping Back

- Press **Previous** during playback.
- When you press the button once midway through a track, the player returns to the beginning of the track being played back. The player skips a track each time you press the button.

Basic Picture CDs Playback

- 1 Load a Picture CD.
 - For Kodak Picture CDs, the DVD player starts slide show playback.
 - For picture CDs with a menu screen, the menu appears after a few seconds.
- 2 Press **Left** to enter the folder list on the left screen. Press **Up** / **Down** to highlight a folder and then press **Play/Sel.**



- 3 Press **Right** to enter the file list on the right screen. Press **Up** / **Down** to highlight a picture and picture review is shown on the left screen.



- 4 To play picture slide show, press **Play/Sel.**



Note:

- Some discs may contain both music and picture file formats. When the player reads the disc, Audio CD mode will be selected first. To select Picture CD mode, press **Right** until the Picture CD icon is selected and then press **Play/Sel.**



Select Picture CD icon

Stopping Playback

To stop playback and return to the menu screen, press **Stop**.

Pausing Playback

- 1 Press **Pause** playback.
- 2 To return to normal playback, press **Play/Sel.**

Rotating Pictures

Press **Fast Forward** during playback to rotate the picture clockwise by 90° or press **Fast Backward** to rotate the picture counter-clockwise by 90°.

Viewing the Next or Previous Picture

Press **Next** to view the next picture or **Previous** to view the previous picture.

Thumbnail Function

- 1 Press **Title**.
- 2 Press **Up** / **Down** / **Left** / **Right** to select the preferred picture.
- 3 Press **Play/Sel.** to play.

Language Setup

- 1 Press **Setup** **Setup** in stop mode.
- 2 Press **Left** / **Right** to select **LANGUAGE SETUP** icon and then press **Play/Sel.**



- 3 Press **Up** / **Down** to select an option and then press **Play/Sel.**

OSD Language



Audio Language

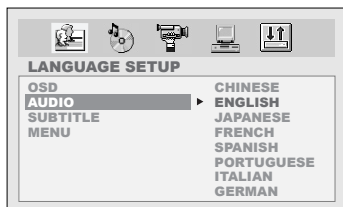

Subtitle Language

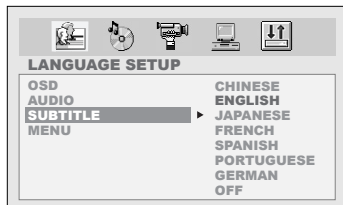

Menu Language

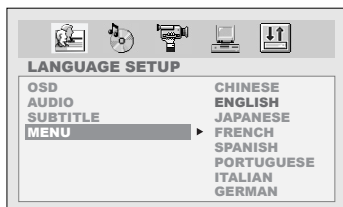

- 4 Press **Up** / **Down** to select a preferred language and then press **Play/Sel.**
- To leave SETUP MENU, press **Setup** **Setup**.



Note: If the language selected is not recorded on the disc, the player will play the top-priority language of the disc.

Audio Setup

Digital Out

- 1 Press **Setup** **Setup** in stop mode.
- 2 Press **Left** / **Right** to select **AUDIO SETUP** icon and then press **Play/Sel.**

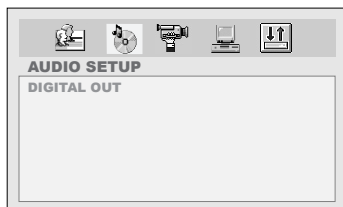

- 3 Press **Up** / **Down** to select **DIGITAL OUT** and then press **Play/Sel.**



- 4 Press **Up** / **Down** to select a preferred option and then press **Play/Sel.**
- To leave SETUP MENU, press **Setup**.



Note:

- Select **RAW** when connecting the player's Digital Out (Coaxial) socket to a Dolby Digital decoder or an equipment with a Dolby Digital decoder.
- Select **PCM** when connecting the player's Digital Out (Coaxial) socket to a 2-channel digital stereo amplifier. Please do not adjust the volume to zero.

Video Setup

- 1 Press **Setup** in stop mode.
- 2 Press **Left** / **Right** to select **VIDEO SETUP** icon and then press **Play/Sel.**

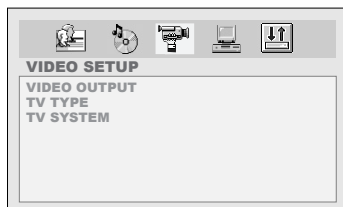

Video Output

- 3 Press **Up** / **Down** to select **VIDEO OUTPUT** and then press **Play/Sel.**

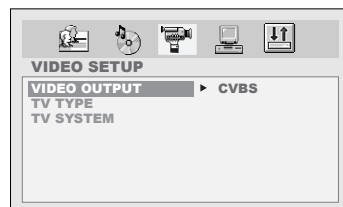

- 4 To select the option, press **Play/Sel.**
- To leave SETUP MENU, press **Setup**.

TV Type

- 3 Press **Up** / **Down** to select **TV TYPE** and then press **Play/Sel.**

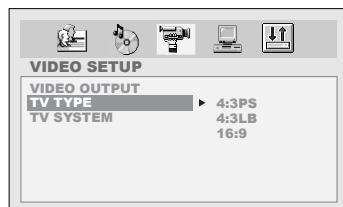

- 4** Press **Up** / **Down** to select a preferred option and then press **Play/Sel.**

- a** **4:3 Pan Scan** : Select "4:3 PanScan" for a conventional size TV set.



- b** **4:3 Letter Box** : Select "4:3 Letter Box" for a conventional size TV set. Black bands appear at top and bottom of screen (letter-box style).

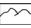

- c** **16:9 Wide** : Select "16:9 Wide" for a wide-screen TV set to played in "FULL" size.



- To leave SETUP MENU, press **Setup** **Setup**.

TV System

- 3** Press **Up** / **Down** to select **TV SYSTEM** and then press **Play/Sel.**

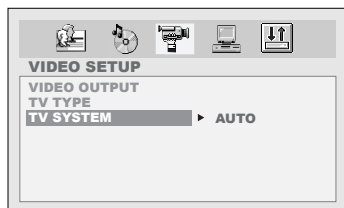

- 4** To select the option, press **Play/Sel.**
- To leave SETUP MENU, press **Setup** **Setup**.

System Setup

- 1** Press **Setup** **Setup** in stop mode.
2 Press **Left** / **Right** to select **SYSTEM SETUP** icon and then press **Play/Sel.**

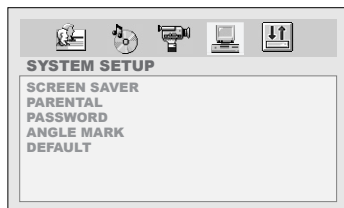

Screen Saver

- 3** Press **Up** / **Down** to select **SCREEN SAVER** and then press **Play/Sel.**

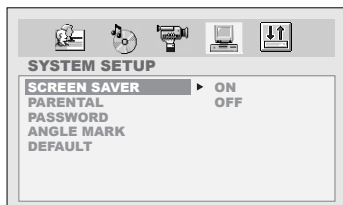

- 4 Press **Up** / **Down** to select a preferred option and then press **Play/Sel.**
 - To leave SETUP MENU, press **Setup** **Setup**.

Parental

- 3 Press **Up** / **Down** to select **PARENTAL** and then press **Play/Sel.**

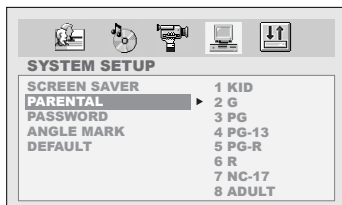

- 4 Enter 4-digit password and press **Play/Sel.**
- Enter factory pre-set password "0000" for the first time setup.

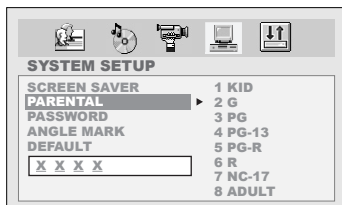

- 5 Press **Up** / **Down** to select a preferred rating and then press **Play/Sel.**
 - To leave SETUP MENU, press **Setup** **Setup**.

Rating Explanations

- KID:** Kid safe; it is safe even for kids.
- G:** General audience; recommended as acceptable for viewers of all ages.
- PG:** Parental Guidance suggested.
- PG-13:** Material is unsuitable for children under the age of 13.
- PG-R:** Parental Guidance-restricted; recommended that parents restrict children under age 17 from viewing or allow children to view only when supervised by a parent or adult guardian.
- R:** Restricted, children under 17 would not be admitted without an accompanying parent or adult guardian.
- NC-17:** No children under the age of 17, not recommended viewing for children under age 17.
- ADULT:** Adult only.



Note:

- You can use the parental control lock **ONLY** with DVD discs featured with the parental lock function..
- Please keep in mind that discs not encoded with rating lock protection will play regardless of rating and content.

Password

- 3 Press **Up** / **Down** to select **PASSWORD** and then press **Play/Sel.**

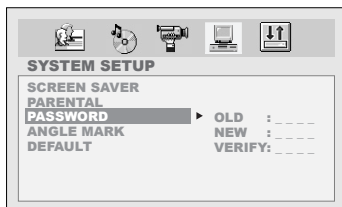

- 4 Enter the previously set password or factory pre-set password "0000" and then press **Play/Sel..**
- 5 Enter new password and then press **Play/Sel..**
- 6 Enter the password again to verify and then press **Play/Sel..**
- To leave SETUP MENU, press **Setup.**

Angle Mark

- 3 Press **Up / Down** to select **ANGLE MARK** and then press **Play/Sel..**



- 4 Press **Up / Down** to select a preferred option and then press **Play/Sel..**
- To leave SETUP MENU, press **Setup.**



Note:

- Pressing **Angle** will change camera angles for movies that support this feature regardless of whether the ANGLE MARK feature is "On" or "Off".

Default

- 3 Press **Up / Down** to select **DEFAULT** and then press **Play/Sel..**

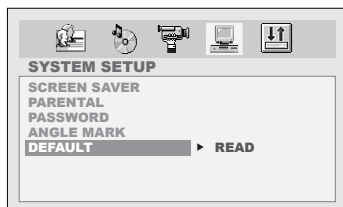

- 4 Press **Right** to select **READ** and then press **Play/Sel..**
- To leave SETUP MENU, press **Setup.**

Panel Setting



- 1 Press  **LCD** a number of times to select **PANEL**.
- 2 Press  **Left** /  **Right** to choose a preferred panel setting.

PANEL: <- NORMAL ->

PANEL: <- 4:3 ->

- Press  **LCD** again until the LCD setting box disappears.

Colour Setting

- 1 Press  **LCD** a number of times to select **COLOUR**.
- 2 Press  **Left** /  **Right** to choose a preferred color setting.

COLOUR: <- +3 ->

COLOUR: <- +2 ->

COLOUR: <- +1 ->

COLOUR: <- 0 ->



COLOUR: <- -1 ->

COLOUR: <- -2 ->

COLOUR: <- -3 ->

- Press  **LCD** again until the LCD setting box disappears.

Brightness Setting

- 1 Press  **LCD** a number of times to select **BRIGHT**.
- 2 Press  **Left** /  **Right** to choose a preferred brightness setting.

BRIGHT: <- +3 ->

BRIGHT: <- +2 ->

BRIGHT: <- +1 ->

BRIGHT: <- 0 ->



BRIGHT: <- -1 ->

BRIGHT: <- -2 ->

BRIGHT: <- -3 ->

- Press  **LCD** again until the LCD setting box disappears.

LCD Setting

- 1 Press  **LCD** a number of times to select **LCD**.
- 2 Press  **Left** /  **Right** to choose "ON" or "OFF".

LCD: <- OFF ->

LCD: <- ON ->

- Press  **LCD** again until the LCD setting box disappears.

DO NOT use non-circular DVD discs, otherwise it may lead to damage to this DVD player. In order to keep the disc surface clean, please hold the DVD disc by its edge.

DO NOT touch the recorded surface of DVD disc.

DO NOT stick anything on the surface of DVD disc. If there is glue and other adhesive article, please remove it before loading the disc.

DO NOT leave the disc in direct sunlight.

DO NOT leave the disc near a heat source, such as heating pipe.

DO NOT leave a disc inside a car under direct sunlight.

After Playback, always remove the disc from the player and return it to the display/storage case.

To clean discs, use a dry soft cloth moving the cloth from the centre to the outside across the disc surface. **DO NOT** use a rotary motion as this can make the disc unplayable.

DO NOT use Petroleum products or aggressive cleaning agents, as these will damage the disc.

Use of the in car power lead

This lead is specially designed for the unit. **DO NOT** use it for other in car products as this may result in damage to lead or the other equipment.

Troubleshooting

Before requesting service for the DVD Player, check the chart below for a possible cause of the problem you are experiencing. Some simple checkups or a minor adjustment on your part may eliminate the problem and restore proper operation.

SYMPTOM (COMMON)	REMEDY
No power.	<ul style="list-style-type: none"> • Insert the power plug securely into the power outlet. • Check if the ON/OFF button on the top of the player is set to on. • Check if no power at the AC outlet by plugging in another appliance for a test.
The player does not start playback when PLAY is pressed.	<ul style="list-style-type: none"> • Condensation has formed: wait about 1 to 2 hours to allow the player to dry out. • The player cannot play discs other than DVDs, audio CDs and picture CDs. • Check if the disc is defective by trying another disc. • Check the region (local) code.
The player starts playback but stops immediately.	<ul style="list-style-type: none"> • The disc may be dirty and may require cleaning. • Ensure that the disc is correctly placed in the disc frame.
No picture.	<ul style="list-style-type: none"> • Ensure that the equipment is connected properly. • Select the same channel and source on the TV as on the player. • Ensure that the equipment is connected properly.
No sound.	<ul style="list-style-type: none"> • Ensure that the input settings for the TV and stereo system are proper.
Distorted sound.	<ul style="list-style-type: none"> • No sound is heard during still picture (pause) or slow-motion playback.
No audio at Digital Output.	<ul style="list-style-type: none"> • Check the digital connections. • Check the settings menu to make sure that the digital output is set to on. • Check if the audio format of the selected audio language matches your receiver capabilities.
Distorted picture.	<ul style="list-style-type: none"> • Check the disc for fingerprints and clean with a soft cloth, wiping from center to edge. • Sometimes a small amount of picture distortion may appear. This is not a mal-function. • The disc format is not according to the TV-set used (PAL/NTSC).
Completely distorted picture or no color in picture.	
Picture is distorted during rapid advance or rapid reverse.	<ul style="list-style-type: none"> • The picture will be somewhat distorted at times: this is normal.
No rapid advance (or rapid reverse) playback.	<ul style="list-style-type: none"> • Some discs may have sections which prohibit rapid advance (or rapid reverse).
No 4:3 (16:9) picture.	<ul style="list-style-type: none"> • Choose the correct setup "TV Aspect" item.
No operations perform with the remote control.	<ul style="list-style-type: none"> • Check the batteries are installed with the correct polarities (+ and -). • The batteries are depleted: replace them with new ones. • Point the remote control unit at the remote control signal sensor and operate. • Operate the remote control unit at a distance of not more than 7 meters from the remote control signal sensor. • Remove the obstacles between the remote control unit and remote control signal sensor.
No subtitles.	<ul style="list-style-type: none"> • Subtitles appear only with discs that contain them. • Subtitles are hidden from the TV screen. Press SUBTITLE to display the subtitles.
Alternative audio soundtrack (or subtitle) language available.	<ul style="list-style-type: none"> • An alternative language can not be selected may result of no more than one languages cannot be selected.
Angle cannot change.	<ul style="list-style-type: none"> • This function depends on software availability. Even if a disc has a number from angles recorded, these angles may be recorded for specific scenes only.
No sound when connecting to 5.1 Channel speaker	<ul style="list-style-type: none"> • Check if the disc supports 5.1 Channel. • Check if the speaker is properly connected. • Check if the audio output setting is right.
No key operation (by the DVD Player and/or the remote control) is effective.	<ul style="list-style-type: none"> • Turn the unit off and then back to on. Alternatively, turn off the unit, disconnect the AC power cord and then re-connect it. (The player may not be operating properly due to lightning, static electricity or some other external factor.)
Distorted picture or no image	<ul style="list-style-type: none"> • Check if the TV system setting is correct. • Check if you set output format in "Progressive Scan", then you have to set "Component" in the video output setting. The actual output format must match to the output format setting.
OSD setting	<ul style="list-style-type: none"> • Some setting must be stored by pressing left button.

Handling Precautions

- Hold the disc by the edges so the surface will not be soiled with fingerprints. (A)
- Fingerprints, dirt and scratches can cause skipping and distortion.
- Do not write on the label side with a ball-point pen or other writing utensils.
- Do not use record cleaning sprays, benzine, thinner, static electricity prevention liquids or any other solvent.
- Be careful not to drop or bend the disc.
- Do not install more than 1 disc on the disc tray.
- Do not try to close the disc tray when the disc is not installed properly.
- Be sure to store the disc in its exclusive case when not in use.

If the surface is soiled (B)

Wipe gently with a soft, damp (water only) cloth.

When wiping discs, always move the cloth from the center hole toward the outer edge.

(If you wipe the discs using a circular motion, circular scratches are likely to occur, which will cause noise.)

If the disc is brought from a cold to a warm environment, moisture may form on the disc.

Wipe the moisture off with a soft, dry, lint-free cloth before using the disc.

Improper disc storage

You can damage discs if you store them in the following places:

- Areas exposed to direct sunlight
- Humid or dusty areas
- Areas directly exposed to a heat outlet or heating appliance

Playable disc format

- DVD, DVD+RW, DVD+R, DVD-RW, DVD-R, CD-DA, Mixed CD-DA, JPEG file disc and Kodak Picture Disc.

Disc which cannot be played with this player

- CD-ROM
- CVD
- CD-G

Maintenance

- Be sure to turn the unit off and disconnect the AC power cord before maintaining the unit.
- Wipe this unit with a dry soft cloth.
If the surfaces are extremely dirty, wipe clean with a cloth which has been dipped in a weak soap-and-water solution and wrung out thoroughly, and then wipe again with a dry cloth.
- Never use alcohol, benzine, thinner, cleaning liquid or other chemicals. And do not use compressed air to remove dust.

(A)



(B)

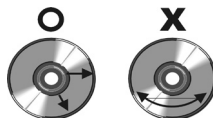

GCE67W5DVDK	
Portable DVD player	
Disk Format.	DVD/CD/CD-R/CD-RW
Video System	AUTO
Video Decompression	MPEG-2(ISO/IEC-13818)/MPEG-1/MPEG4
LCD Display	7" active-matrix TFT type
Terminals:	
Audio/Video Section	AV Output x 1 AV Input x 1 Coaxial Output x 1
Headphone Socket	Headphone Socket x 1
Line Voltage	AC 100-240 VAC \pm 10% (50/60 Hz) Adapter
Power Consumption	15W (12V, 1.25A)
Dimensions	210 mm (L) x 155 mm (W) x 41 mm (H)
Monitor	
LCD Display	7" active-matrix TFT type
Terminals:	
Audio/Video Section	
Audio/Video Section	AV Input x 1 S-Video Input x 1
Headphone Socket	Headphone Socket x 2
Line Voltage	AC 100-240 VAC \pm 10% (50/60 Hz) Adapter
Power Consumption	15W (12V, 1.25A)
Dimensions	206 mm (L) x 150 mm (W) x 36 mm (H)