

# Goodmans

## MICRO1530 INSTRUCTION MANUAL

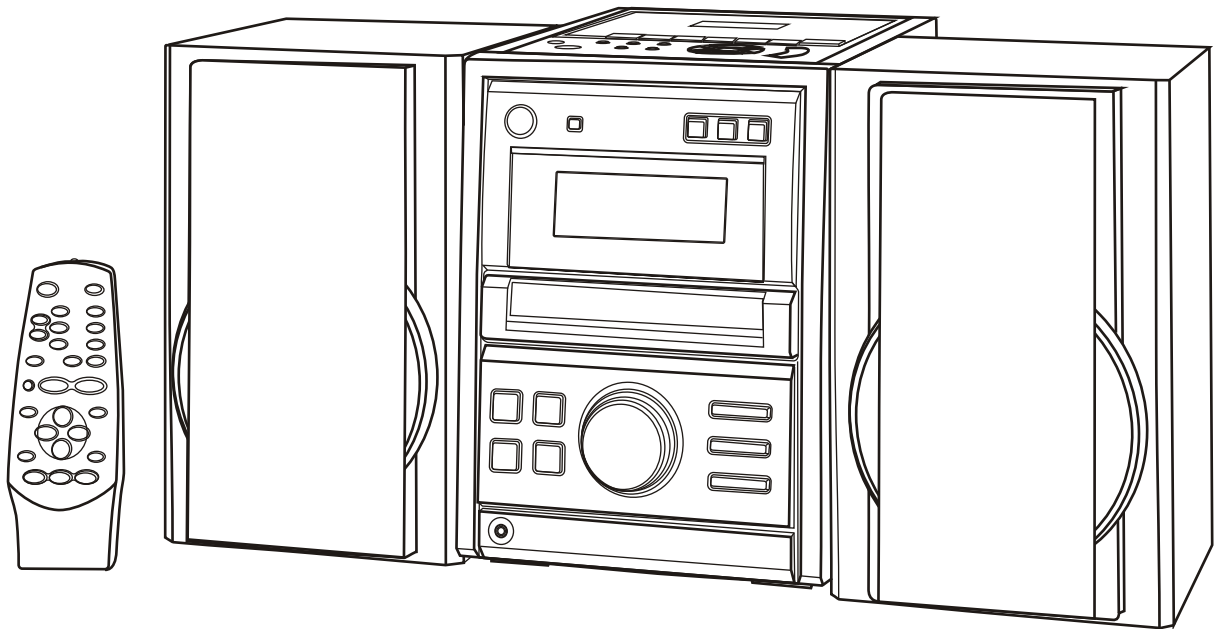

**Before operating this unit,  
please read this Owners manual carefully.**

## CONNECTIONS TO MAINS SUPPLY

This appliance may be fitted with a non-rewireable plug. If it is necessary to change the fuse in a non-rewireable plug the fuse cover must be refitted. If the fuse cover is lost or damaged, the plug must not be used until a replacement available from the appliance manufacturer is obtained. It is important that the colour of the replacement fuse cover corresponds with the colour marking on the base of the plug.

If the plug has to be changed because it is not suitable for your socket, or becomes damaged, it should be cut off and an appropriate plug fitted following the wiring instructions below. The plug removed must be disposed of safely as insertion into a 13A socket is likely to cause an electrical hazard.

For your own safety read the following instructions carefully before attempting to connect this unit to the mains.

### Mains (AC) Operation

This unit is designed to operate on 230V, 50 Hz current only. Connecting it to other power sources may damage the unit. The wires in this mains lead are coloured in accordance with the following code:

BLUE = NEUTRAL

BROWN = LIVE

### Important

As the colours of the wires in the mains lead of this appliance may not correspond with the coloured markings identifying the terminals in your plug, proceed as follows:-

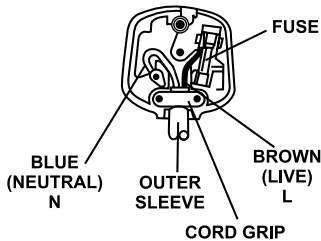

The wire which is coloured blue must be connected to the terminal which is marked with the letter L or coloured red.

The wire which is coloured brown must be connected to the terminal which is marked with the letter N or coloured blue.

No connection is to be made to the earth terminal of the plug.

If a 13 Amp (BS 1363) Plug is used, a 3 Amp Fuse must be fitted, or if any other type of Plug is used a 5 Amp Fuse must be fitted, either in the Plug, or on the Distribution Board.

### Caution

To prevent electric shock disconnect from the mains before removing cover. No user serviceable parts inside. Refer servicing to qualified service personnel.

### Safety Precaution

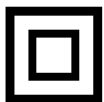

Do not allow this unit to be exposed to rain or moisture.

Mains Supply : 230 Volts 50 Hz – AC only.

This symbol means that this unit is double insulated. An earth connection is not required.

### CAUTION

CLASS I LASER PRODUCT

Use of Controls or adjustments or performance of procedures other than those specified herein may result hazardous radiation exposure.

### LASER SAFETY



This unit employs a laser, only qualified service personnel should attempt repair. DANGER : INVISIBLE LASER RADIATION WHEN OPEN AND INTERLOCK FAILED OR DEFEATED. AVOID DIRECT EXPOSURE TO BEAM.

CAUTION : HAZARDOUS LASER RADIATION WHEN OPEN AND INTERLOCK DEFEATED.

### CAUTION

CLEANING : Always disconnect unit from mains supply before attempting to clean it. Use soft cloth moistened with soapy water, wipe gently. Do not use solvents or abrasive materials.

# TABLE OF CONTENTS

<b>CONNECTIONS .....</b>	<b>3</b>
CONNECTIONS .....	3
ADJUSTING THE FM AERIAL .....	3
CONNECT THE MW AERIAL .....	3
SPEAKERS CONNECTION .....	3
<b>POWER SOURCE .....</b>	<b>4</b>
AC POWER SUPPLY .....	4
INSERTING BATTERIES INTO THE REMOTE CONTROL .....	4
<b>DISPLAY INFORMATION .....</b>	<b>4</b>
<b>GENERAL CONTROLS .....</b>	<b>5-6</b>
<b>BASIC FUNCTION .....</b>	<b>7</b>
DEMONSTRATION MODE .....	7
SWITCHING THE SYSTEM ON .....	7
SWITCHING THE SYSTEM TO STANDBY MODE .....	7
VOLUME CONTROL .....	7
SOUND CONTROL .....	7
<b>USING THE CD .....</b>	<b>8</b>
LOADING THE CD .....	8
PLAYING A NORMAL DISC .....	8
SELECTING A DESIRED TRACK/PASSAGE .....	8
PROGRAM TRACKS .....	8
RANDOM .....	9
REPEAT .....	9
<b>USING THE RADIO .....</b>	<b>10</b>
TUNING IN RADIO STATIONS .....	10
TUNING TO AN RDS STATION .....	10
STORING PRESET STATIONS .....	10
TUNING TO PRESET RADIO STATION .....	10
<b>USING THE CASSETTE .....</b>	<b>11</b>
UNDERSTANDING THE BUTTONS .....	11
PLAYING A CASSETTE TAPE .....	11
AUTOMATIC STOP FEATURE .....	11
RECORDING ON CASSETTE TAPES .....	11
RECORDING FROM THE RADIO .....	11
RADIO RECORDING TIPS .....	11
RECORDING FROM CD .....	11
RECORDING FROM CD PROGRAM .....	11
<b>CLOCK / TIMER OPERATION .....</b>	<b>12</b>
VIEW CLOCK .....	12
CLOCK SETTING .....	12
TIMER SETTING .....	12
<b>GENERAL INFORMATION .....</b>	<b>14</b>
MAINTENANCE .....	14
TROUBLE SHOOTING GUIDE .....	14
<b>IMPORTANT NOTES.....</b>	<b>15</b>

# CONNECTIONS

## CONNECTIONS

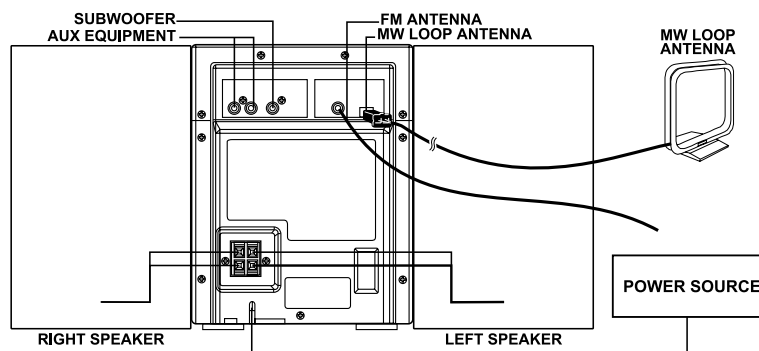

## ADJUST THE FM AERIAL

Adjust the position of the FM aerial for the best reception.

## CONNECT THE MW AERIAL

Connect the supplied MW loop aerial to the MW ANT input on back of the system. Adjust the position of the MW aerial for best reception.

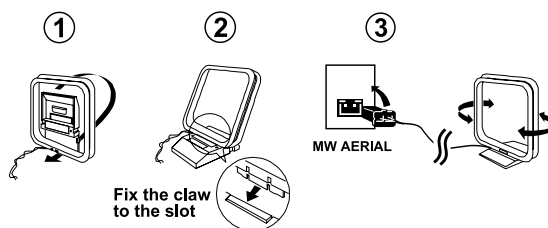

## SPEAKERS CONNECTION

- Connect the right speaker to terminal marked "R", with the red wire to + and the black wire to –.
- Connect the left speaker to terminal marked "L", with the red wire to + and the black wire to –.
- Clip the stripped portion of the speaker wire as shown.

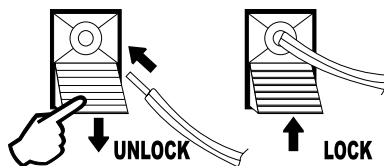

- Connect the subwoofer to terminal marked "SUBWOOFER OUT" jack. (Active Sub Woofer not included)
- Connect the external equipment to AUX IN jacks if necessary. (external equipment not included).

### Notes:

For optimal sound performance, it is recommended to use the supplied speakers.

Do not connect more than one speaker to any one pair of +/– speaker terminal.

## POWER SOURCE

### IMPORTANT!

Before connecting the AC power cord of the system to the wall outlet, you must remove the CD TRANSIT BOLT on the left side of the player.

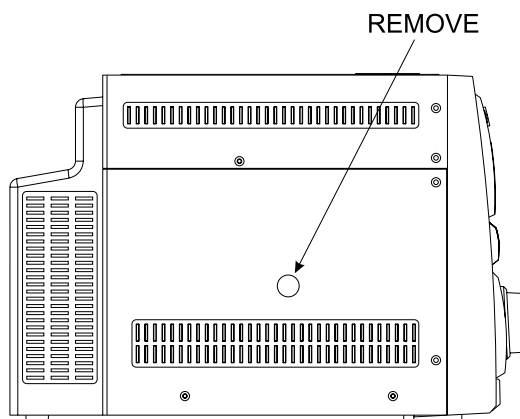

### AC POWER SUPPLY

After all other connections have been made. Connect the AC power cord of the system to the wall outlet. The system in standby mode will show the demonstration function.

### INSERTING BATTERIES INTO THE REMOTE CONTROL

Insert batteries (type LR03 or AAA) into the remote control as shown in the battery compartment.

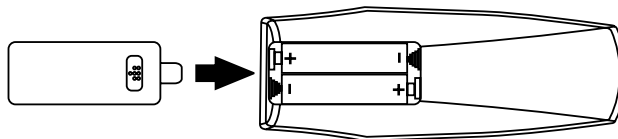

### CAUTION

- Replace batteries if the remote control fails to work.
- Remove batteries if they are exhausted or not to be used for a long time.
- Batteries contain chemical substances, so they should be disposed of properly.

## DISPLAY INFORMATION

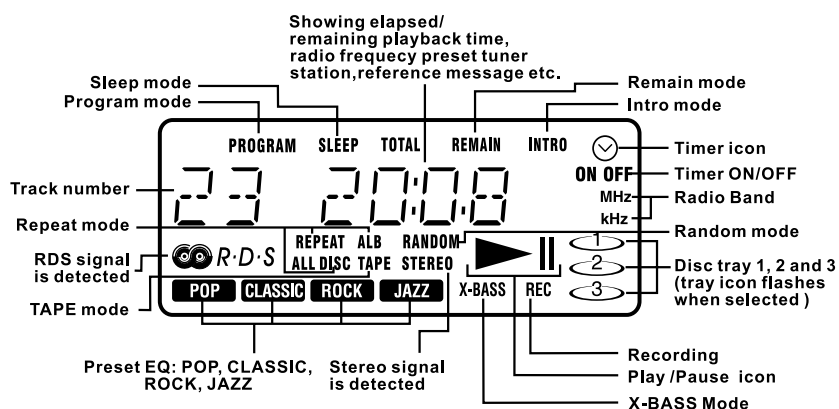

# GENERAL CONTROLS

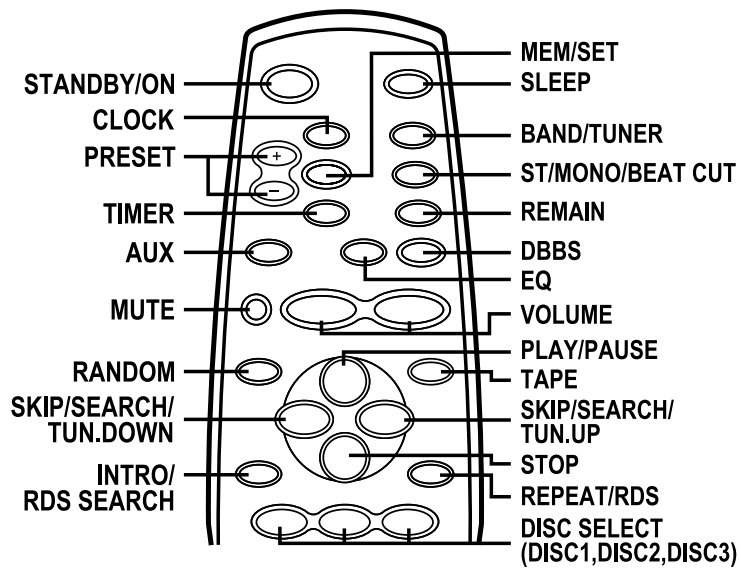
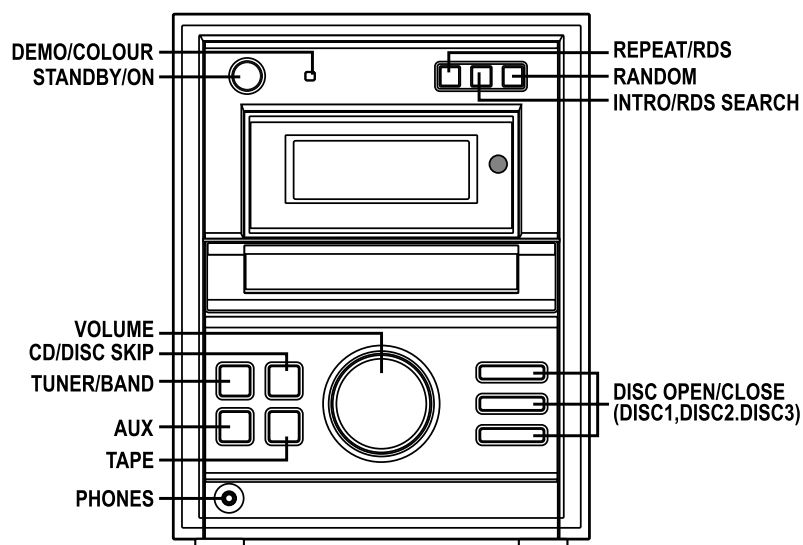
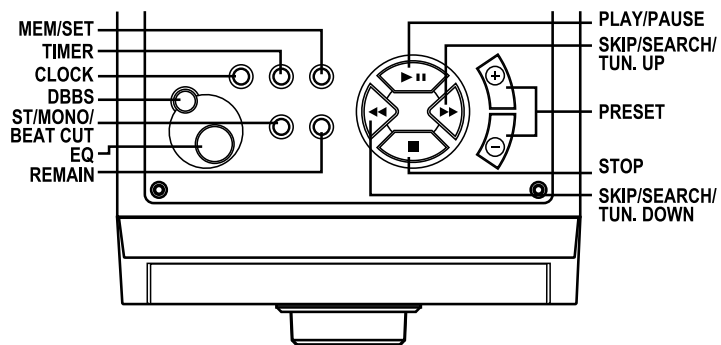

## GENERAL CONTROLS

**STANDBY/ON** – To exit the demo mode, switch the system on or turn the system to standby mode. Standby mode readies the system for remote use (power ON) and as a back-up to the systems clock/timer features.

**TUNER/BAND** – Press to select TUNER mode: when in TUNER mode, press to select the waveband: FM or MW.

**EQ** – Press to select the desired sound effect: POP, CLASSIC, ROCK, JAZZ or FLAT.

**DBBS** – Press to switch ON/OFF X-BASS mode.

**RANDOM** – When in CD mode, press to start or stop random play mode. This allows the CD to play all tracks in a random order (shuffle play).

**CD/DISC SKIP** – Press to select CD mode. When in CD mode, press repeatedly to change to desired disc tray.

**ST/MONO/BEAT CUT** – To switch between stereo/mono mode (on FM band only) for TUNER. To select the beat-cut function for MW recording.

**DEMO/COLOUR** – To activate/deactivate the demonstration for DEMO. Seven colours may be cycled on the display (as well as no back light).

**▲ / ▼ VOLUME** – To increase or decrease the volume (see display for range – 1 = Volume Minimum and 40 = Volume Maximum).

### ■ STOP –

1. Stop CD play.
2. Clears CD program from memory (when pressed twice).
3. Stop Program for Tuner

**◀◀ SKIP/SEARCH/TUN. DOWN** or **▶▶ SKIP/SEARCH/TUN. UP** – To search backward/forward or to skip to the previous/next track for CD. To tune to a lower or higher radio frequency or to search radio stations for TUNER.

### PRESET –

1. To select a preset radio station for TUNER.
2. To set the hour and minutes for Clock.
3. To set timer function for Timer.

**▶▶ PLAY/PAUSE** – To start or interrupt playback for CD.

**▶▶ (DISC 1, DISC 2, DISC 3)** – Press to directly play the selected disc.

**INTRO/RDS SEARCH** – Play the first 10 seconds of all songs on the selected CD. To search desired program type broadcast station.

**REPEAT/RDS** – Repeat CD play of 1 track or ALL tracks on the CD. To change RDS information.

### MEM/SET –

1. To program disc tracks for CD.
2. To program preset radio stations for TUNER.
3. To set or reset clock for Clock.
4. To set or reset timer for Timer.

**TIMER** – Press to switch the timer ON/OFF.

### CLOCK –

1. To view the clock during play mode of CD, tuner, or cassette.
2. To set the clock.
3. To set the timer.

**SLEEP** – To select the sleep time.

**COLOUR** – Select one of seven (7) colours (or no backlight) for your display background.

**REMAIN** – To select the CD time remaining.

**AUX** – To select the auxiliary input source or turn the system on AUX mode at standby mode.

**TAPE** – To select the TAPE mode or turn the system on TAPE mode from standby mode

**DISC OPEN/CLOSE (DISC 1, DISC 2, DISC 3)** – To select the DISC to open or close..

**MUTE** – To momentarily stop the sound press the MUTE button. To restore sound, press it a second time. MUTE feature only stops the sound, normal play continues.

### DEMONSTRATION MODE

The system has a demonstration that shows the various features offered by the system.

#### To activate the demonstration

- When in the standby mode, press DEMO/COLOUR button on the unit and the demonstration of the unit features will begin.

#### To deactivate the demonstration

- Press the DEMO button on the unit a second time to turn it off.
- Press the STANDBY/ON button on the unit. This will turn the system to the ON position and remove the DEMO Mode.

#### Note:

The demonstration function works only in standby mode.

### SWITCHING THE SYSTEM ON

- Press STANDBY/ON button or CD/TUNER/TAPE/AUX button and the STANDBY/ON led will illuminate.

### SWITCHING THE SYSTEM TO STANDBY MODE

- Press STANDBY/ON button. The clock will be displayed

### VOLUME CONTROL

Rotate the Volume control on the unit clockwise to increase or counter-clockwise to decrease. Press ▲ VOLUME UP button on the remote control to increase or ▼ VOLUME DOWN button on the remote control to decrease the volume level.

The volume ranges from the minimum of "1" (MIN VOL) to the maximum of "40" (MAX VOL) and is indicated on the display

#### To switch off the volume temporarily

Press MUTE button on the remote control.

Playback will continue without sound and "MUTE" will be flashed.

To restore the volume, press MUTE button again.

### SOUND CONTROL

#### EQ/X-BASS

The sound control system feature enables you to enjoy special sound effects that have preset equalizer settings, providing the best music reproduction.

#### Press EQ button

To select the desired sound effect : POP, CLASSIC, ROCK, JAZZ or FLAT.

#### To switch the X-BASS on/off

Press the DBBS button.

If Bass is switched on, "X-Bas ON" will appear on the display and then disappear in LCD and the icon "BASS" will appear on the display. If Bass is switched off, "X-Bas Off" will appear on the display and then disappear in LCD and the icon "BASS" will disappear on the display.



### LOADING THE CD

1. Press the CD function button.
2. Press DISC OPEN/CLOSE (DISC 1, DISC 2 or DISC 3) on the unit to open the CD door.
3. Place a CD into the tray with the label facing up.
4. To load other CDs, press a different DISC OPEN/CLOSE (DISC 1, DISC 2 or DISC 3) on the unit and place the CD in the disc tray.
5. Press the same DISC OPEN/CLOSE (DISC 1, DISC 2 or DISC 3) on the unit to close the CD door. The total playtime and total number of tracks will appear in the display.
6. To remove the CD, press the same DISC OPEN/CLOSE (DISC 1, DISC 2 or DISC 3) on the unit again, grasp the CD by its edges, and carefully pull it out.

### PLAYING A NORMAL DISC

1. Press ►►► PLAY/PAUSE button on the unit or on the remote control to start playback.  
The track number and elapsed playing time of the current track appear on the display.
2. To interrupt playback, press ►►► PLAY/PAUSE button on the unit or on the remote control.  
The playing time will start flashing.
3. To resume playback press ►►► PLAY/PAUSE button on the unit or on the remote control again.
4. To stop playback, press ■ STOP button on the unit or on the remote control.

### SELECTING A DESIRED TRACK/PASSAGE

#### To select a desired track

1. Press ◀◀◀ SKIP/SEARCH/TUN. DOWN or ▶▶▶ SKIP/SEARCH/TUN. UP button on the unit or on the remote control repeatedly until the desired track appears on the display.
2. If playback is stopped press ►►► PLAY/PAUSE button on the unit or on the remote control to start playback.

#### To search for a particular passage during playback

Press and hold ◀◀◀ SKIP/SEARCH/TUN. DOWN or ▶▶▶ SKIP/SEARCH/TUN. UP button on the unit or on the remote control and release it when the desired passage is located.

### PROGRAM TRACKS

Program tracks of disc are possible when the CD playback is stopped. Up to 60 tracks across all 3 disc compartments can be stored in the memory and in any order.

1. In stop mode, press MEM/SET button on the unit or on the remote control to enter program setting.  
"PROGRAM" will start flashing and "00 P--01" will show in the display.
2. Press CD-DISC SKIP button to select the desired disc.
3. Press ◀◀◀ SKIP/SEARCH/TUN. DOWN or ▶▶▶ SKIP/SEARCH/TUN. UP button on the unit or on the remote control to select the desired track. "PROGRAM P--01" will start flashing and your desired track number will show in the display.
4. Press MEM/SET button on the unit or on the remote control to store the select track. "PROGRAM" will start flashing and "00 P--02" will show in the display.
5. Repeat steps 1 to 4 to select and store all desired tracks in this way.  
"PROGRAM" and "Full" will start flashing in the display if you attempt to program more than 60 tracks.
6. Press ►►► PLAY/PAUSE button on the unit or on the remote control to play the programmed tracks.  
If you press REPEAT/RDS button during programmed playback, the current track or all programmed tracks will be played repeatedly.  
"REPEAT", "REPEAT DISC", or "REPEAT ALL" and "PROGRAM" will appear on the display.  
Press MEM/SET button on the unit or on the remote control in stop mode to view the CD programmed tracks.
7. Press ■ STOP button on the unit or on the remote control in stop mode to clear the program.  
"PROGRAM" will disappear from the display.

#### Notes:

The program is automatically cleared as soon as the CD compartment is opened.  
The function of program setting is disabling in PLAY/PAUSE mode.

### RANDOM

You can play all the CD's and tracks in random order.

1. During CD play, pause, or stop mode press the RANDOM button on the unit or remote control to enable random play mode. "RANDOM ALL DISC" will appear on the display.
2. Pressing the RANDOM button again and "RANDOM DISC" will appear in the display
3. To exit RANDOM mode, press the RANDOM button on the unit or the remote control until "RANDOM" disappears from the display.

#### Note:

If the RANDOM function is enabled, and the REPEAT DISC function is set on, the repeat function will disable the random play mode. RANDOM function will work when "REPEAT ALL DISC" is displayed.

### REPEAT

1. You can play the current track or the whole disc or all discs repeatedly.  
During CD playback or pause mode, press REPEAT/RDS button on the unit or remote control to select REPEAT ONE or REPEAT DISC or REPEAT ALL modes.  
REPEAT - to repeat the current track.  
REPEAT DISC- to repeat the current whole disc.  
REPEAT ALL - to repeat all discs.  
The current track, whole disc or all discs will now be played repeatedly until you press ■ STOP button.
2. To exit the repeat mode, press REPEAT/RDS button until the "REPEAT", "REPEAT DISC" or "REPEAT ALL" disappears from the display.

#### Notes:

In program mode, you can only select repeat one or repeat all function.

### Playing Tracks in the introduction

1. During stop, press INTRO/RDS SEARCH button on the unit or INTRO/RDS SEARCH button on the remote control. The "INTRO" indicator will show in LCD.
2. Press ►|| PLAY/PAUSE button to start playing from the first track.  
To cancel intro play, repress INTRO/RDS SEARCH button again.

#### Note:

Intro play lets you listen to the first 10 seconds of each track on the CD. When the last track has played for 10 seconds, the intro play stops.

## USING THE RADIO

### TUNING IN RADIO STATIONS

Fully unravel the FM wire aerial and connect the MW loop aerial to its socket.

1. Press TUNER/BAND button on the unit or on the remote control to select TUNER mode.
2. Press TUNER/BAND button on the unit or on the remote control to select the desired waveband: FM or MW.
3. Press and hold **◀◀ SKIP/SEARCH/TUN DOWN** or **▶▶ SKIP/SEARCH/TUN UP** button on the unit or on the remote control until the desired radio station is found. Pressing and holding the **◀◀ SKIP/SEARCH/TUN DOWN** or **▶▶ SKIP/SEARCH/TUN UP** for a few seconds will commence the search feature. The tuner will scan UP or DOWN the band frequencies to the next strongest station and lock on to it.
4. To tune to a weak station briefly press **◀◀ SKIP/SEARCH/TUN DOWN** or **▶▶ SKIP/SEARCH/TUN UP** button on the unit or on the remote control repeatedly until the display shows the desired frequency or when the best reception has been obtained.
5. Repeat this procedure until the desired station is reached.

### TUNING TO AN RDS STATION

1. Press TUNER/BAND button to select tuner mode.
2. Press TUNER/BAND button repeatedly to select FM.
3. Press and hold **◀◀ SKIP/SEARCH/TUN DOWN** or **▶▶ SKIP/SEARCH/TUN UP** button for a while for automatic station quick search.
4. If RDS station found, RDS icon will be shown in display.
5. Press the REPEAT/RDS repeatedly to display the frequency station name program type, radio text. If a station does not transmit PS, PTY or RT signals, the display will show " NO PS ", " NO PTY " or " NO TEXT " characters.

#### NOTE:

RDS stations broadcast on FM only. When the tuner detects an RDS signal, the RDS icon will show in the display. You can search stations on the following program types by pressing INTRO/RDS SEARCH button: NEWS (news), AFFAIRS (current affairs), INFO (weather, medical), SPORT (sports), EDUCATE (education), DRAMA (series and plays), CULTURE (religion), SCIENCE (science and technology), POP M (pop music), ROCK M (rock music), MOR M (middle of the road music), LIGHT M (light music), CLASSICS (classical music), OTHER M (unclassified music).

### STORING PRESET STATIONS

You can store up to 20 for FM and 20 for MW radio stations in the memory. When a preset radio stations selected. The preset number appears on the display.

#### MANUAL PROGRAM

1. Press TUNER/BAND button on the unit or on the remote control to TUNER mode.
2. Press TUNER/BAND button on the unit or on the remote control to select the desired waveband: FM or MW.
3. Press **◀◀ SKIP/SEARCH/TUN. DOWN** or **▶▶ SKIP/SEARCH/TUN. UP** button on the unit or on the remote control to tune to the desired station frequency.
4. Press MEM/SET button on the unit or on the remote control and "00" will start flashing in the display.  
The current preset number will be displayed for selection.
5. If you wish to store the radio station to another preset number, PRESET + button or PRESET – button on the unit or on the remote control to select the desired preset number.
6. Press MEM/SET button on the unit or on the remote control again to store the radio station.  
Repeat steps 3 to 6 to store other preset radio stations.

#### Note:

During program, if no button is pressed within 5 seconds, the system will exit program mode automatically.

### TUNING TO PRESET RADIO STATION

Press PRESET + button or PRESET – button on the unit or on the remote control to select the desired preset number. The preset number, radio frequency, and PROGRAM will appear on the display.

#### STEREO/MONO/BEAT CUT

Press ST/MONO/BEAT CUT button on the unit or on the remote control repeatedly to select mono or stereo mode.

When stereo mode is selected, "STEREO" will appear on the display (if current station is FM stereo).

BEAT CUT is used to stop whistle noise when recording from MW BAND

#### Note:

You are able to select mono or stereo mode in FM band only.

## USING THE CASSETTE

### UNDERSTANDING THE BUTTONS

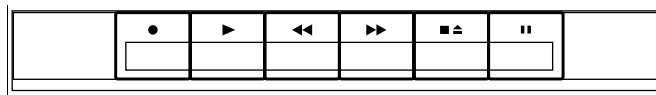

- **RECORD** – Press to record from the radio, CD player, or AUX source.
- ▶ **PLAY** – Press to play cassettes.
- ◀◀ **REWIND** – From stop mode, press to rewind the tape toward the beginning.
- ▶▶ **F.FWD** – From stop mode, press to advance the tape toward the end.
- / ▲ **STOP/EJ** – Press to stop current tape activity or to open the cassette compartment door when no buttons are activated.
- || **PAUSE** – Press to interrupt tape play or record mode. Press the second time to resume tape play or tape record mode.

### PLAYING A CASSETTE TAPE

1. Press TAPE button to TAPE.
2. Press ■ / ▲ STOP/EJ key to open the cassette compartment door.
3. Insert cassette tape into the compartment with the open edge facing up and the full reel on the right.
4. Close the door securely.
5. Press ◀◀ REWIND or ▶▶ F.FWD to move tape to the desired starting point.
6. Press ▶ PLAY key to begin playing the tape.
7. Press ▲ / ▼ VOLUME UP/DOWN, EQ and DBBS button to desired listening level.

### AUTOMATIC STOP FEATURE

When the cassette deck is operating in play or record mode and the end of the tape is reached, the unit automatically shuts itself off and returns all buttons to the off position.

### RECORDING ON CASSETTE TAPES

You can record from the radio or the CD player.

For best recording, use normal bias tape (Type 1 only).

### RECORDING FROM THE RADIO

1. Insert a cassette tape into the tape deck and close door.
2. Press TUNER/BAND button to TUNER and select a radio station.
3. Press ● RECORD key to begin recording. ● RECORD key and ▶ PLAY key lock down.
4. Press ■ / ▲ STOP/EJ key to end recording.
5. To turn off the radio, select another player mode (CD, TAPE, or AUX) or press the STANDBY/ON button.

#### NOTE:

PAUSE FOR A MOMENT - Using the || PAUSE key on the cassette deck instead of the ■ / ▲ STOP/EJ key to momentarily interrupt recording gives you a much cleaner recording.

### RADIO RECORDING TIPS

To temporarily pause the recording, press || PAUSE key on the cassette deck. Press || PAUSE key again to resume recording.

### RECORDING FROM CD

1. Insert a blank cassette tape into the tape deck.
2. Press CD-DISC SKIP button to CD.
3. Insert a CD and select the first track you want to record.
4. Press ● RECORD key and the ▶ PLAY key will automatically engage, the CD will also start to play automatically.
5. Press || PAUSE key to interrupt or edit recording. Press the second time to resume recording.
6. Press ■ / ▲ STOP/EJ key to end recording.

### RECORDING FROM CD PROGRAM

1. Follow steps in USING THE CD " PROGRAM TRACKS " to program your CD tracks into memory.
2. When CD program is entered, follow step 4 - 6 in RECORDING FROM CD to commence recording of your CD program.

**NOTE:** When the cassette side is full, the cassette will automatically stop and also pause the CD program. Open cassette door and flip over the cassette or insert new cassette. Press ● RECORD key and the ▶ PLAY key will automatically engage, the CD will also start to play automatically from point its program was paused.

### CLOCK

The clock (if it is set) will be shown in standby mode.

To view the clock in any source mode (CD or TUNER for example).

Press TIMER SET button. The clock will be displayed.

If the clock has not been set, "00:00" will start flashing.

### CLOCK SETTING

The clock can be set in 24-hour mode.

1. Press CLOCK button on the unit or on the remote control to select clock mode.
2. Press and hold MEM/SET button on the unit or on the remote control more than 0.8 second to select clock setting mode.

The hour indication will start flashing.

3. Press PRESET + button or PRESET – button on the unit or on the remote control to set the hours.
4. Press MEM/SET button on the unit or on the remote control to confirm the selection.

The minute indication will start flashing.

5. Press PRESET + button or PRESET – button on the unit or on the remote control to set the minutes.
6. Press MEM/SET button on the unit or on the remote control to store the setting.

The clock will start working.

7. To exit without storing the setting, turn on the system.

### TIMER SETTING

The system can switch on to CD or TUNER mode automatically at a preset time, serving as an alarm to wake you up.

### Important!

**Before setting the timer, ensure that the clock is set correctly.**

**The timer can only be activated from standby mode.**

1. Press CLOCK button on unit or on the remote control to display CLOCK.
2. Press CLOCK button on the unit or remote control again to select timer setting mode. "☉ ON" will flash on the display.
3. Press MEM/SET button on the unit or on the remote control to select the clock-setting mode.  
The hour indication will start flashing.
4. Press PRESET + button or PRESET – button on the unit or on the remote control to set the hours.
5. Press MEM/SET button on the unit or on the remote control to confirm the selection.  
The minute indication will start flashing.
6. Press PRESET + button or PRESET – button on the unit or on the remote control to set the minutes.
7. Press MEM/SET button on the unit or on the remote control to store the setting.
8. Repress CLOCK button on the unit or on the remote control once and repeat above 3-7 to set "☉ OFF" clock.
9. Repress CLOCK button on the unit or on the remote control once the last desired source "CD", "TUNER", "TAPE" or "AUX" will display. Then hold MEM/SET on the unit or on the remote control more than 0.8 second and the previous source "CD", "TUNER", "TAPE" or "AUX" will start flashing.
10. Press PRESET + button or PRESET – button on the unit or on the remote control to select the desired source.
11. Press MEM/SET button on the unit or on the remote control to confirm the selection.
12. Ensure the system is in the standby mode.

When the preset time is reached, the selected source will play or switch to standby mode if the timer has been activated.

### TO ACTIVATE/DEACTIVATE THE TIMER

Press TIMER button on the unit or on the remote control. If activated, "⌚" will appear on the display.

#### Notes:

The timer off will not be activated if the ON time and OFF time are the same.

If the selected source CD is not available when preset timer is reached, TUNER will be selected automatically.

### SLEEP TIMER SETTING

If the sleep timer is activated, the system will switch to standby mode after the selected time has expired.

1. Press and hold SLEEP button on the unit or on the remote control to select a sleep time.

The selections are as follows:

90-80-70-60-50-40-30-20-10

2. When you reach the desired length of time, stop pressing the SLEEP button.

"SLEEP" will appear on the display.

#### To deactivate the sleep Timer

Press SLEEP button on the unit or on the remote control again or press STANDBY/ON button on the unit or on the remote control until "SLEEP" is disappeared.

#### Notes:

If timer off and the sleep off are all activated, the system will switch to standby mode by the earlier time setting.

# GENERAL INFORMATION

## MAINTENANCE

### Cleaning the cabinet

- Use a soft cloth slightly moistened with a mild detergent solution. Do not use a solution containing alcohol, spirits, ammonia or abrasive.

### Cleaning discs

- When a disc becomes dirty, clean it with a cleaning cloth, wipe the disc from the center out. Do not wipe in circular motion.
- Do not use solvents such as benzene, thinner commercially available cleaners, or antistatic spray intended for analogue records.

### Cleaning the disc lens

- After prolonged use, dirt or dust may accumulate at the disc lens. To ensure good playback quality, clean the disc lens with CD lens cleaner or any commercially available cleaner: Follow the instructions supplied with cleaner.

### Cleaning the heads and tape path

- To ensure good recording and playback quality, clean the heads, the capstan(s) and pressure roller(s) after every 50 hours of tape operation.
- Use a cotton swab slightly moistened with cleaning fluid or alcohol.
- The heads may also be cleaned by playing a cleaning tape once.

### Demagnetizing the heads

- Use a demagnetizing tape available at your dealer.

## TROUBLE SHOOTING GUIDE

Check the following guide for problem resolution.

PROBLEM	POSSIBLE CAUSE	SOLUTION
<b>General</b>		
<b>No Sound</b>	AC cord is not plugged in.	Plug in AC cord securely.
	VOLUME control is at minimum.	Set the VOLUME control to proper sound level.
	Wrong source selected.	Make sure the source is set to the source you want to operate.
	Headphones plug inserted into the headphones jack.	Pull out the headphones plug from the headphones jack.
<b>CD Player</b>		
<b>Disc Is Inserted but Tracks Are Not Displayed</b>	Disc is inserted upside-down.	Insert disc correctly (label up).
	Disc is dirty.	Wipe clean with soft cloth.
	Disc is scratched.	Use a new disc.
	Disc is seriously warped.	Use a new disc.
	Moisture has formed inside the CD deck.	Take out the CD and leave the CD Player open for about an hour to dry.
<b>Certain Sections of Disc Are Not Played Normally</b>	Disc is dirty.	Wipe clean with soft cloth.
	Disc is scratched.	Skip over scratched sections (if necessary); otherwise, replace the disc.
<b>Radio</b>		
<b>Noise in Radio Reception</b>	Station has not been tuned properly.	Tune to correct frequency.
	FM reception is weak.	Adjust the direction of the FM Antenna.
	MW reception is weak.	MW antenna is built-in; rotate the system to face a new direction.
<b>Cassette Deck</b>		
<b>Unsteady Tape Sound</b>	Capstan is dirty.	Clean the capstan.
	Irregular cassette tape winding.	Replace tape.
<b>Cannot Record</b>	Cassette's erasure prevention tabs are broken out.	Replace tape or cover tabs with adhesive tape.
<b>Recorded Tape Sound Is Distorted</b>	Dirty head.	Clean head.
	Faulty cassette tape.	Replace cassette tape.
<b>High Frequency of Tape Sound Is Weak</b>	Dirty head.	Clean head.
<b>Remote Control</b>		
<b>Does Not Function Properly</b>	Batteries are weak.	Replace the batteries.
	Obstacles are in the path between the remote control and the system.	Remove the obstacles.
	Interference from strong light (e.g. direct sunlight, fluorescent lighting).	Change the light in the room.
	Too far from Remote Sensor.	Move closer to the system when using the remote control and make sure that you are pointing at the unit's Remote Sensor.

## IMPORTANT NOTES

Hearing is very important to you and to us so please take care when operating this equipment. It is strongly recommended that you follow the listed guidelines in order to prevent possible damage or loss of hearing.

### ESTABLISH A SAFE SOUND LEVEL

- Over time your hearing will adapt to continuous loud sounds and will give the impression that the volume has in fact been reduced. What seems normal to you may in fact be harmful.
- To guard against this **BEFORE YOUR HEARING ADAPTS** set the volume at a level. Slowly increase the level until you can hear comfortably and clearly and without distortion.
- Damage to your hearing is accumulative and is irreversible. Any ringing or discomfort in the ears indicates that the volume is too loud.
- Remember listening for prolonged period of time at high volume levels will harm your hearing.

**Once you have established a comfortable listening level, DO NOT INCREASE THE SOUND LEVEL FURTHER.**

The following list of typical sound levels may assist you in recognizing just how loud you have set the volume level.

#### DECIBEL

Level (dB)	Example
30dB	Quiet library, soft whisper.
40dB	Living room, fridge freezer bedroom away from traffic.
50dB	Normal conversation, quiet office, light traffic.
60dB	Electric sewing machine.
70dB	Vacuum cleaner, hair dryer, noisy restaurant.

### THE FOLLOWING NOISE CAN BE HARMFUL UNDER CONSTANT EXPOSURE

80dB	Average city traffic, alarm clock buzzer at 2 feet, food mixer.
90dB	Motorcycle, heavy goods vehicle petrol lawn mower.
100dB	Pneumatic drill, chain saw, garbage truck, discotheque/night-club.
120dB	Rock band concert, thunderclap fast train passing by.

### PERMANENT LOSS OF HEARING

140dB	<b>THRESHOLD OF PAIN</b> Gunshot 2 feet away, jet plane taking off.
-------	---