

Goodmans

MICRO1109IP

CD Micro System with iPod Docking Station

User Guide

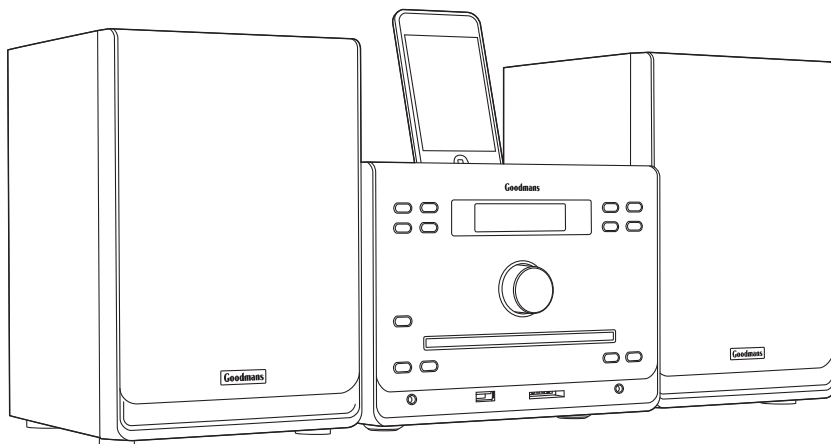

IMPORTANT: Please read all instructions carefully before use and keep for future reference

Introduction

Thank you for choosing this CD Micro System with iPod Docking Station. Not only can you listen to all your favourite tracks on your iPod, but you can also listen to FM and MW Radio and play music from CDs.

It's really simple to use: you can fully operate your iPod directly from the control panel or from the Remote Control. You can even connect auxiliary devices to it.

Throughout this User Guide, the CD Micro System with iPod Docking Station will be referred to as the Micro System.

Safety is important

Use of any electrical equipment should be undertaken with care. Please read the safety section on pages 20 to 22 before using this Micro System. This appliance is for household use only.



An audio system that allows docking of an iPod and which fully supports the iPod menu system.



The Micro System features a CD player allowing playback of all your CD, CD-R and CD-RW discs.



The Micro System can playback music from USB, SD and MMC storage media.

What's in the box?

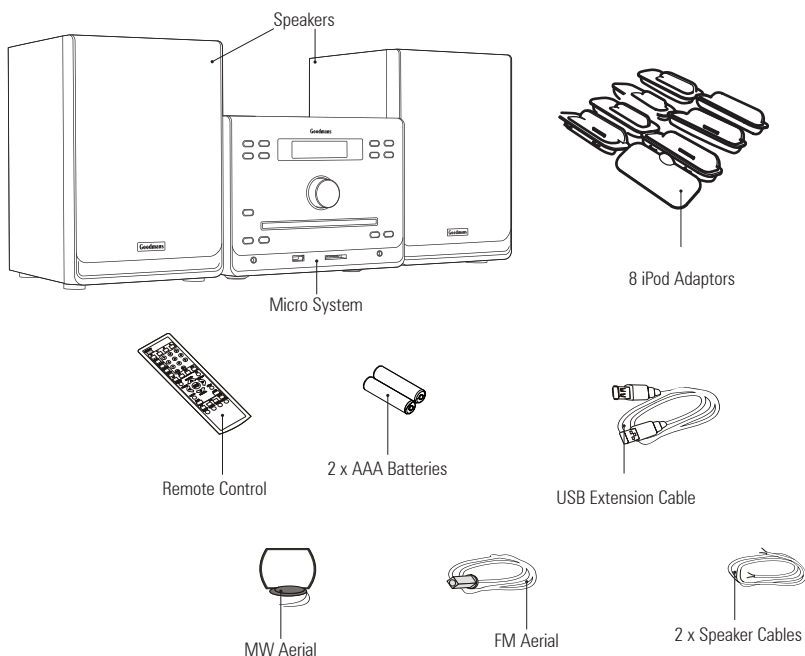

The above images are for illustrative purposes only and may differ to the items supplied.

Contents

01 Your Micro System.....	4	08 Clock and Timer.....	15
02 Getting Started.....	6	09 Troubleshooting.....	16
03 Daily Use	8	10 Specifications.....	19
04 MW and FM Radio	9	11 Warnings.....	20
05 iPod Docking.....	10	12 Electrical Information.....	22
06 CD Playback	11	13 Guarantee	23
07 USB and Card.....	14		

01 Your Micro System

Front view

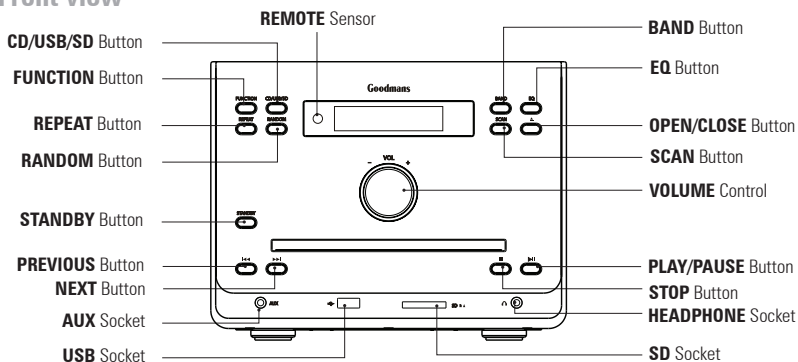

Top view

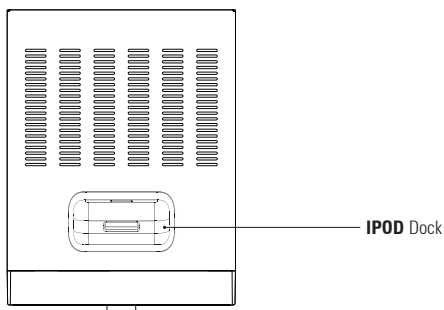

Rear view

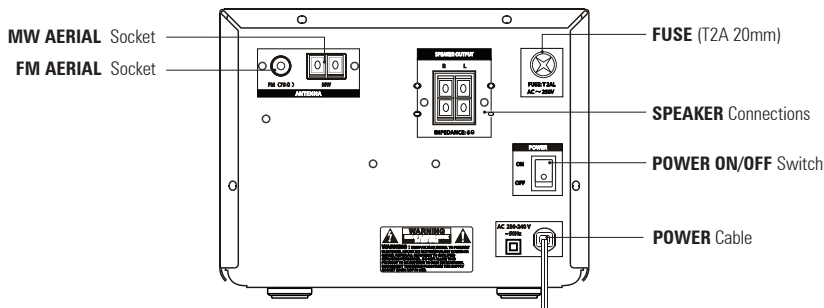

Remote Control

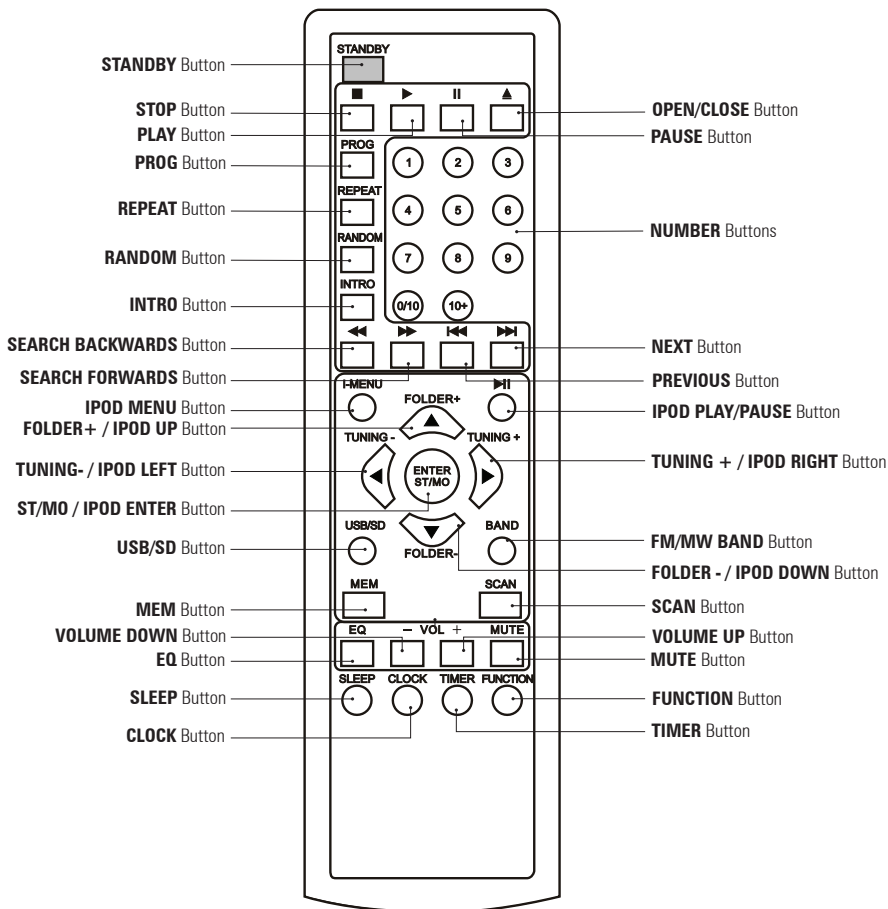

02 Getting Started

1

Connecting up

Connect the left and right speakers to the Micro System. The black and white wires should be connected to the red sockets and the black wires to the black sockets on the rear of the Micro System.

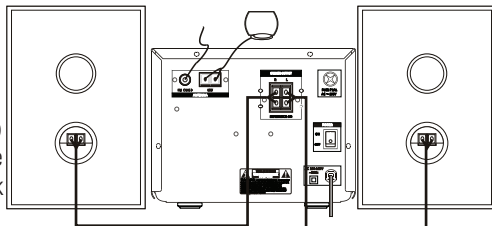

Connect the FM and MW aerials to the sockets on the back of the Micro System.

Switch On the Power after **ALL** connections have been made.

2

Using the Remote Control

Insert the batteries (supplied) into the Remote Control, observing the polarity marked.

To use the Remote Control, simply direct it towards the front of the Micro System and press the desired buttons.

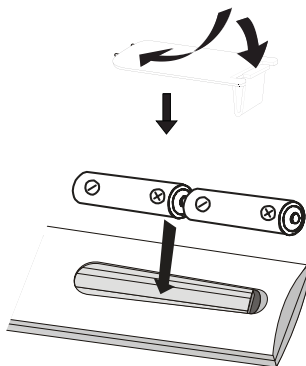

DON'T FORGET! When replacing the batteries make sure that you use the same size and type.

3

Connecting to External Devices

The Micro System can be connected to a number of external devices using the Aux Socket on the front of the Micro System. This requires a 3.5 mm Stereo Cable (not supplied).

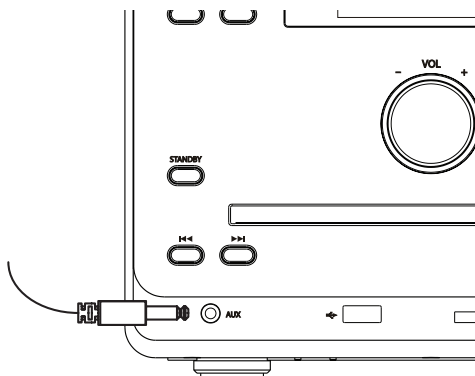

4

Turn the Micro System On

Insert the plug into the wall socket and turn the socket on.

Press the **STANDBY** button on the front of the Micro System or the Remote Control to turn the Micro System On.

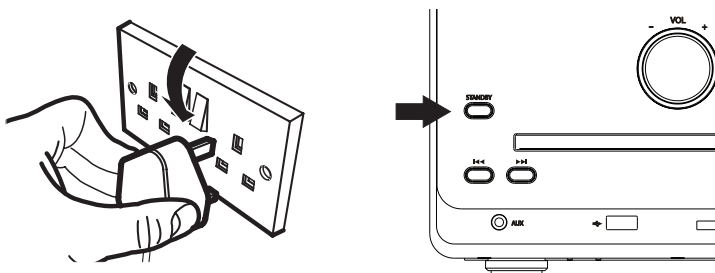

Switching On

- ❶ To turn the Micro System on, press the **STANDBY** button.
- ❷ To turn the Micro System off, press the **STANDBY** button again.

Adjusting the Volume

- ❶ To increase the volume, rotate the **VOLUME CONTROL** on the front of the Micro System clockwise or press the **VOL +** button.
- ❷ To decrease the volume, rotate the **VOLUME CONTROL** anti-clockwise or press the **VOL -** button.
- ❸ You can also press the **MUTE** button to turn the sound off. Press the **MUTE** button again to turn the sound back on again.

Preset Equaliser (EQ)

The range of sound can be adjusted to suit the different types of music that you are listening to, by changing the preset equaliser settings.

- ❶ To select the Equaliser type, press the **EQ** button on the Remote Control repeatedly until the desired type appears on the display.

The available settings are:

- FLAT
- MONITOR
- ARENA
- STUDIO
- CLUB

Mode Selection

The Micro System has the following modes of operation:

- CD
- USB/SD card
- FM
- MW
- iPod
- Auxiliary

- ❶ To select a mode, repeatedly press the **FUNCTION** button on the Micro System. The Micro System will cycle through the available modes. The currently selected mode will be shown on the display.
- ❷ Alternatively, press the **FUNCTION** button on the Remote Control.

Selecting Radio Mode:

- 1 Press the **STANDBY** button.
- 2 Press the **FUNCTION** button to select Tuner mode.
- 3 Press the **BAND** button to select either MW or FM.

Scanning for Stations:

- 1 To automatically search for the next available station, press the **TUNING +** button. The Micro System will automatically search for the next available radio station.
- 2 To search for another station, press the **TUNING -** or **TUNING +** button again.

Presetting Stations:

The preset function allows you to store your favourite MW and FM stations for easy access. You can preset up to 30 FM stations and 20 MW stations.

- 1 When in FM mode, use the **TUNING -** or **TUNING +** buttons to scan for the radio station you want to preset.
- 2 Press and hold the **MEM** button to enter store mode.
- 3 Press the **FOLDER -** or **FOLDER +** buttons to select the memory location where you want to store the station.
- 4 Press the **MEM** button again to store the station.

DON'T FORGET! Repeat the previous steps to store your other favourite stations.

DON'T FORGET! If you select a preset number that is already preset with a station, the existing station will be replaced with the new one.

Selecting a Preset Station:

- 1 Press the number buttons to select a preset station.

Stereo / Mono Sound:

You can select stereo or mono sound while listening to the FM radio.

- 1 To switch between stereo or mono sound types, press the **ENTER ST/MO** button.
- 2 The display will show "STEREO" when in Stereo mode.

Any iPod can be connected to the Micro System allowing all your favourite songs to be played through the Micro System's speakers. The iPod can be completely controlled by the Micro System and charges when docked.

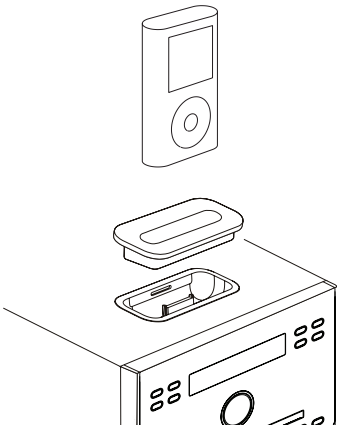

- ❶ To connect an iPod to the Micro System, select the compatible adaptor from one of the 8 iPod adaptors supplied. The iPod adaptors have markings on the bottom which clearly identify which iPod they should be used with.

DON'T FORGET! If your iPod is not compatible with any of the supplied iPod adaptors, use the adaptor supplied with your iPod.

- ❷ Place the iPod adaptor into the recess on the top of the Micro System and then insert your iPod into the adaptor.
- ❸ To disconnect the iPod, turn it off and disconnect it from the dock.

DON'T FORGET! Your iPod will charge while docked when the Micro System is in Standby Mode.

The following instructions describe how to operate an iPod when it is connected to the Micro System using the Remote Control.

Selecting iPod Mode:

- ❶ Press the **STANDBY** button.
- ❷ Press the **FUNCTION** button until iPod is selected.
- ❸ To start playback, press the **IPOD PLAY/PAUSE** button.

Menu Navigation:

- ❶ To access the iPod menu system, press the **I-MENU** button.
- ❷ Use the **▲** or **▼** buttons to highlight the menu options.
- ❸ Press the **ENTER ST/MO** button to select a menu option.

Compatible Disc Types:

This Micro System supports playback of the following types of CD:

- 8cm/12cm Compact Disc Audio Discs
- 12cm Compact Disc Recordable Discs
- 12cm Compact Disc Re-Writable Discs



Compatible Audio Formats:

This Micro System supports the playback of the following audio formats:

- MP3

DON'T FORGET! The following instructions describe how to play CDs using the Remote Control.

Playing CDs

Loading CDs:

DON'T FORGET! The Micro System should read the disc information and start playback automatically. As MP3 discs contain much more information than normal CDs, the Micro System may take longer to read information from them. This is completely normal and is not an indication of any problems with the Micro System.

- 1 Press the **STANDBY** button.
- 2 Press the **FUNCTION** button until CD is selected.
- 3 Press the **OPEN/CLOSE** button to open the CD compartment.
- 4 Place the CD in the compartment with the label side facing upwards.
- 5 Press the **OPEN/CLOSE** button to close the CD compartment.
- 6 When fully closed, the Micro System starts to spin the disc.
- 7 Playback will start automatically.

CD Playback:

- 1 Press the ► button to start playback of the CD.
- 2 Press the || button to pause playback. Press the ► button again to continue with playback of the CD.
- 3 Use the ►► button to forward skip to the next track.

DON'T FORGET! If you are on the last track of the disc, the player will return to track 1.

- 4 Use the ◀◀ button to reverse skip to the beginning of the current track.

- 5 Press the numeric buttons (0-9) to directly input the track number and start playback from the selected track.
- 6 To fast forwards or backwards through a track, press and hold the ◀◀ or ▶▶ buttons to select 2X, 4X, 8X and 20X speed. To cancel and resume normal playback press the ▶ button.
- 7 Press the ■ button to stop playback.

Repeated or Random CD Playback

Repeated CD Playback :

You can repeat a single track, all tracks, or a whole folder. The following repeat modes are available:

- REPEAT ONE - repeats a single track.
- REPEAT ALL - repeats all the tracks on the CD.
- REPEAT FOLDER - repeats all the tracks in a folder. (MP3 CDs only).

To repeat a single track:

- 1 Select a track and then press the ▶ button.
- 2 Press the **REPEAT** button repeatedly until REPEAT ONE is displayed.
- 3 The selected track will play continuously until you press the ■ button.

To repeat all the tracks on a CD:

- 1 Select a track and then press the ▶ button.
- 2 Press the **REPEAT** button repeatedly until REPEAT ALL is displayed.
- 3 The entire CD will play continuously until you press the ■ button.

To repeat a Folder MP3 CD:

- 1 Select a track and then press the ▶ button.
- 2 Press the **REPEAT** button repeatedly until REPEAT FOLDER is shown on the LCD Screen.
- 3 The selected folder plays continuously until you press the ■ button.

To cancel the repeat function

- 1 Press the **REPEAT** button repeatedly until REPEAT OFF is displayed.

Random Play:

The tracks or files on the CD can be played in a random order.

- 1 Press the **RANDOM** button to turn on the random mode. RANDOM ON will be displayed.
- 2 Press the **RANDOM** button again to turn off the random mode.

Program Track Selection

You can program the micro system to play up to a total of 99 tracks/files in any desired order. You can also program the same track/file to play several times within a program sequence.

- ❶ While in CD mode, press the ■ button to stop any CD playback.
- ❷ Press the **PROG** button. 000 P-01 will be displayed.
 - P01 - stands for the first program location.
 - 001 - is the track or file number.
- ❸ Select the track or file for the first program location using the ◀◀ and ▶▶ buttons.
- ❹ Press the **PROG** button to store the selected track/file in the first program location.
- ❺ Repeat steps 3 and 4 to program more tracks or files.
- ❻ Once you have selected all the tracks, press the ▶ button to start playback.

DON'T FORGET! Playback will stop after all track/files have been played.

- ❼ To cancel the sequence from the memory, press the ■ button during playback.

This feature lets you playback MP3 files stored on a USB device or a SD/MMC card.

DON'T FORGET! Only MP3 format (without Digital Rights Management (DRM)) can be played back using the USB and CARD modes.

Compatible storage devices:

This Micro system supports playback of music from the following devices:

- USB Flash Drives
- Secure Digital TM (SD)
- Mini SD TM (with adapter only)
- Micro SD TM (with adapter only)
- Multimedia Card (MMC)

DON'T FORGET! Do not attempt to insert media storage other than those indicated above. This may cause damage to the memory card or the card slot in the Micro system. This feature is designed to play media from SD/MMC card devices and from USB flash memory devices that comply with the USB Mass Storage Standard. Playback of media from USB connected devices such as MP3 players that generally require drivers for interaction with a PC is not supported.

USB or SD/MMC Playback Operations:

Accessing the USB or CARD mode:

- 1 Press the **STANDBY** button to turn on the Micro system.
- 2 Press the **FUNCTION** button until CD is displayed.
- 2 Press the **USB/SD** button.

Connecting USB or SD/MMC card devices:

- 1 Insert a USB device or an SD/MMC card gently into the connector or card slot at the front of the Micro system.

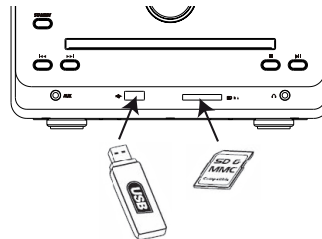

- 2 When you insert the USB or SD/MMC card, the Micro system will start reading the MP3 files. Once the Micro system has finished reading all the files, it will show the total number of files. Playback will start automatically.

DON'T FORGET! You can use the same program, repeat and random functions when using a USB or SD/MMC card.

Setting the clock

The Micro System has a clock which operates in 24 hour mode.

- ❶ Press and hold the **CLOCK** button on the Remote Control until the display shows 'CLOCK SET'.
- ❷ When the hour digits are flashing use the ◀◀ or ▶▶ buttons to set the hour.
- ❸ To set the minutes press the **CLOCK** button.
- ❹ When the minute digits are flashing use the ◀◀ or ▶▶ buttons to set the minutes.

DON'T FORGET! The time will be reset when the Micro System is switched off using the power switch on the back of the unit.

Using the Sleep function

The Micro System has a sleep function which will switch the Micro System to standby after a set period of time.

- ❶ Repeatedly press the **SLEEP** button on the Remote Control to select the time you want. You can choose between 90 minutes and 10 minutes, in 10 minute intervals.
- ❷ When the time has elapsed the Micro System will switch off.
- ❸ To cancel the sleep timer, press the **SLEEP** button on the Remote Control until the sleep indicator is not shown on the display.

Using the Timer function

The Micro System has a timer function which will switch the Micro System on at a set time.

DON'T FORGET! You need to set the clock before setting the timer.

- ❶ Press and hold the **TIMER** button on the Remote Control until the display shows 'TIMER ON SET'.
- ❷ When the hour digits are flashing use the ◀◀ or ▶▶ buttons to set the hour.
- ❸ To set the minutes press the **TIMER** button.
- ❹ When the minute digits are flashing use the ◀◀ or ▶▶ buttons to set the minutes.
- ❺ Press the ◀◀ or ▶▶ buttons to select between iPod, CD or Radio.
- ❻ Press the **TIMER** button again to set the volume.
- ❼ Press the **TIMER** button on the Remote Control. The display shows 'TIMER OFF SET'.
- ❽ Use the same procedure as setting the start time, to set the off time.
- ❾ To activate the timer press the **TIMER** button until 'ENABLED' is displayed. Then press the **STANDBY** button.

DON'T FORGET! To cancel the timer press the **TIMER** button until 'TIMER FUNCTION DISABLED' is displayed.

General

Problem	Possible Cause	What to do
No Power	<ol style="list-style-type: none"> 1. The plug is not plugged into the wall socket. 2. The wall socket is not turned on. 	<ol style="list-style-type: none"> 1. Ensure the plug is plugged into the wall socket. 2. Turn on the power at the wall socket.
The Micro System is not responding to the Remote Control	<ol style="list-style-type: none"> 1. The Micro System is switched off at the wall socket. 2. The Remote Control is not directed at the Micro System. 3. The front of the Micro System is obstructed. 4. The Remote Control batteries are exhausted. 5. The Remote Control batteries are incorrectly inserted. 	<ol style="list-style-type: none"> 1. Turn on the power at the wall socket. 2. Direct the Remote Control towards the Micro System. 3. Ensure there are no objects obstructing the Micro System. 4. Replace the batteries in the Remote Control. See page 6 for more information. 5. Ensure the batteries are correctly inserted into the Remote Control. See page 6 for more information.
No sound is heard	<ol style="list-style-type: none"> 1. The volume is on the minimum setting. 2. The volume is muted. 3. Headphones are connected to the Micro System. 	<ol style="list-style-type: none"> 1. Increase the volume. 2. Press the MUTE button to restore the sound. 3. Remove the headphones.
All buttons fail to function	<ol style="list-style-type: none"> 1. A hardware error has occurred. 	<ol style="list-style-type: none"> 1. Perform a hardware reset by switching off the power on the rear of the Micro System. Wait 60 seconds and then switch it back on again.

CD

Problem	Possible Cause	What to do
The CD does not play	<ol style="list-style-type: none"> 1. The CD is incorrectly loaded. 2. The CD is an unsupported format. 3. The CD is paused. 4. The Micro System is not in the CD mode. 5. The CD is dirty or scratched. 	<ol style="list-style-type: none"> 1. Ensure the CD is correctly loaded into the CD Tray. See page 11 for more information. 2. Check the format of the CD is supported. 3. Press the II button to continue playback of the CD. 4. Press the FUNCTION button on the Remote Control. 5. Make sure the CD is not dirty or scratched. If it is dirty, clean the CD.
CD Sound Skips	<ol style="list-style-type: none"> 1. The CD is dirty. 2. The CD is warped or scratched. 	<ol style="list-style-type: none"> 1. Clean the CD with a soft cloth. 2. The CD should be replaced.

Radio

Problem	Possible Cause	What to do
The Micro System will not receive any radio stations	<ol style="list-style-type: none"> 1. There is a poor signal in the area. 2. There is electrical interference in the area. 	<ol style="list-style-type: none"> 1. Reposition the Micro System. 2. Reposition the Micro System.
The Micro System will not receive any FM radio stations	<ol style="list-style-type: none"> 1. The FM antenna is not connected. 	<ol style="list-style-type: none"> 1. Connect the FM antenna and position vertically. See page 6 for more information.

USB or SD/MMC

Problem	Possible Cause	What to do
Files will not playback from a USB device or the Card	<ol style="list-style-type: none">1. The USB device or the Card are not connected properly.2. Unsupported files.	<ol style="list-style-type: none">1. Make sure the USB device or card is securely connected. See page 14 for more information.2. Only MP3 file types are supported. See page 14 for more information.

General	
Model Number	• MICRO1109IP
Power Supply	• 230-240V AC 50~Hz
Power Consumption: Standby Operating	<ul style="list-style-type: none"> • 10 watts • 55 watts
Power Output	• 2 x 10 Watts RMS
Dimensions without Speakers	• 200mm (W) x 260mm (D) x 150mm (H)
Weight	• 3.75 kg
Tuner	
Radio Frequency Coverage: FM MW	<ul style="list-style-type: none"> • 87.5 MHz to 108 MHz • 522 KHz to 1620 KHz
CD	
Playback formats	• CD, CD-R and MP3
USB / Card	
Supported memory size	• Up to 2 Gb
Playback formats	• MP3

IMPORTANT: Due to continual revision and improvements to our products design, specifications are subject to change without notice.

WEEE



This appliance is labelled in accordance with European Directive 2002/96/EG concerning used electrical and electronic appliances (Waste Electrical and Electronic Equipment - WEEE). The guideline determines the framework for the return and recycling of used appliances.

Sound levels

Your hearing is very important to you and to us, so please take care when using this Micro System. It is strongly recommended that you follow the listed guidelines in order to prevent possible damage or loss of hearing.

Establish a safe sound level

Over time your hearing will adapt to continuous loud sounds and will give the impression that the volume has in fact been reduced. What seems normal to you may in fact be harmful. To guard against this **before your hearing adapts**, set the volume to a low level.

Slowly increase the level until you can hear comfortably and clearly and without distortion. Damage to your hearing is accumulative and is irreversible. Any ringing or discomfort in the ears indicates that the volume is too loud.

Once you have established a comfortable listening level, **do not increase the sound level.**

General Safety

This Micro System has been designed and manufactured to meet European safety standards, but like any electrical equipment, care must be taken if you are to obtain the best results and safety is to be assured.

Do read these operating instructions before you attempt to use the Micro System.

Do ensure that all electrical connections (including the mains plug, extension leads and interconnections between pieces of equipment) are properly made in accordance with the manufacturer's instructions.

Switch off and remove the mains plug when making or changing any connections.

Do consult your dealer if you are ever in doubt about the installation, operation or safety of your Micro System.

Don't continue to operate the Micro System if you are ever in doubt about it working normally, or if it is damaged in any way. Switch it off withdraw the plug from the mains and consult your dealer.

Don't remove any fixed covers as this may expose you to dangerous voltages.

Don't leave the Micro System switched On when it is unattended for long periods of time, unless it is specifically stated that it is designed for unattended operation or has a standby mode.

Make sure that other people in your household are conversant with the Micro System.

Don't obstruct the ventilation vents on the Micro System, for example with curtains or soft furnishings.

Overheating will cause damage and shorten the life of the product.

Don't allow electrical equipment to be exposed to rain or moisture.

Store the Micro System in a clean, dry environment.

Do not use any cleaning solutions on the Micro System.

This Micro System is fitted with a BS1363/A 13 amp plug. If it is not suitable for your supply sockets it must be removed and replaced with an appropriate plug. If the plug becomes damaged and/or needs to be replaced please follow the wiring instructions below. The plug removed must be disposed of immediately. It must not be plugged into a supply socket as this will be an electrical hazard. If the fuse needs to be replaced it must be of the same rating and ASTA approved to BS1362. If the plug is changed, a fuse of the appropriate rating must be fitted in the plug, adapter or at the distribution board. If the fuse in a moulded plug is replaced, the fuse cover must be refitted before the appliance can be used.

Wiring Instructions

The supply cable will be either 2-core or 3-core. Follow the appropriate wiring instructions given below. In both cases ensure that the outer sheath of the cable is firmly held by the cable clamp.

2- Core plug

⚠ WARNING: Do not connect either wire to the earth terminal.

 This symbol indicates that this 2-core appliance is Class II and does not require an earth connection.

The wire coloured blue must be connected to the terminal marked with the letter N or coloured black.

The wire coloured brown must be connected to the terminal marked with the letter L or coloured red.

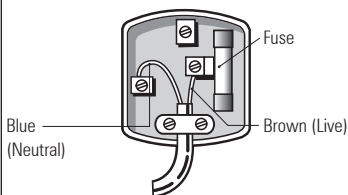

3- Core plug

⚠ WARNING: This appliance must be earthed.

The wire coloured green and yellow must be connected to the terminal marked with the letter E, or by the earth symbol , or coloured green or green and yellow.

The wire coloured blue must be connected to the terminal marked with the letter N or coloured black.

The wire coloured brown must be connected to the terminal marked with the letter L or coloured red.

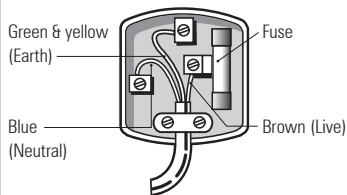

The Micro System is guaranteed for twelve months from the date of original purchase. If any defect due to faulty materials or workmanship, contact the Goodmans Helpline. Have your receipt of purchase on hand.

The guarantee is subject to the following provisions:

- It is only valid within the boundaries of the country of purchase.
- The product must be correctly installed and operated in accordance with the instructions contained in this User Guide.
- The Micro System must be used solely for domestic purposes.
- The guarantee will be rendered invalid if the Micro System is re-sold or has been damaged by inexpert repair.
- The manufacturer disclaims any liability for incidental or consequential damages.
- The guarantee is in addition to, and does not diminish, your statutory or legal rights.

Goodmans

MICRO1109IP-241008-Rev1