

Goodmans

Alarm Clock Radio CD Player

GCDR1896

Instruction Manual

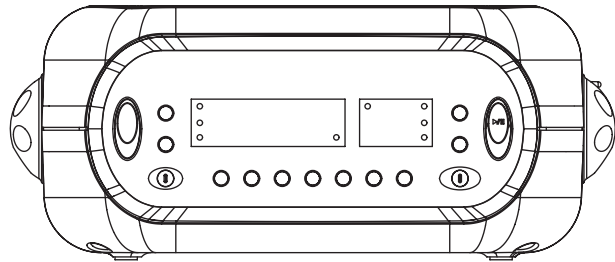

IMPORTANT SAFEGUARDS

PRE FITTED MAINS PLUGS

For your convenience a mains plug has been fitted to this appliance. For your safety please observe the following information.

1. Should the fuse in the plug remove the plug from the wall socket and replace the fuse with a 3 Amp ASTA approved to BS 1362 fuse.
2. Never use the plug without the fuse cover fitted. Replacement fuse covers are available from your dealer or most electrical retail outlets.
3. If the mains plug is cut off the cable, rewire the replacement plug in accordance with instruction given in this manual.
4. CAUTION: Under no circumstances should the discarded plug be inserted mains socket. To prevent a shock hazard carefully dispose of the discarded plug. Do not leave the plug lying around where children might see it.

WARNING: To prevent fire or shock hazard do not expose this unit to rain or moisture.

CAUTION: DANGEROUS VOLTAGES EXIST INSIDE THIS UNIT, DO NOT REMOVE COVER (OR BACK). NO USER SERVICEABLE PARTS INSIDE. REFER SERVICING TO QUALIFIED SERVICE PERSONNEL. DISCONNECT FROM MAINS SUPPLY WHEN NOT IN USE.

PLUG WIRING DETAILS

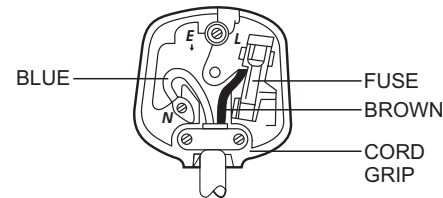

The wires in this mains lead are coloured in accordance with the following wiring codes:

Blue..... Neutral
Brown..... Live

The wires in this mains lead must be connected to the terminals in the plugs as follows:

Blue Wire..... N or Black
Brown Wire..... L or Red

Only a 3 Amp fuse should be fitted in the plug or a 5 Amp fuse at the distribution board.

WARNING: UNDER NO CIRCUMSTANCES MUST THE LIVE OR NEUTRAL WIRES BE CONNECTED TO THE EARTH TERMINAL IN A 3-PIN MAINS PLUG.



This symbol means that this unit is double insulated. An earth connection is not required.

HELPLINE PHONE NUMBER 0870 873 0080

For improvement purposes, specification and design are subject to change without notice.

Goodmans Product Information Helpline 0870 873 0080

CAUTION
CLASS 1 LASER PRODUCT

Use of Controls or adjustments or performance of procedures other than those specified herein may result in hazardous radiation exposure.

LASER SAFETY

This unit employs a laser, only qualified service personnel should attempt repair.



DANGER: INVISIBLE LASER RADIATION WHEN OPEN AND INTERLOCK FAILED OR DEFEATED. AVOID DIRECT EXPOSURE TO BEAM.

CAUTION: HAZARDOUS LASER RADIATION WHEN OPEN AND INTERLOCK DEFEATED.

CAUTION

CLEANING: Always disconnect unit from mains supply before attempting to clean it. Use soft cloth moistened with soapy water, wipe gently. Do not use solvents or abrasive materials.

SOME DO'S AND DONT'S ON THE SAFE USE OF EQUIPMENT

This equipment has been designed and manufactured to meet European safety standards but like any electrical equipment, care must be taken if you are to obtain the best results and safety is to be assured.

Do read the operating instructions before you attempt to use the equipment.

Do ensure that all electrical connections (Including the mains plug, extension leads and interconnections between pieces of equipment) are properly made in accordance with the manufacturer's instructions. Switch off and withdraw the mains plug when making or changing connections.

Do consult your dealer if you are ever in doubt of the installation, operating, or safety of your equipment.

Don't continue to operate the equipment if you are in any doubt about it working normally, or if it is damaged in any way- switch off, withdraw the mains plug and consult your dealer.

Don't remove any fixed covers as this may expose dangerous voltages.

Don't leave equipment switched on when it is unattended unless it is specifically stated that it is designed for unattended operation or has a standby mode. Switch off using the switch on the equipment and made sure that your family knows how to do this. Special arrangements may need to be made for infirm or handicapped people.

Don't listen to headphones at high volume, as such use can permanently damage your hearing.

Don't obstruct the ventilation of the equipment, for example with curtains or soft furnishings. Overheating will cause damage and shorten the life of the equipment.

Don't allow electrical equipment to be exposed to rain or moisture.

Above all

- Never let anyone, especially children, push anything into holes, slots or any other opening as this could result in a fatal electric shock.
- Never guess or take chances with electrical equipment of any kind.
- It is better to be safe than sorry!

WARNING: TO REDUCE THE RISK OF FIRE OR ELECTRIC SHOCK, DO NOT EXPOSE THIS APPLIANCE TO RAIN OR MOISTURE, DANGEROUS HIGH VOLTAGES ARE PRESENT INSIDE THE ENCLOSURE, DO NOT OPEN THE CABINET, REFER SERVICING TO QUALIFIED PERSONNEL ONLY.

HELPLINE PHONE NUMBER 0870 873 0080

IMPORTANT NOTES

Your hearing is very important to you and to us so please take care when operating this equipment. The following guidelines are provided for your information.

ESTABLISH A SAFE SOUND LEVEL

- Over time your hearing will adapt to continuous loud sounds and will give the impression that the volume has in fact been reduced. What seems normal to you may in fact be harmful. To guard against this **BEFORE YOUR HEARING ADAPTS** set the volume at a low level.
- Slowly increase the level until you can hear comfortably and clearly and without distortion.
- Damage to your hearing is accumulative and is irreversible.
- Any ringing or discomfort in the ears indicates that the volume is too loud.
- Remember listening for prolonged period of time at high volume levels will harm your hearing.

Once you have established a comfortable listening level, DO NOT INCREASE THE SOUND LEVEL FURTHER.

The following list of typical sound levels may assist you in recognizing just how loud you have set the volume level.

DECIBEL

<u>Level dB</u>	<u>Example</u>
30dB	Quiet library, soft whisper.
40	Living room, fridge freezer bedroom away from traffic.
50	Normal conversation, quiet office, light traffic.
60	Electric sewing machine.
70	Vacuum cleaner, hair dryer, noisy restaurant.

THE FOLLOWING NOISE CAN BE HARMFUL UNDER CONSTANT EXPOSURE

80dB	Average city traffic, alarm clock buzzer at 1 Metre, food mixer.
90	Motorcycle, heavy goods vehicle, petrol lawn mower.
100	Pneumatic drill, chain saw, garbage truck, discotec/night-club.
120	Rock band concert, thunderclap, fast train passing by.
140	THRESHOLD OF PAIN Gunshot, jet plane taking off.
180	Rocket Launching pad.

TABLE OF CONTENTS

Power Sources	1
Player Maintenance.....	2
Disc Cleaning , Power failure.....	3

Player Operation

Location of Controls.....	4
Radio operation.....	5
Listening to a compact disc.....	6
Program play operation.....	7
Repeat play operation.....	8
To set Clock/Alarm time.....	9
Wake up to Radio, CD, Alarm.....	10
Snooze function.....	11
Product Specifications.....	12

WARNING

To prevent fire or shock hazard, do not expose the unit to rain or moisture.

To avoid electrical shock, do not open the cabinet. Refer servicing to qualified personnel only.

SAFETY PRECAUTIONS

1. As the laser beam used in this compact disc player is harmful to the eyes, do not attempt to disassemble the casing.
2. Stop operation immediately if any liquid or solid object should fall into the cabinet. Unplug the unit and have it checked by qualified personnel.
3. Do not touch the lens or poke at it. If you do, you may damage the lens and the player may not operate properly.
4. Do not put anything in the safety slot. If you do, the laser diode will be ON when the lid is still opened.
5. This unit employs a laser. The use of controls or adjustments or performance of procedures other than those specified herein may result in exposure to hazardous radiation.

1. POWER SOURCES

Power Connection

1. Plug the AC 230V Power Cord into an AC household outlet.
2. If you want battery back up, connect one 9 Volt battery (not included) to the battery terminals of the Battery compartment.
3. This battery will maintain time and memory function during a power cut, but not display it.
4. Normal display and function will resume when power is restored, replace the battery periodically.

Note This is an optional feature, no battery is required for normal operation.

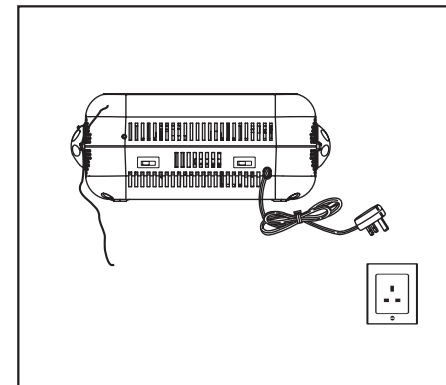

2. PLAYER MAINTENANCE

Cleaning the Cabinet

Before cleaning ensure the unit is unplugged from the mains. Wipe with a soft cloth. If the cabinet is very dirty, dampen the cloth with a weak solution of neutral detergent and water, and then wipe clean.

Cleaning the lens

A dirty lens will cause sound skipping and, if the lens is very dirty, the CD may not work. Open the disc cover and clean the lens as follows:

Dust or Dry Particles

Using a camera lens brush/blower, blow on the lens couple times, then wipe it lightly with the brush to remove dust. Then, blow on the lens once more.

Finger prints

If the lens cannot be cleaned by using a brush/blower, use a dry cotton swab starting in the middle and working to the outside edge.

3. DISC CLEANING, POWER FAILURE

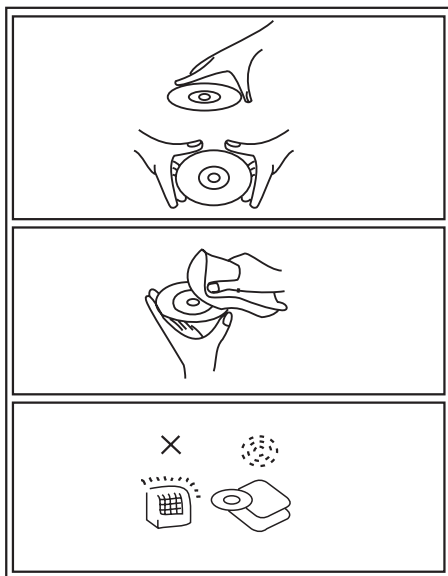

Power failure

When AC power is interrupted, time and alarm settings will be lost (unless 9 volt battery (not supplied) was installed) after power is restored. The digital display will flash to show your power was interrupted. You must reset time and alarm.

Battery back up

To keep alarm time and time of day settings in memory during a brief power failure or if the power cord is accidentally unplugged, install a 9V battery (not supplied) into the Battery Compartment at rear of unit.

Cleaning the Disc

1. To handle a disc use only one of the two manners illustrated.

Note Do not touch the rainbow - colored side.

2. To wipe a disc, use only a soft cloth. Do not use benzene or thinner which will damage the disc. The disc should always be wiped in a straight line from the center to the edge. It should never be wiped in a circular motion.

3. Never place the disc on other equipment or near any heat source. Avoid positions where the disc would be subjected to direct sunlight for long periods.

Maintenance and care

1. Electronic products should never be subjected to extreme temperatures nor high humidity to ensure good performance and a long life-time. The clock radio should not be placed in bathing areas, or around stoves and radiators, etc. Always leave sufficient space around the unit for ventilation.
2. If necessary, only clean the cabinet of the unit with a soft dampened piece of cloth (be sure the AC power cord is unplugged from the outlet). Never use a polish or a strong detergent for cleaning since this can damage the finish of the cabinet.

4. LOCATION OF CONTROLS

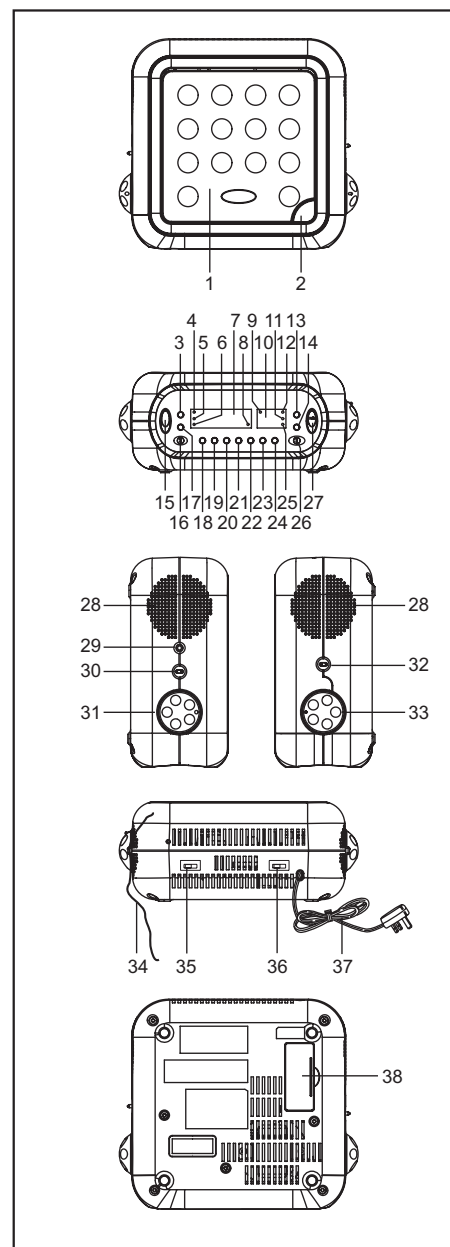

1. CD DOOR
2. CD DOOR OPEN BUTTON
3. ALARM/SLEEP OFF BUTTON
4. PM INDICATOR
5. ALARM 1 INDICATOR
6. ALARM 2 INDICATOR
7. CLOCK DISPLAY
8. SLEEP INDICATOR
9. FM STEREO INDICATOR
10. CD TRACK DISPLAY
11. PROGRAM INDICATOR
12. PLAY/PAUSE INDICATOR
13. CD SKIP/SEARCH UP BUTTON
14. CD SKIP/SEARCH DOWN BUTTON
15. SNOOZE BUTTON
16. ALARM SELECT SWITCH
17. SLEEP BUTTON
18. TIME BUTTON
19. ALARM BUTTON
20. REVERSE BUTTON
21. FORWARD BUTTON
22. CD REPEAT BUTTON
23. CD PROGRAM BUTTON
24. CD STOP BUTTON
25. CD REPEAT INDICATOR
26. FUNCTION SWITCH (BUZZER/AUTO/OFF/ON)
27. CD PLAY/PAUSE BUTTON
28. SPEAKERS
29. PHONES SOCKET
30. CD/RADIO SWITCH
31. VOLUME CONTROL
32. BAND SWITCH
33. TUNING CONTROL
34. FM AERIAL
35. DIMMER SWITCH
36. ALARM LOUDNESS SWITCH
37. AC POWER CORD
38. BATTERY COMPARTMENT (FOR 9V BACKUP BATTERY)

5. RADIO OPERATION

RADIO OPERATION

- Slide the CD/RADIO switch to the RADIO position.
- Slide the Band switch to the required band (among MW/FM/FM ST).
- Rotate the Tuning control to the desired station.
- Adjust the Volume control to a comfortable listening sound level.
- For MW band, better reception can be obtained by rotating the set. For FM band, the FM Aerial Wire (thin black wire) must be stretched to its full length.

NOTE: When receiving FM Stereo program, the FM Stereo indicator will be lit.

NOTE: If a particular FM (STEREO) station is weak, or there is too much background noise, try moving the position of the band selector switch to the FM (MONO) position. This can often result in a much clearer reception.
- The radio can be switched off by setting FUNCTION switch to OFF position.

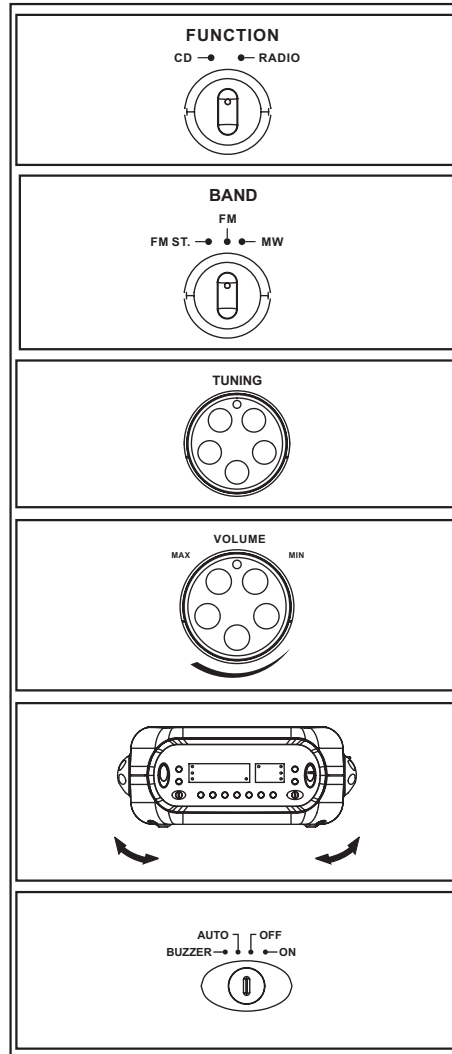

6. LISTENING TO A COMPACT DISC

- Set the CD/RADIO switch to CD position.
- Press the Open button to open the CD Door, place a CD with the printed side up into the CD compartment
- Press the corner of the CD door to close the lid, the disc will rotate and the LED Display will show the disc's total number of tracks.
- Press the CD Play/Pause Button:
 - Press once playback will start from the first track.
 - Press this button in play mode and playback will be paused. To resume playback from the same point, press the button again.
- Press the CD Skip/Search buttons during playback to skip to the desired track. Press the CD Skip/Search up button to skip to the next track on the disc. Press the CD Skip/Search Down button to skip to the beginning of the track currently playing.
 - Press and hold the CD Skip/Search buttons during playback to search the disc at high speed. When the desired section of the disc is found, release the button, normal playback will resume.
- Press CD Stop button to stop CD playback.

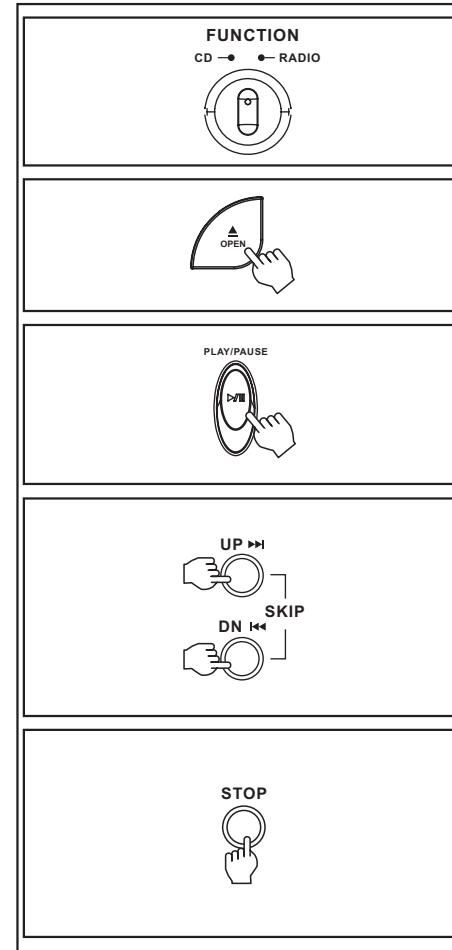

7. PROGRAMME PLAY OPERATION

Programme play

Up to 20 tracks can be programmed for playback in any order or the same track (song) can be repeated up to 20 times.

NOTE: Programming can only be done during stop mode.

1. Press the PROGRAM button in stop mode.
2. The display will show " 0 " flashing and the PROGRAM indicator will flash.
3. Press the SKIP/SEARCH buttons until the desired track shows in the display. The PROGRAM indicator keeps flashing.
4. Press the PROGRAM button. The first track is now stored into memory, and " 0 " flashes in the display again waiting for your next selection.
5. Repeat steps 3 and 4 until all the desired tracks are programmed.
6. When you have finished programming, press the PLAY/PAUSE button.
7. The display will show the track number being played, and the PROGRAM indicator will keep flashing during program play.
8. All songs will be played in the order you programmed.
9. To hear the next song while playing, press the SKIP/SEARCH buttons.
10. When all the songs have finished, the set will stop. The PROGRAM indicator will turn off. To play the programmed tracks again, press the PROGRAM button, then press the PLAY/PAUSE button.
11. To erase the programme, press the PROGRAM button and then press STOP button.

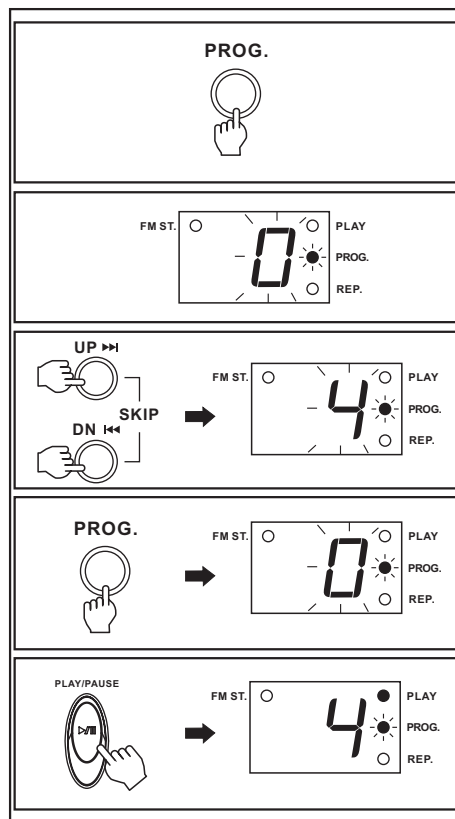

8. REPEAT PLAY OPERATION

Single track repeat

To repeat the SAME track over and over again, do the following.

1. Press the Skip/Search Button during playback to select the track to repeat.
2. Press the Repeat Button. The Repeat Indicator will flash.
3. The selected track will play over and over, until the Stop Button is pressed.
4. To cancel the repeat function, press Repeat Button twice.

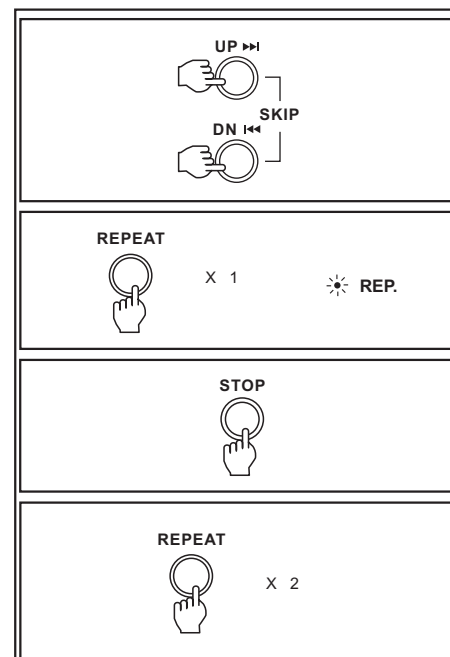

All tracks repeat

To repeat ALL TRACKS on a disc, do the following.

1. Press Repeat Button twice during playback. The Repeat Indicator will remain on.
2. All the tracks on the CD will play in order and then start all over again. To cancel the repeat function, press Repeat Button once.

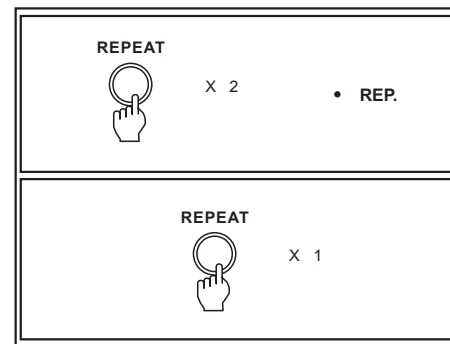

9. TO SET CLOCK/ALARM TIME

To set clock time 24 hours

1. Press and hold Time button.
2. While holding down Time button, press FORWARD and REVERSE buttons until correct time is displayed.
3. Release these buttons when the correct time is reached.

Note When setting the time, be careful not to touch Snooze or Sleep button. Touching either button will change the display time. Please note this unit requires the time to be set in a 24 hour format i.e. 4:00pm = 16:00

To set alarm time

This set has dual alarms, these may be set Alarm 1, to wake up at a certain time or Alarm 2 to wake up at a different time or Alarm 1+2 to wake up at both alarm times set.

To set Alarm 1, slide the Alarm selector to position 1.

To set Alarm 2, slide the Alarm selector to position 2.

Note: To check alarm time, press Alarm Set button. The display will show alarm time.

To wake at Alarm 1 time, slide Alarm selector to position 1; To wake at Alarm 2 time, slide Alarm selector to position 2; To wake at both times, slide to Alarm 1+2.

Note: When setting time, be careful not to touch Snooze and/or Sleep button. Touching these buttons will change the time.

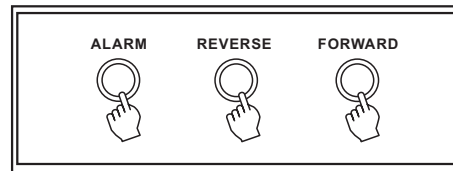
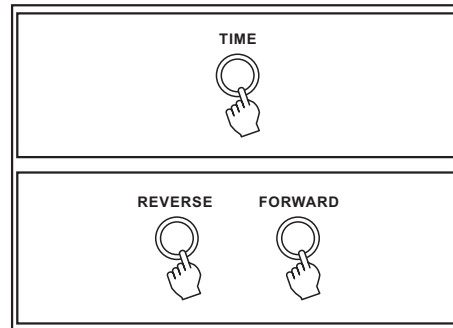

10. WAKE UP TO RADIO, CD, ALARM

Wake to radio

1. Turn radio on (slide Band switch to MW or FM or FM ST. position) and adjust the Tuning and Volume control.
2. Set the alarm time or check if the pre-set alarm time is correct by pressing the Alarm set button.
3. Slide the FUNCTION switch to AUTO.
 - The radio will start playing automatically at the set alarm time.

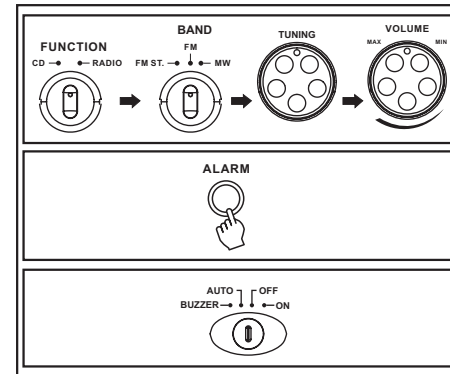

Wake to CD music

- 1 Open CD Door by pressing CD Open button and place a CD into the CD compartment.
- 2 Slide the CD/RADIO switch to CD.
- 3 Set the alarm time or check if the pre-set alarm time is correct by pressing the Alarm set button.
- 4 Slide the FUNCTION switch to AUTO.
 - The CD will then start playing from the first track at the pre-set alarm time.

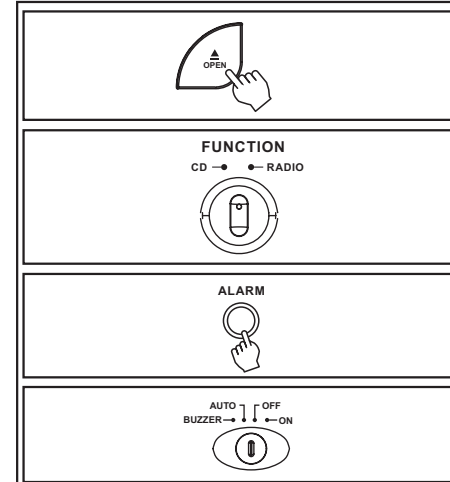

Wake to alarm

1. Set the alarm time or check if the pre-set alarm time is correct by pressing the Alarm set button.
2. Slide the FUNCTION switch to BUZZER position.
3. Buzzer will sound at the pre-set alarm time.
4. Select High/Mid/Low ALARM Volume position.
5. Slide the FUNCTION switch to OFF to silence the alarm.

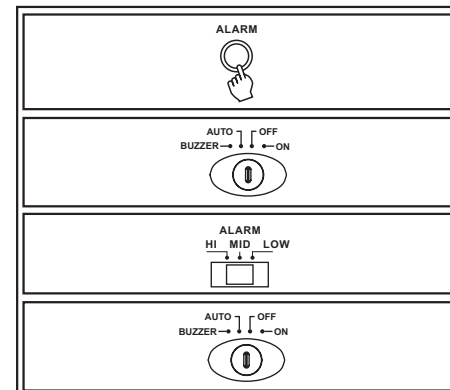

11. SNOOZE FUNCTION

Snooze

To sleep an extra 7 minutes when the Radio/Buzzer/CD comes on, lightly touch the Snooze button, the radio or alarm or CD will stop for 7 minutes and come on again.

The display for clock shows the minutes and seconds of the real-time clock. Let's say, the time is 12:36; press SNOOZE button; the display shows 6:00, with "6" as the minutes and "00" as the seconds of the clock. When a period of seven minutes passes, the display says "3:00" (the time now is 12:43); Radio/Buzzer/CD will sound again.

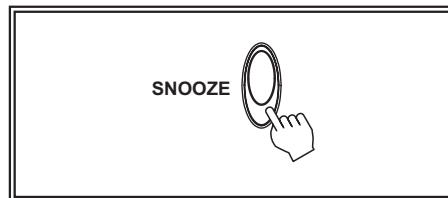

Going to sleep with music, CD OR RADIO

Pressing the SLEEP button will play Radio/CD music for the amount of time Specified and then turn off automatically.

1. Press and hold the sleep button. The display will show 59 minutes.
2. While holding the sleep button, press the FORWARD or REVERSE button to increase or decrease the time to the required amount.
3. The RADIO/CD will play for the time set and shut itself off automatically.

Note: To avoid influence on alarm pre-set time, make sure FUNCTION switch is set to AUTO or BUZZER for the alarm to activate correctly.

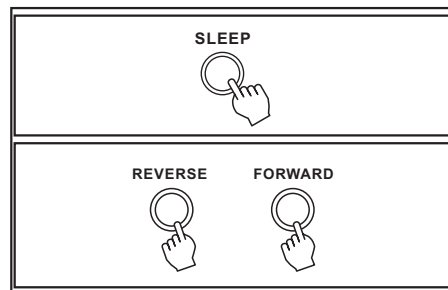

12. PRODUCT SPECIFICATIONS

PICK-UP

System	Compact disc digital audio system
Laser diode	material: GaAIAs
Properties	Wavelength: 780nm Emission duration: continuous Laser output level 44.6uW
Error correction	Cross-interleave Reed-solomon code

AUDIO

D/A conversion	1-bit DAC 8 times oversampling
Frequency response	20-20,000Hz (+1/-3 dB)
Wow and flutter	Below measurable limits
No. of channels	2 channels (stereo)
Earphone output level	20mW * 2
Speakers	3W/8 Ohms * 2

RADIO

Receiving bands	MW/FM
Frequency range	MW 540 - 1600 KHz FM 88 - 108 MHz

GENERAL

Power requirements	AC 230V/50Hz
Power consumption	13W
Dimension	Approx. 212(L)X186.6(W)X86.8(H) mm
Weight	Approx. 1.390kg(Without batteries)